



# American Opto Plus LED

## C/A364X

### Clock Display

#### MAIN FEATURES:

- ◆ 0.36 INCH (9.15mm) DIGIT HEIGHT
- ◆ LOW POWER CONSUMPTION
- ◆ EXCELLENT CHARACTER APPEARANCE
- ◆ CASE MOLD TYPE

#### PACKAGE DIMENSIONS

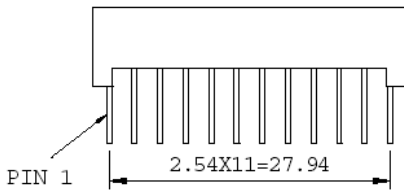
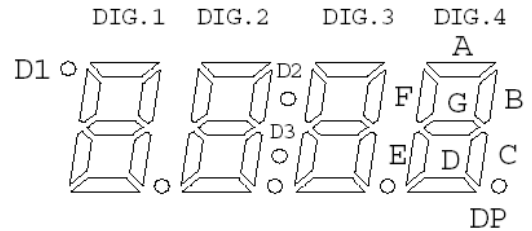
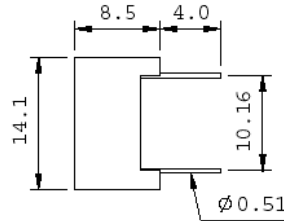
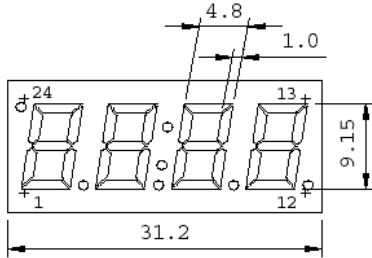

UNIT; Gmm  
TOLERANCE;  $\pm 0.2$ mm

#### PIN LAYOUT:

COMMON ANODE:

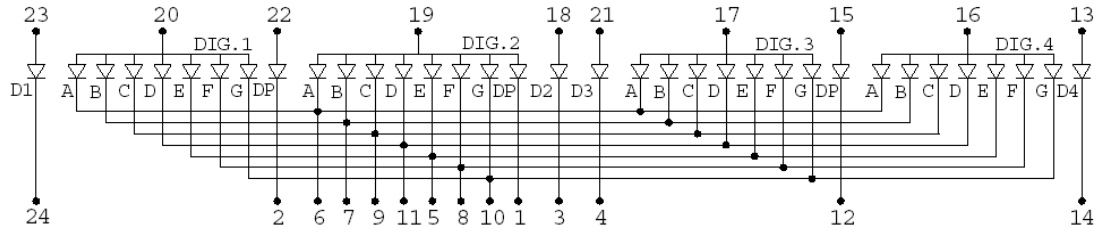

COMMON CATHODE:

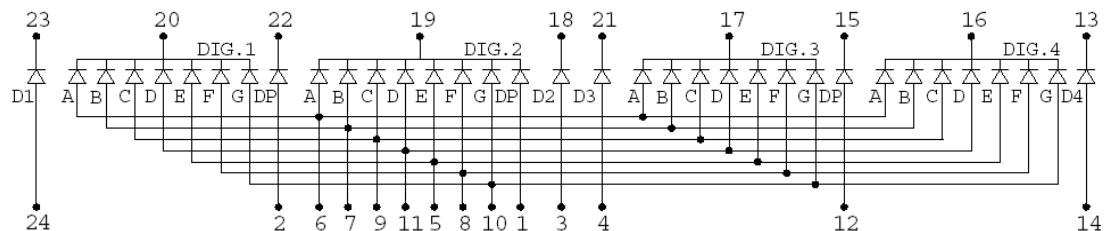

◆SELECTION GUIDE AND APPLICATION INFORMATION ( RATINGS AT 25°C AMBIENT )

Part No.	Chip		Wave	Electro-Optical Characteristics			
	Raw Material	Emitted Color	Length $\lambda_p$ (nm)	I <sub>af</sub> MA(dp)	I <sub>pf</sub> (Peak)	V <sub>f</sub> (V) Typ	I <sub>v</sub> (mcd) Typ.
C/A364H	GaP	Red	695	20	100	2.2	0.6
C/A364E	GaAsP/GaP	Orange Red	635	20	100	2.0	4.0
C/A364G	GaP	Green	570	20	100	2.2	4.5
C/A364Y	GaP	Yellow	600	20	100	2.2	4.0
C/A364SR	AlGaAs	Super Red	650	20	100	1.8	8.0
C/A364LB	Sic	Blue	430	20	100	3.6	2.0
C/A364LW	ZnSe	White	485+	20	100	3.0	2.0

◆ABSOLUTE MAXIMUM RATING: (T<sub>a</sub>=25°C)

Reverse Voltage	: 5 Volt
Reverse Current (V <sub>r</sub> =5V)	: 100 $\mu$ A
Operating Temperature Range	: -40°C ~ +100°C
Storage Temperature Range	: -40°C ~ +100°C
Soldering Temperature	: 240 ~ 250 for 5 seconds.
Preheating Temperature	: 100 ~ 150 for 2 minutes.

Parameter Description	Symbol	Unit
Spectral Line half-width	$\lambda$	nm
Power dissipation	P <sub>d</sub>	mW
Peak Forward Current (Duty 1/10, @KHz)	I <sub>f</sub> (Peak)	mA
Recommended Operation Current	I <sub>f</sub> (Rec)	mA
Average Luminous intensity (I <sub>f</sub> =10mA)	I <sub>v</sub>	$\mu$ cd