

SD

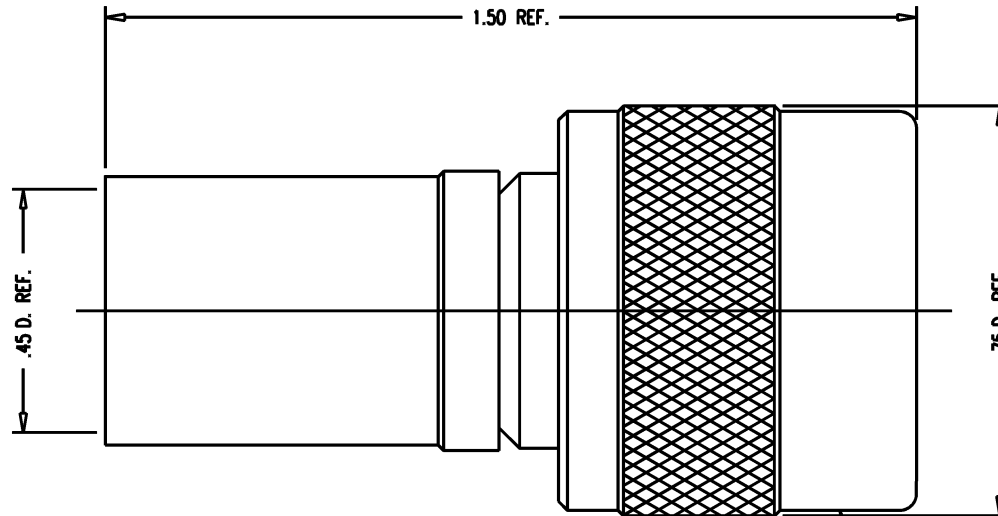

STAMP: KINGS KD-59-180 M06
YRWK (DATE CODE)

NOTES:

1. FOR USE WITH RG-393/U CABLE.
2. FOR CABLING INSTRUCTIONS SEE CP-5402.
3. FOR CRIMPING USE DIE KTH-2105.
4. INTERFACE PER MIL-STD-348, FIG. 302-1.
5. CONTACT TO BE SUPPLIED UNASSEMBLED.
6. MARK PACKAGE: KINGS KD-59-180 M06
YRWK (DATE CODE)
7. MATERIALS:
 INSULATOR: TEFLON, ASTM-D-4894
 GASKET: SIL. RUB., ZZ-R-765
 K-GRIP SLEEVE: COM. BRONZE ASTM-B-140
 OUTER CONTACT } BER. COP., ASTM-B-196
 SPRING WASHERS }
 ALL OTHER PARTS: BRASS, ASTM-B16
8. FINISHES:
 CENTER CONTACT: GOLD PLATE PER MIL-G-45204
 OUTER CONTACT & SPRING WASHER: SILVER PLATE PER QQ-S-365
 ALL OTHER METAL PARTS: KINGS TARNISH RESISTANT NICKEL FINISH (TR-5)
9. ELECTRICAL CHARACTERISTICS:
 NOMINAL IMPEDANCE: 50Ω
 FREQUENCY RANGE: DC TO 11 GHz
 VOLTAGE RATING: 1000 VOLTS RMS

SD

KD-59-180 M06

REVISIONS	
ISSUE	CHANGES
4	CN 36332 C REDRAWN ME 05/25/95
5	CN 37536 C MRM 01/21/98
6	CN 38005 A TML 05/15/00
KD59180C	
SCALE 4:1	
APPROX SURFACE AREA	
USED ON	
REF:	
PLUG, C	
DRAWN ME	DATE 05/24/95
DESIGN MJB	DATE 05/26/95
APPR.	DATE
KINGS ELECTRONICS CO., INC. ROCK HILL, SOUTH CAROLINA 29730	
KD-59-180 M06	