



FME Series

MFM01

RG58/U RG59/U RG174/U

FME FEMALE CRIMP

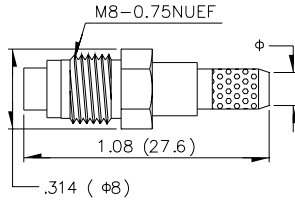

MFM05

FME MALE TO BNC MALE

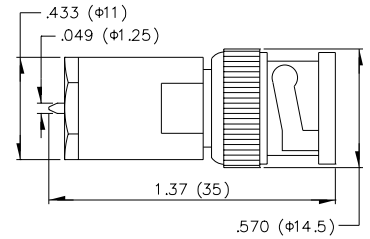

MFM01M

RG58/U RG59/U RG174/U

FME FEMALE CRIMP

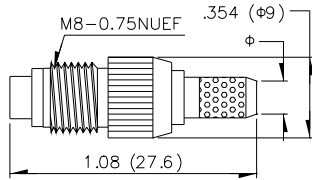

MFM06

FME RIGHT ANGLE MALE TO BNC MALE

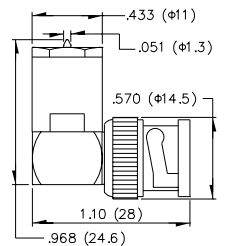

MFM02

FME DOUBLE MALE

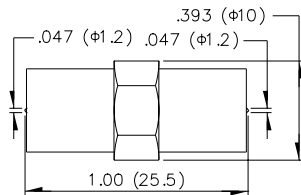

MFM07

FME MALE TO TNC MALE

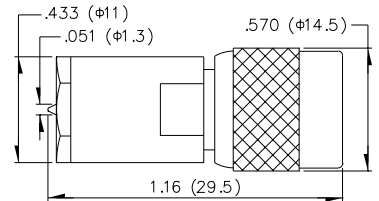

MFM03

FME MALE TO N MALE

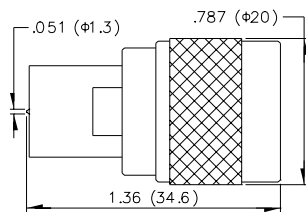

MFM08

FME RIGHT ANGLE MALE TO TNC MALE

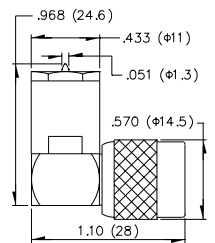

MFM04

FME MALE TO MINI UHF MALE

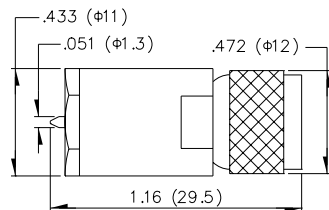

MFM09

FME MALE TO UHF MALE

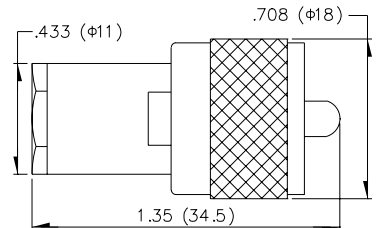

North and South America:

Methode Electronics, Inc. Connector Products

1700 Hicks Road • Rolling Meadows, IL 60008 USA

847-392-3500 • Toll Free: 800-323-6864 • Fax: 847-392-9404

Email: info@methode.com • Web: www.methode.com/connector/index.html

Europe:

Methode Electronics Ireland, Ltd.

11 Annacotty Business Park • Limerick, Ireland

353 61 330013 • Fax: 353 61 330803

Email: info@methode.ie • Web: ireland.methode.com/main.html

Far East:

Methode Electronics Far East, Pte. Ltd.

1 Tuas Lane, Jurong Town • Singapore 638610

65-68615444 • Fax: 65-68614777

Email: sales@methode.com.sg • Web: www.methode.com/mefe/index.html



FME Series

MFM10

FME FEMALE TO TNC FEMALE

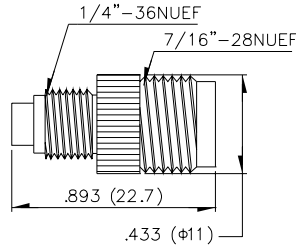

MFM15

RG58/U RG59/U RG174/U

FME MALE CRIMP

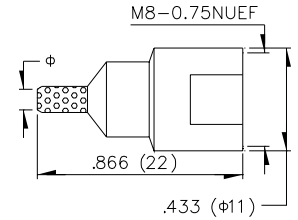

MFM11

FME MALE TO SMA MALE

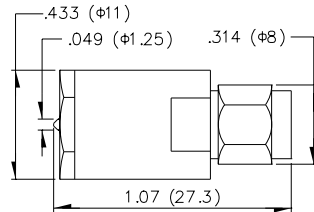

MFM16

FME MALE TO BNC FEMALE

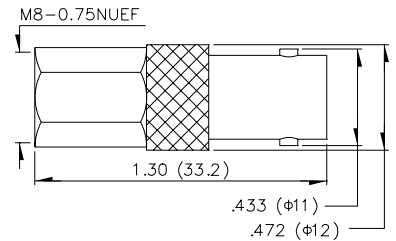

MFM12

FME MALE TO TNC FEMALE

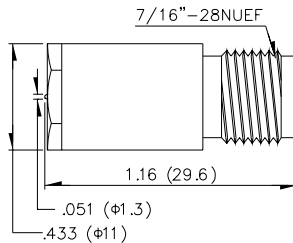

MFM17

FME FEMALE TO MINI UHF MALE

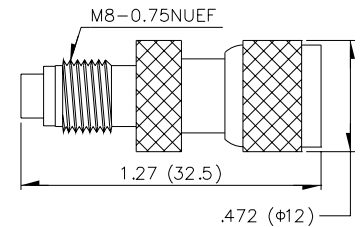

MFM13

RG58/U RG174/U

FME MALE CRIMP

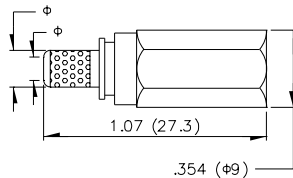

MFM18

FME FEMALE TO BNC FEMALE

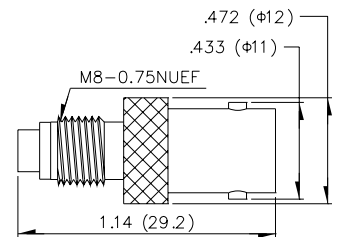

MFM14

FME DOUBLE FEMALE

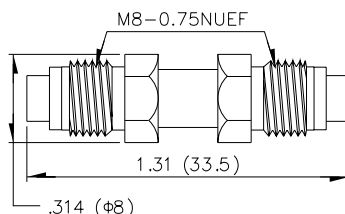

MFM19

FME FEMALE TO BNC MALE

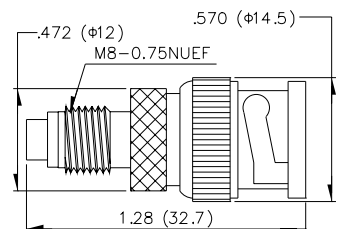

North and South America:

Methode Electronics, Inc. Connector Products

1700 Hicks Road • Rolling Meadows, IL 60008 USA

847-392-3500 • Toll Free: 800-323-6864 • Fax: 847-392-9404

Email: info@methode.com • Web: www.methode.com/connector/index.html

Europe:

Methode Electronics Ireland, Ltd.

11 Annacotty Business Park • Limerick, Ireland

353 61 330013 • Fax: 353 61 330803

Email: info@methode.ie • Web: ireland.methode.com/main.html

Far East:

Methode Electronics Far East, Pte. Ltd.

1 Tuas Lane, Jurong Town • Singapore 638610

65-68615444 • Fax: 65-68614777

Email: sales@methode.com.sg • Web: www.methode.com/mefe/index.html



FME Series

MFM20

FME FEMALE TO TNC MALE

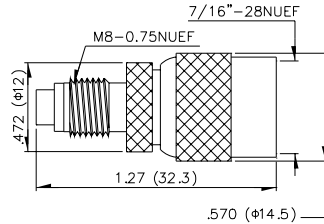

MFM21

FME FEMALE TO MINI UHF FEMALE

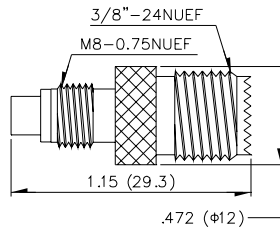

MFM22

FME MALE TO MINI UHF FEMALE

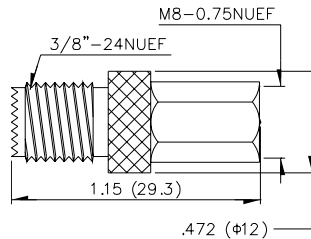

MFM23

FME FEMALE TO SMA MALE

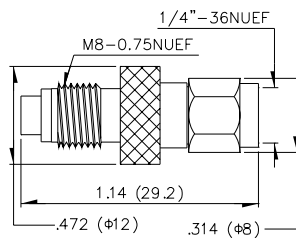

MFM24

FME FEMALE TO SMA FEMALE

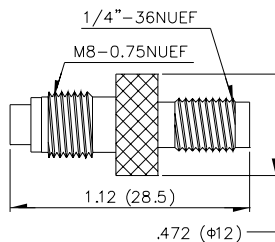

North and South America:

Methode Electronics, Inc. Connector Products

1700 Hicks Road • Rolling Meadows, IL 60008 USA

847-392-3500 • Toll Free: 800-323-6864 • Fax: 847-392-9404

Email: info@methode.com • Web: www.methode.com/connector/index.html

Europe:

Methode Electronics Ireland, Ltd.

11 Annacotty Business Park • Limerick, Ireland

353 61 330013 • Fax: 353 61 330803

Email: info@methode.ie • Web: ireland.methode.com/main.html

Far East:

Methode Electronics Far East, Pte. Ltd.

1 Tuas Lane, Jurong Town • Singapore 638610

65-68615444 • Fax: 65-68614777

Email: sales@methode.com.sg • Web: www.methode.com/mefe/index.html



RF/Microwave/Coax Connectors



F SERIES



TNC SERIES



N SERIES



MINI-UHF SERIES



UHF SERIES



SMA SERIES



RCA SERIES



SMB SERIES



PAL SERIES



MCX SERIES



FME SERIES



MMCX SERIES

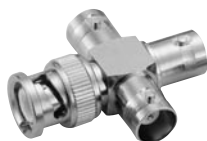

BNC SERIES

PART NUMBER LEGEND

MX(X) - XXX - X - XX - XX

IMPEDANCE

- 50 = 50Ω
- 75 = 75Ω
- 95 = 95Ω

CABLE GROUP / MOUNTING STYLE

- 00 = PCB Mount
- 01 = 55U/58/58A/58C/140U/141/141A/142U/223U/303
- 02 = 58 Teflon/58 Thinet/Belden® 9907
- 03 = 59/59A/59B/62/62AU/62B/62C/210
- 04 = 59 Teflon
- 05 = 174U/188A/316U
- 06 = 179U/187U
- 07 = 8/8A/213/214/11/11A
- 08 = 6/6A/143/212
- 09 = Belden® 8227/89207
- 10 = .141 Semi-Rigid
- 11 = .085/.086 Semi-Rigid
- 12 = Bulkhead Mount
- 13 = Chassis Mount
- 14 = Panel Mount

INSULATOR TYPE

- T = Teflon
- D = Delrin
- PP = Polypropylene

TYPE

001 through 999

SERIES

- B = BNC
- T = TNC
- MU = MINI-UHF
- TN = TWINAX
- SA = SMA
- SB = SMB
- MC = MCX
- MX = MMCX
- F = F
- N = N
- U = UHF
- R = RCA
- MR = MINI-RCA
- FM = FME
- P = PAL TV
- SC = SMC
- 7 = DIN 7/16



North and South America:

Methode Electronics, Inc. Connector Products

1700 Hicks Road • Rolling Meadows, IL 60008 USA
847-392-3500 • Toll Free: 800-323-6864 • Fax: 847-392-9404

Email: info@methode.com • Web: www.methode.com/connector/index.html

Europe:

Methode Electronics Ireland, Ltd.

11 Annacotty Business Park • Limerick, Ireland
353 61 330013 • Fax: 353 61 330803

Email: info@methode.ie • Web: ireland.methode.com/main.html

Far East:

Methode Electronics Far East, Pte. Ltd.

1 Tuas Lane, Jurong Town • Singapore 638610
65-68615444 • Fax: 65-68614777

Email: sales@methode.com.sg • Web: www.methode.com/mefe/index.html