

- NOTES
1. MATERIAL : BRASS , 0.5 mm THICKNESS
 2. FINISH : 35749-0800(UNPLATED)
35749-0810(POST PLATED TIN)
35749-0840(POST PLATED TIN-LEAD)
 3. RECOMMENDED LENGTH OF WIRE STRIP IS 4.4-5.0 mm.

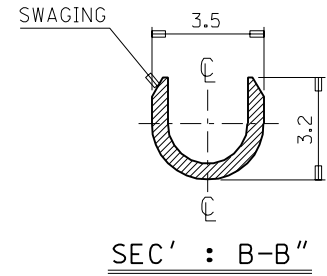
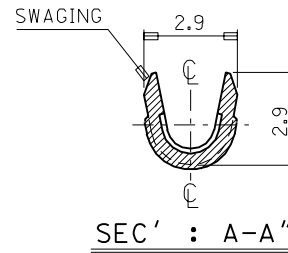
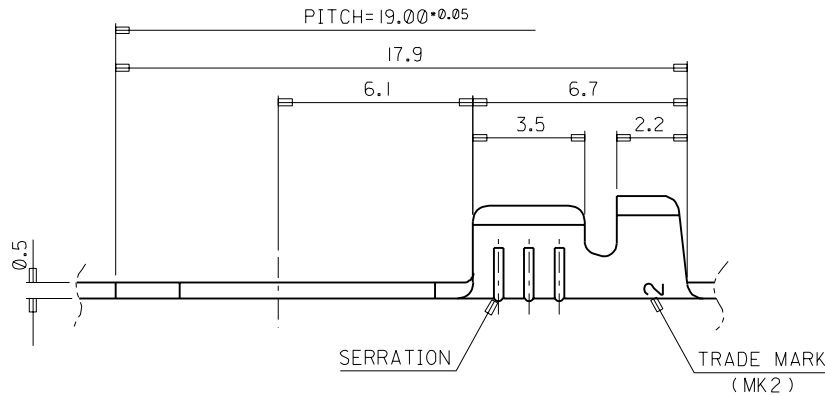

REVISION RECORD		ECN	DR/CHK	DATE	DIE FEED	APPL FEED	WBDW	IBDW	APP'D BY	SCALE	INSULATION RANGE	TITLE:	ENG. NO.	REV B	
B	REVISED	94-003		94.5.4					J.S.KANG	7/1	∅ 2.1 MAX.	SPADE TERMINAL	SD 35749-08*0	1 of 1	
A	CAD REDRAWING	93-020		93.8.26		19.00			B.K.CHOI						
ASS'Y PART		QTY/REEL OR PACK		SURFACE AREA		MATERIAL		SEE NOTES		WIRE RANGE		GENERAL TOLERANCES		MOLEX MOLEX-KOREA CO.,LTD.	
DESCRIPTION		ENG.NO.		MM ²		DIMENSION CLASSIFICATION				#22-#18		DIM. ±0.30			
						LAYOUT NO.				0.3-0.8		ANGLE ±0.20			
DIE NO.						INS. CRIMP WIDTH				MM ² :		REVISE ONLY ON CAD SYSTEM			
WIRE CRIMP WIDTH										RANGE		TITLE: SPADE TERMINAL			
												ENG. NO. SD 35749-08*0			
INS. CRIMP WIDTH												1 of 1			
												REV B			
IBDW												MK-9			