

SMB8100-9L240

SMB Jack Crimp Right Angle 50Ω

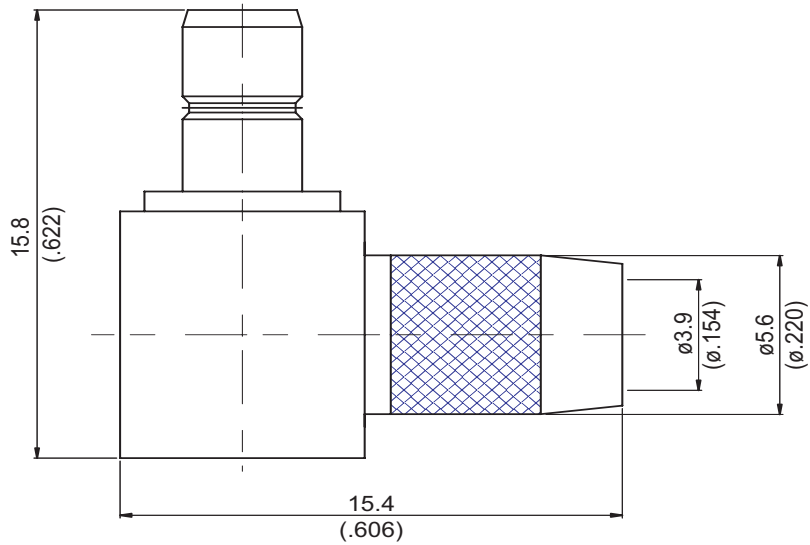

| Parts | Material | Plating(Micro-inch) |
|-------------|----------|---------------------------------------|
| Ferrule | Brass | Gold 5 Over Nickel 50 Over Copper 50 |
| Cover | Brass | Gold 5 Over Nickel 50 Over Copper 50 |
| Body | Brass | Gold 5 Over Nickel 50 Over Copper 50 |
| Contact Pin | Brass | Gold 20 Over Nickel 50 Over Copper 50 |
| Insulator | Teflon | |
| Barrel | Brass | Gold 5 Over Nickel 50 Over Copper 50 |

Weight: 9.48 g

Suitable Cables: JBY240



This part number complies with RoHS.

Notice: JYEBAO reserves the right to make modifications deemed appropriate.

JYE BAO CO., LTD.

CABLE ASSEMBLY INSTRUCTION

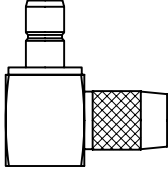
| | | | | |
|---------------|------|------------|-----|---|
| SMB8100-9L240 | DATE | 2016/08/22 | REV | — |
|---------------|------|------------|-----|---|

| | | |
|--|---|---|
| <p>A</p>  <p style="text-align: center;">BODY</p> | <p>B</p>  <p style="text-align: center;">COVER</p> | <p>C</p>  <p style="text-align: center;">FERRULE</p> |
|--|---|---|

| DIAGRAM | ASSEMBLY INSTRUCTION |
|---------|----------------------|
|---------|----------------------|

| | |
|--|--------------------------------|
|  | <p>Step 1: STRIP AS SHOWN.</p> |
|--|--------------------------------|

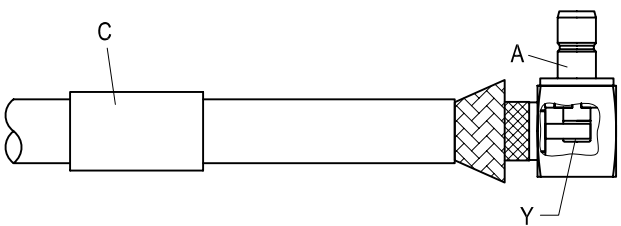
| | |
|---|---|
|  | <p>Step 2: SLIDE FERRULE " C " OVER CABLE. Step 3: WRAP THE BRAIDING UPWARDS. Step 4: SLIDE CENTER CONDUCTOR ON THE CONTACT PIN OF CONNECTOR " A " AND SOLDER IN " Y ".</p> |
|---|---|

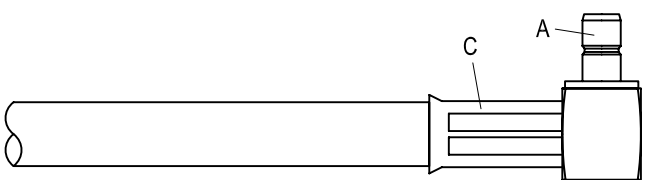
| | |
|---|--|
|  | <p>Step 5: SLIDE FERRULE " C " TOWARDS THE CONNECTOR " A " AND CRIMP. (USE 6.5mm/0.256inch HEX SECTION OF INSERT-E)</p> |
|---|--|

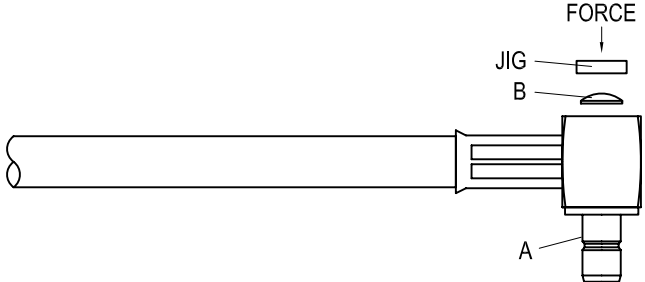
| | |
|---|---|
|  | <p>Step 6: PRESS ON THE TOP OF " B " WITH JIGS.</p> |
|---|---|

This part number complies with RoHS.

Notice: JYEBAO reserves the right to make modifications deemed appropriate.

| | | |
|----------|---------|---------|
| APPROVED | CHECKED | DRAWING |
|----------|---------|---------|

Albert