

Customer Information Sheet

DRAWING No.: S435-XX

SHEET 3 OF 3

IF IN DOUBT - ASK

©

NOT TO SCALE

THIRD ANGLE PROJECTION

ALL DIMENSIONS IN mm

OBSOLETE

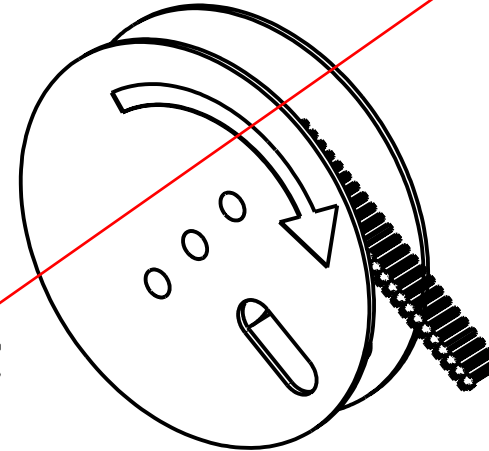
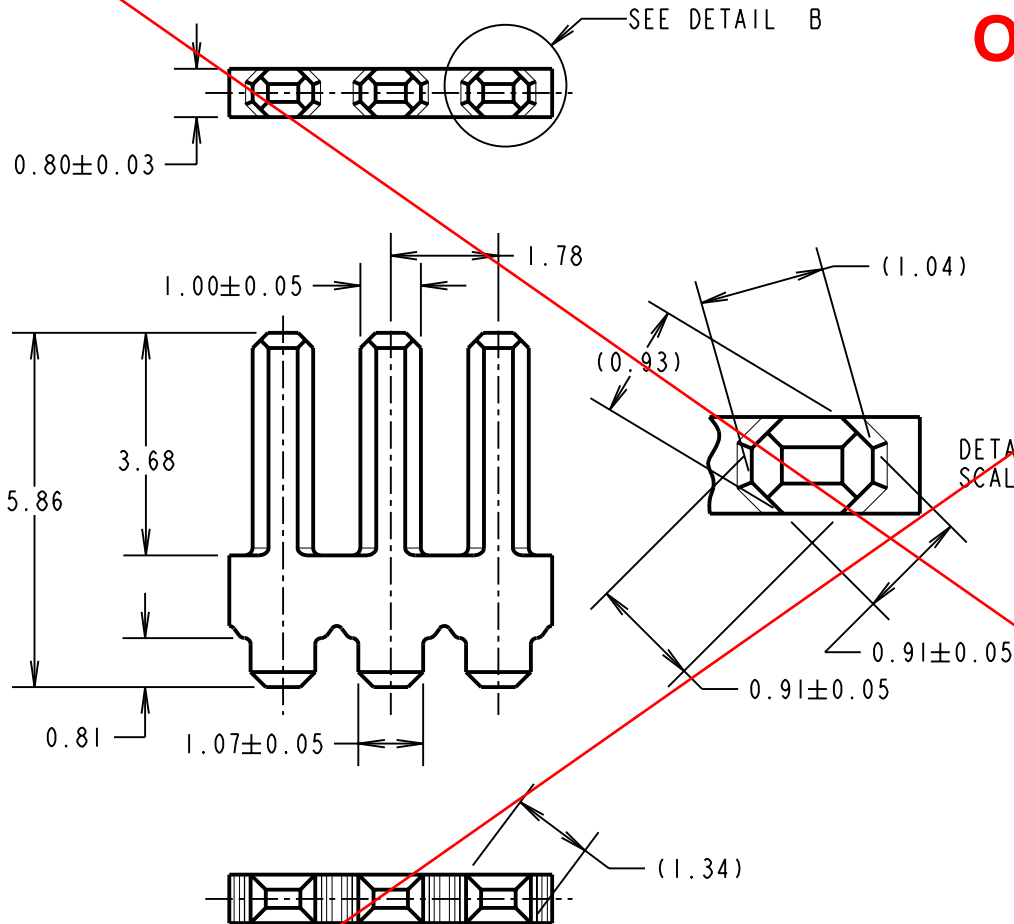

COMPONENTS SHOWN REELED
READY FOR INSERTION

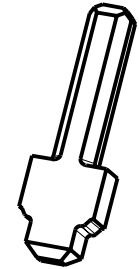

ORDER CODE	S435-XX
FINISH	06 - 4μ 90/10 TIN/LEAD 46 - 4μ 100% TIN

SB	4	22.03.11	10770
NAME	ISS.	DATE	C/NOTE
APPROVED:		S.BENNETT	
CHECKED:		R. ADDE	
DRAWN:		MARK G PLESTED	
CUSTOMER REF.:			
ASSEMBLY DRG:			

NOTES:

1. RECOMMENDED FINISHED MOUNTING HOLE SIZE = $\varnothing 1.22-1.12\text{mm}$.
2. QUANTITY OF PINS PER REEL = 25K.
3. TOTAL WEIGHT PER REEL = 1.07kg.

HARWIN

THIS DRAWING AND ANY INFORMATION OR DESCRIPTIVE MATTER SET OUT HEREON ARE CONFIDENTIAL AND COPYRIGHT PROPERTY OF THE HARWIN GROUP AND MUST NOT BE DISCLOSED, LOANED, COPIED OR USED FOR MANUFACTURING, TENDERING OR FOR ANY OTHER PURPOSE WITHOUT THEIR WRITTEN PERMISSION.

TOLERANCES

X. = ±1mm
X.X = ±0.25mm
X.XX = ±0.10mm
X.XXX = ±0.01mm

ANGLES = ±5°

UNLESS STATED

MATERIAL:

BRASS CW508L HARD
TO BS EN 1652: 1998
(CuZn37 HARD)

FINISH: SEE ORDER CODE

S/AREA:

mm²

TITLE:

1mm OCTAGONAL PIN
3.68mm POST HEIGHT

DRAWING NUMBER:

S435-XX

SHT
3
OF 3

HARWIN USA

TEL: 603 893 5376
FAX: 603 893 5396
mis@harwin.com

HARWIN Europe (UK)

TEL: 023 9231 4545
FAX: 023 9231 4590
mis@harwin.co.uk

HARWIN Asia

TEL: +65 6 779 4909
FAX: +65 6 779 3868
mis@harwin.com.sg