

ITEM	COMPONENT	-HN	-GN
1	SUB ASSEMBLY	SUB-BNC5-P-C-N-ST-CA2	
2	PIN	BNC5-P-C-H-ST-CA2-PIN	BNC5-P-C-G-ST-CA2-PIN
3	INSULATOR	BNC5-INS-002	
4	INNER FERRULE	MCX-FER-011-N	
5	FERRULE	MCX-FER-004-N	

GENDER
-P: PLUG

TYPE
-C: CABLE

TERMINATION
-CA2: CCA-178 CABLE

ORIENTATION
-ST: STRAIGHT

PLATING SPECIFICATION
-HN: HEAVY GOLD / NICKEL
30µ" Au / 50µ" Ni MIN ON PIN
100µ" Ni MIN ON OUTER CONTACT
-GN: GOLD / NICKEL
10µ" Au / 50µ" Ni MIN ON PIN
100µ" Ni MIN ON OUTER CONTACT
(SEE TABLE 1)

DO NOT SCALE FROM THIS PRINT

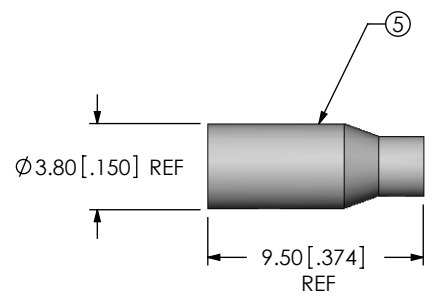
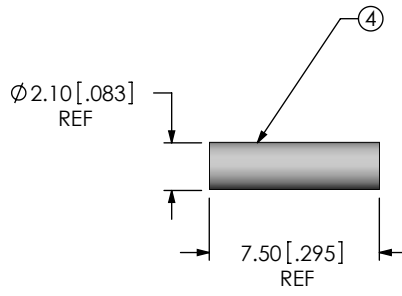
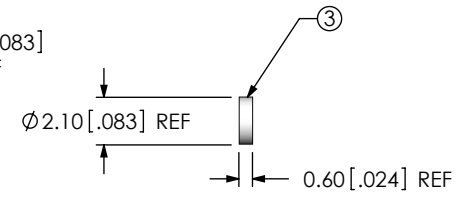
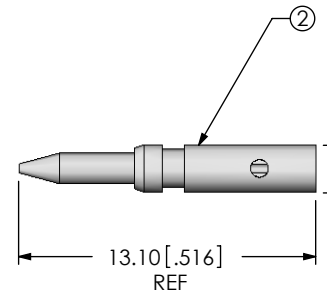
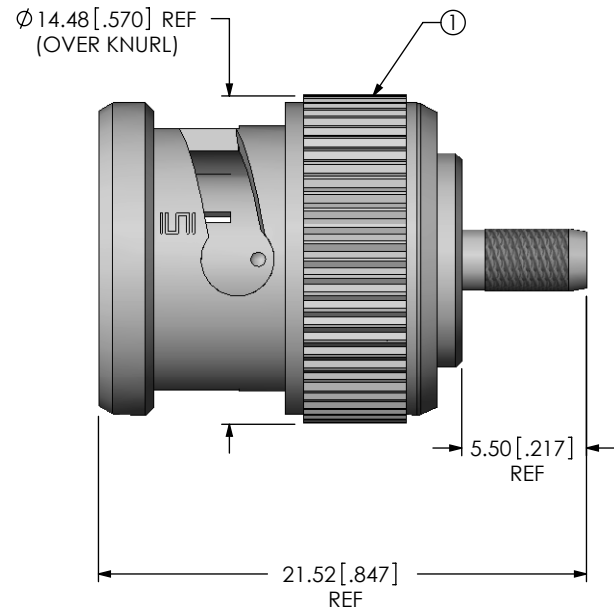

NOTES:
1. Ⓢ REPRESENTS A CRITICAL DIMENSION.
2. PRODUCT TO BE PACKAGED PER PACKING STANDARD CO-HD-WI-3040-M.

<p>UNLESS OTHERWISE SPECIFIED, DIMENSIONS ARE IN MILLIMETERS [INCHES]. TOLERANCES ARE:</p> <p>DECIMALS ANGLES</p> <p>X.X: ±0.3 [.01] 5°</p> <p>X.XX: ±0.13 [.005]</p> <p>X.XXX: ±0.051 [.0020]</p>	<p>PROPRIETARY NOTE</p> <p>THIS DOCUMENT CONTAINS INFORMATION CONFIDENTIAL AND PROPRIETARY TO SAMTEC, INC. AND SHALL NOT BE REPRODUCED OR TRANSFERRED TO OTHER DOCUMENTS OR DISCLOSED TO OTHERS OR USED FOR ANY PURPOSE OTHER THAN THAT WHICH IT WAS OBTAINED WITHOUT THE EXPRESSED WRITTEN CONSENT OF SAMTEC, INC.</p>	 <p>520 PARK EAST BLVD, NEW ALBANY, IN 47150 PHONE: 812-944-6733 FAX: 812-948-5047 e-Mail: info@SAMTEC.com code 55322</p>
<p>MATERIAL: DO NOT SCALE DRAWING SHEET SCALE: 3:1</p> <p>COUPLING NUT, CABLE BODY, PIN, FERRULES: BRASS DIELECTRIC: PTFE GASKET: SILICONE C-RING, FLAT WASHER: FE SPRING WASHER: STAINLESS STEEL</p>		<p>DESCRIPTION: BNC 50 OHM, STR PLUG FOR CCA-178</p> <p>DWG. NO. BNC5-P-C-XX-ST-CA2</p>
<p>BY: ALVIN W 03/18/2011</p>		<p>SHEET 1 OF 2</p>

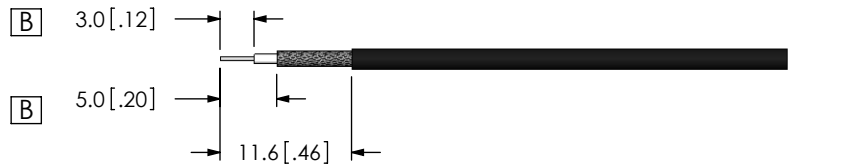

IN PROCESS 1
STRIP AND TIN INNER CONDUCTOR

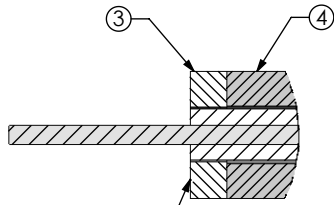

INSULATOR TO BE FLUSH WITH CABLE DIELECTRIC
DETAIL 'A'
SCALE 8 : 1

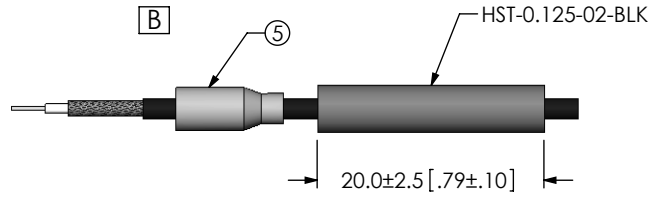

IN PROCESS 2
ADD HEAT SHRINK TUBE & FERRULE

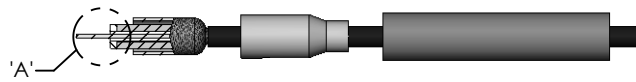

IN PROCESS 3
FLARE SHIELD, ADD INSULATOR & INNER FERRULE

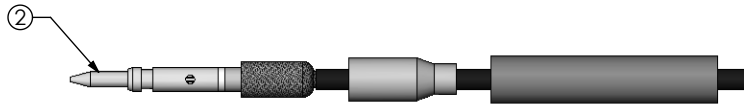

IN PROCESS 4
SOLDER SIGNAL PIN

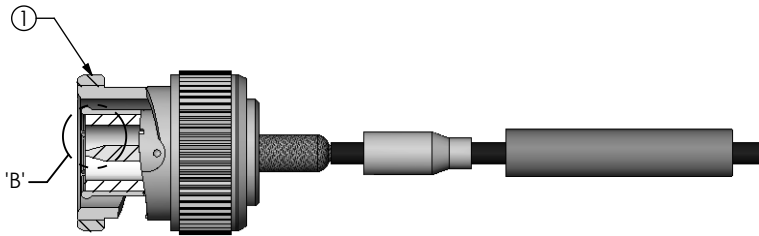

IN PROCESS 5
ADD SUB-BNC5-P-C-X-ST-CA2

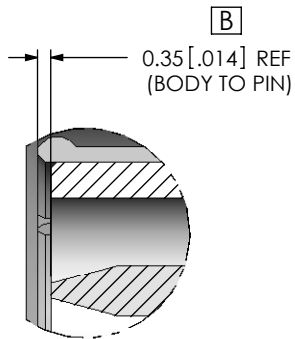

DETAIL 'B'
SCALE 5 : 1

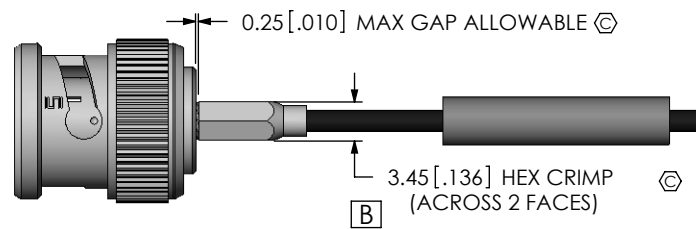

IN-PROCESS 6
CRIMP FERRULE
(USE RF CRIMP HAND TOOL #CAT-HT-126667-21 OR EQUIVALENT)
(USE .128" HEX DIE)

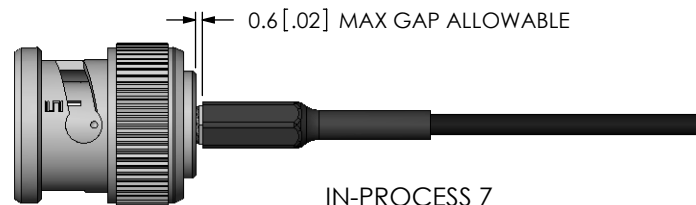

IN-PROCESS 7
APPLY HEAT TO SHRINK TUBING

<p>PROPRIETARY NOTE</p> <p>THIS DOCUMENT CONTAINS INFORMATION CONFIDENTIAL AND PROPRIETARY TO SAMTEC, INC. AND SHALL NOT BE REPRODUCED OR TRANSFERRED TO OTHER DOCUMENTS OR DISCLOSED TO OTHERS OR USED FOR ANY PURPOSE OTHER THAN THAT WHICH IT WAS OBTAINED WITHOUT THE EXPRESSED WRITTEN CONSENT OF SAMTEC, INC.</p> <p>DO NOT SCALE DRAWING</p> <p>SHEET SCALE: 3:2</p>	<p>520 PARK EAST BLVD, NEW ALBANY, IN 47150 PHONE: 812-944-6733 FAX: 812-948-5047 e-Mail info@SAMTEC.com code 55322</p>	
	<p>DESCRIPTION: BNC 50 OHM, STR PLUG FOR CCA-178</p>	
	<p>DWG. NO. BNC5-P-C-XX-ST-CA2</p>	
	<p>BY: ALVIN W</p>	<p>03/18/2011</p>