

SMB3100-9223

SMB Plug Crimp Right Angle 50Ω

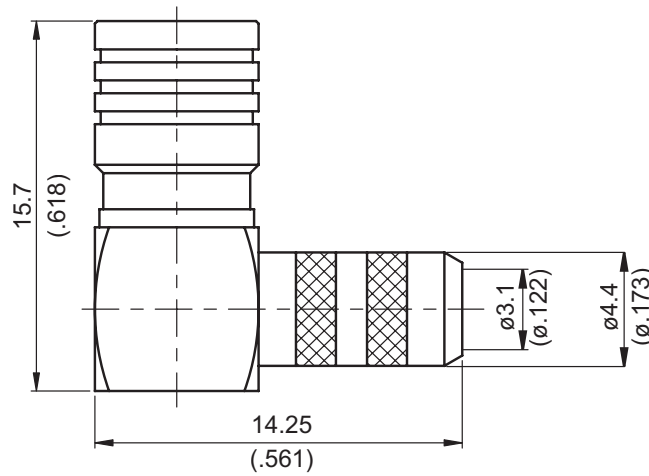

| Parts         | Material         | Plating (Micro-inch)                     |
|---------------|------------------|--|
| Cover         | Brass            | Gold 5 Over Nickel 50 Over Copper 50     |
| Ferrule       | Brass            | Gold 5 Over Nickel 50 Over Copper 50     |
| Retainer Ring | Beryllium Copper | Tin-Zinc-Copper-Alloy 100 Over Copper 50 |
| Contact Pin   | Phosphor Bronze  | Gold 20 Over Nickel 50 Over Copper 50    |
| Insulator     | Teflon           |  |
| Body          | Brass            | Gold 5 Over Nickel 50 Over Copper 50     |
| Barrel        | Brass            | Gold 5 Over Nickel 50 Over Copper 50     |
| Coupling Nut  | Brass            | Gold 5 Over Nickel 50 Over Copper 50     |

Weight:

Suitable Cables: RG223

This part number complies with RoHS.

Notice: JYEBAO reserves the right to make modifications deemed appropriate.

## CABLE ASSEMBLY INSTRUCTION

SMB3100-9223

JYE BAO CO., LTD.

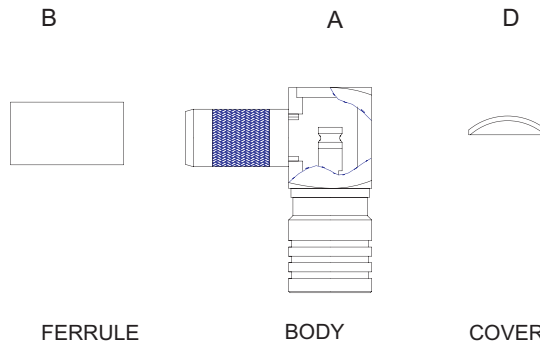

\* TOOLS AND FIXTURES ARE REFERENCE ON PAGE 306 OF JYEBAO'S 2005 CATALOG.

| DIAGRAM | ASSEMBLY INSTRUCTION  |
|---------|---|
|         | <p>Step 1: STRIP AS SHOWN .</p>   |
|         | <p>Step 2: SLIDE FERRULE 'B' OVER CABLE .<br/>                     Step 3: WRAP THE BRAIDING UPWARDS.<br/>                     Step 4: SLIDE CENTER CONDUCTOR ON THE CONTACT PIN OF CONNECTOR 'A' AND SOLDER IN "Y"</p> |
|         | <p>Step 5: SLIDE FERRULE 'B' TOWARDS THE CONNECTOR 'A' AND CRIMP .</p>  |
|         | <p>Step 6: PRESS ON THE TOP OF 'D' WITH JIGS AS SHOWN .</p>   |

This part number complies with RoHS.

Notice: JYEBAO reserves the right to make modifications deemed appropriate.