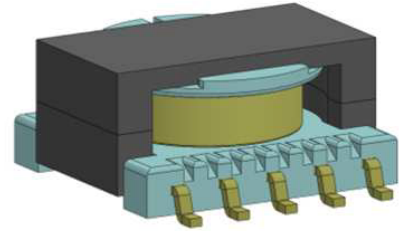

Features

- High voltage isolation
- Small size
- Applicable for AEC-Q200

TR14-A1-S

*In Development

Specifications

Electrical Characteristics

Parameter	Terminals	Specification	Condition
Inductance	(2-4)	7.3 μ H \pm 20%	f=100kHz
	(7-9)	120 μ H Typ.	
Leakage Inductance	(2-4)	0.6 μ H Max.	-
DCR	(2-4)	70m Ω Typ.	
	(7-9)	320m Ω Typ.	
Turns Ratio	Pri : Sec	1 : 4	
Withstand Voltage	Pri : Sec	2.5kV	1 minute
Operating Temperature	-	-40 $^{\circ}$ C to 125 $^{\circ}$ C	-

*These specifications are for reference only

- Any products mentioned in this catalog are subject to any modification in their appearance and others for improvements without prior notification.
- The details listed here are not a guarantee of the individual products at the time of ordering. When using the products, you will be asked to check their specifications.

Dimensions

TR14-A1-S

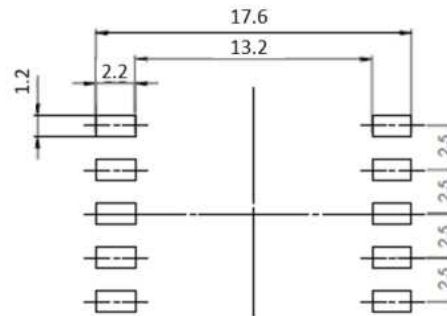
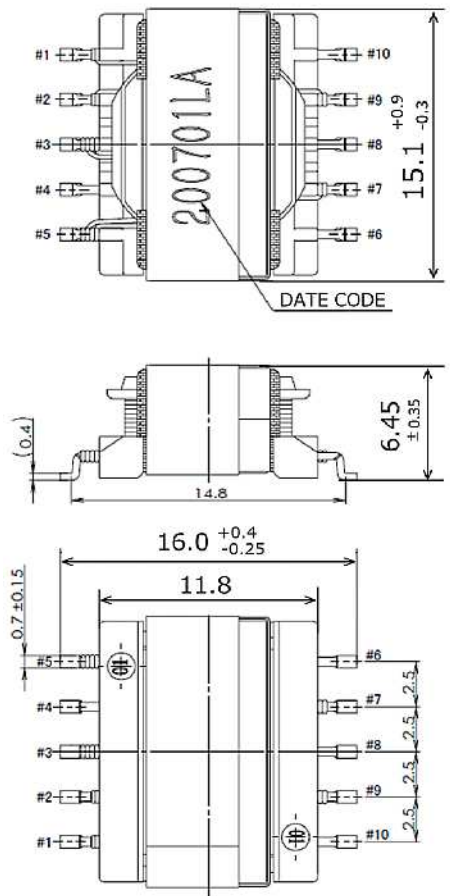

Unit : mm / Tolerance : $\pm \frac{0.4}{0.2}$

(Land Ptttern)

Schematic

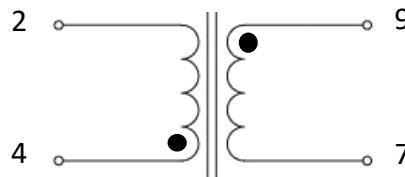

- Any products mentioned in this catalog are subject to any modification in their appearance and others for improvements without prior notification.
- The details listed here are not a guarantee of the individual products at the time of ordering. When using the products, you will be asked to check their specifications.