

1.227 GHz Surface Mount Notch Filter

N012ME9S

DESCRIPTION

One of DLI's surface mountable catalog notch filters designed for L2 Band GPS. This filter utilizes DLI's low loss temperature stable materials which offer small size and minimal performance variation over temperature.

FEATURES

- Small Size
- Shielded Component
- Solder Surface Mount Package
- Moisture Sensitivity Level: MSL1
- Frequency Stable over Temperature
- Operating & Storage Temp: -55°C to +125°C
- Characteristic Impedance: 50Ω

Electrical Specifications

Notch Frequency	1227 MHz
Passband	500 - 1000 MHz & 1500- 2000 MHz
Insertion Loss	1.5 dB Over Passband
Rejection	20 dB @ 1222 –1233 MHz
Size	0.350 X 0.300 X 0.103 inch 8.89 X 7.62 X 2.612 mm

*Electrical specifications based on typical probed performance at room temperature. Insertion loss shall vary ±0.5dB over temperature.

Typical Measured Performance

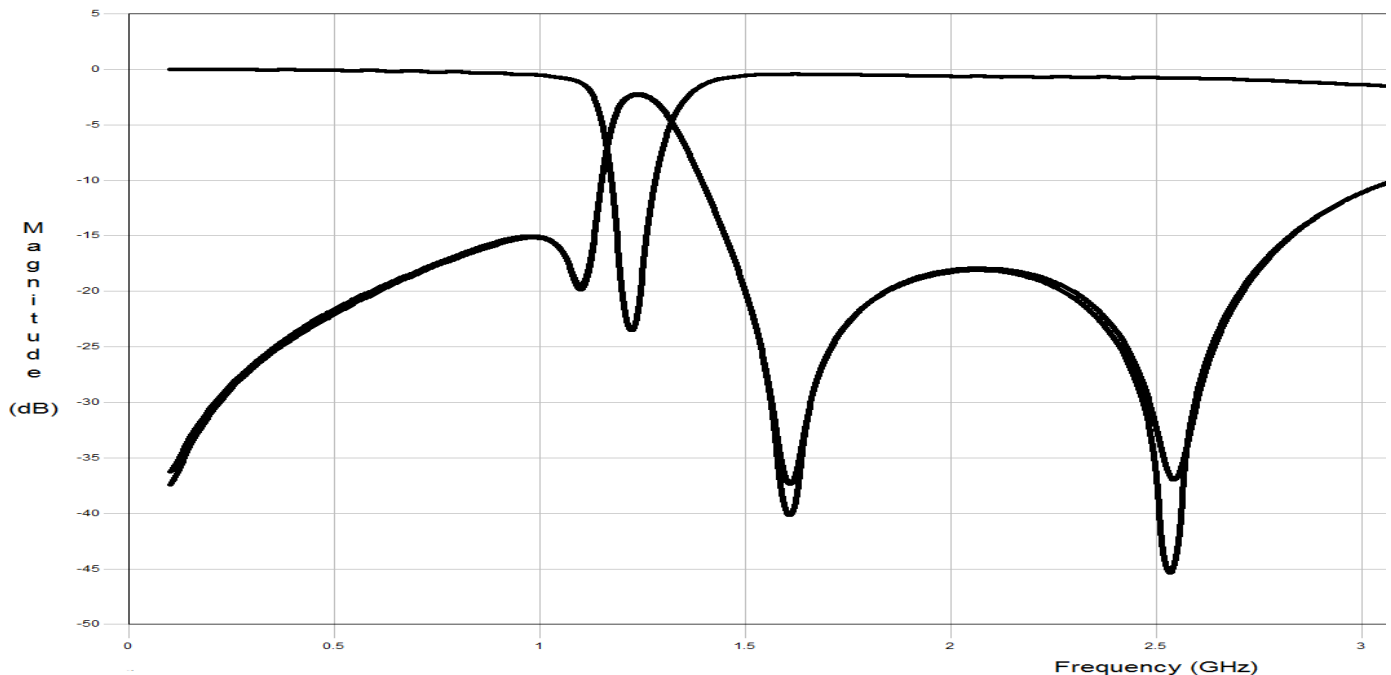

1.227 GHz Surface Mount Notch Filter

N012ME9S

Physical Dimensions

Units = inches

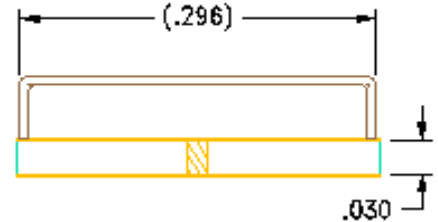
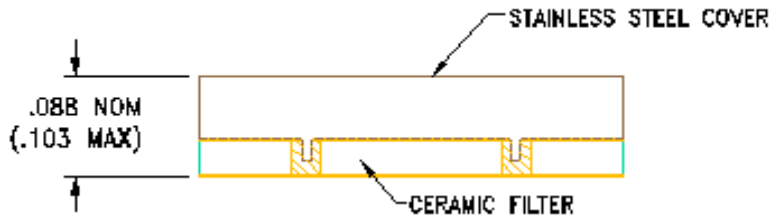
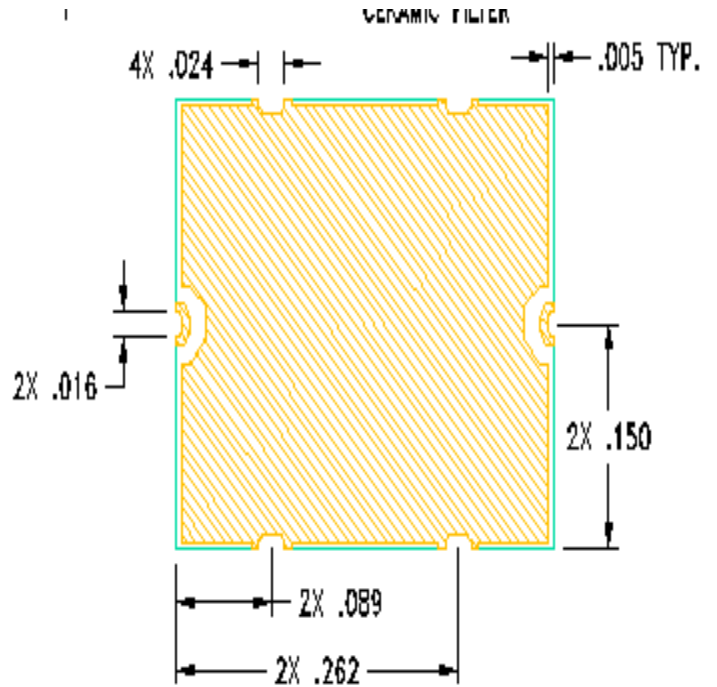
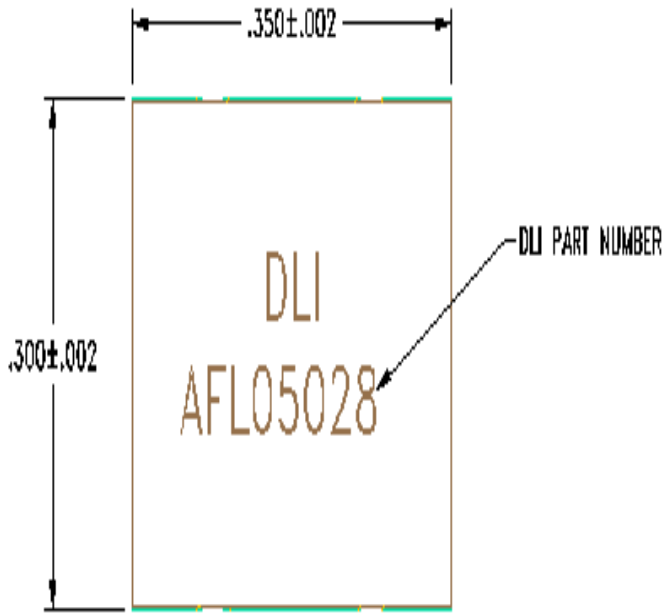

DETAIL A
(2 PLACES)

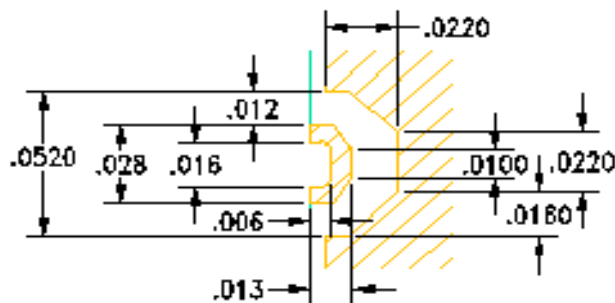

- 50Ω trace dimensions are application specific.
- Ensure adequate grounding beneath the part.

