

REV	DESCRIPTION	BY DATE	APPD
02	EWR 04-136	5/02/04	<i>[Signature]</i>

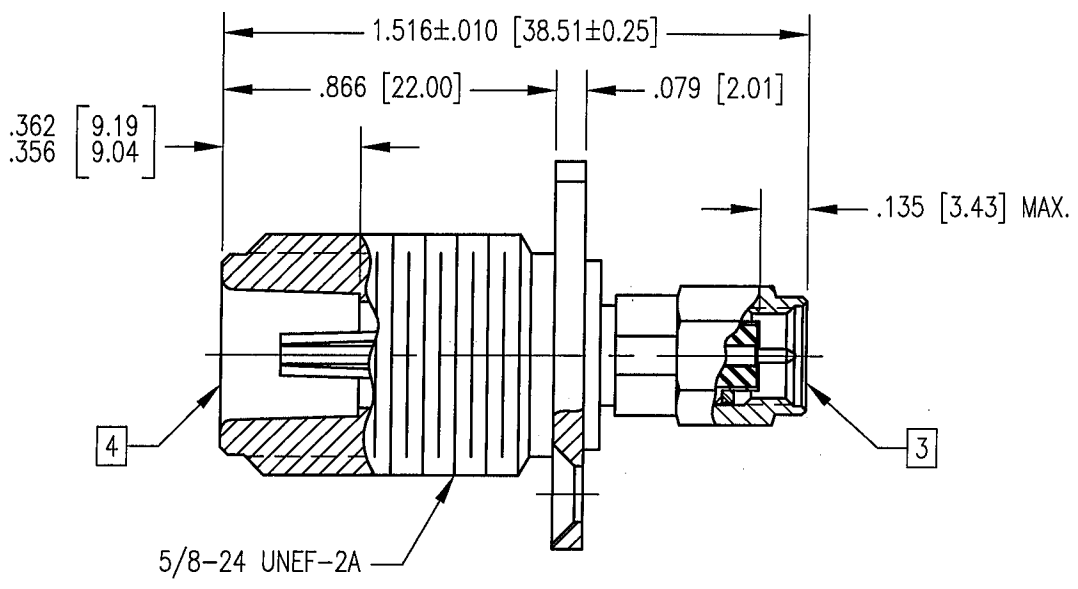
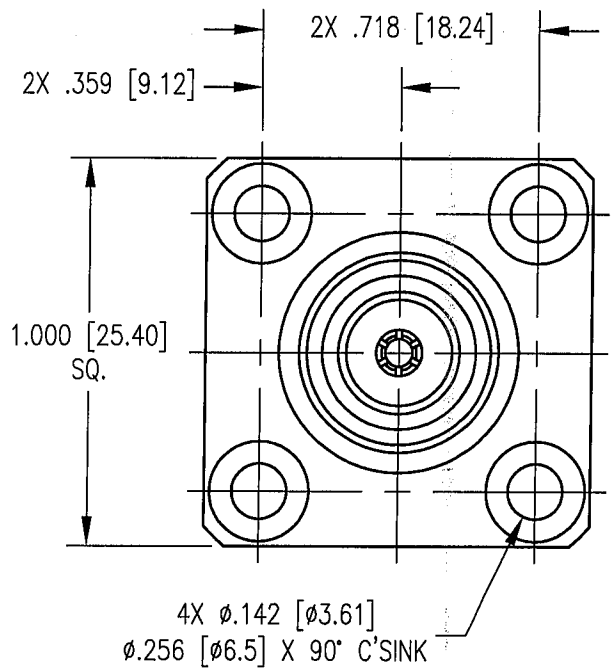

- NOTES:
- MATERIALS:
 BODY AND COUPLING NUT: STAINLESS STEEL PER ASTM A582
 CENTER CONTACT & RETAINING RING: COPPER ALLOY
 INSULATOR: TEFLON PER ASTM D1710
 - FINISH:
 BODY AND COUPLING NUT: PASSIVATED PER ASTM A967
 CENTER CONTACT: GOLD OVER NICKEL
 - SMA MALE INTERFACE PER MIL-C-39012.
 - TYPE N FEMALE INTERFACE PER MIL-C-39012.
 - RETURN LOSS REQUIREMENTS:
 0 - 1.0 GHz: -37 dB MAX.
 1.0 - 2.0 GHz: -33.5 dB MAX.
 2.0 - 3.0 GHz: -31.0 dB MAX.

PER ASME Y14.5M-1994 UNLESS OTHERWISE SPECIFIED: DIMENSIONS ARE IN INCHES [MM]		NORTHROP GRUMMAN Winchester Electronics 62 Barnes Industrial Road North Wallingford, CT 06492	
TOLERANCES: DECIMALS .xx ± .01 [0.254] .xxx ± .005 [0.127] ANGLES ± 2°		SCALE: 2:1	
CUSTOMER DRAWING		TITLE SMA PLUG - TYPE N RECEPTACLE BULKHEAD ADAPTER	
DRAWN JED	DATE 3/1/04	CHECKED CWB	DATE 3/2/04
APPROVED KJT	DATE 3/2/04	APPROVED SD	DATE 3/3/04
A SD250-601-7301P		SHT. OF 1 1	REV. 02