

CONDUCTOR SIZE (AWG)	D MAXIMUM WIRE DIAMETER	MAXIMUM STUD SIZE			CATALOGUE NUMBER			C (NOMINAL)	K (NOMINAL)	L	T	B	STRIP LENGTH	INSTALLATION TOOL
		IMPERIAL	METRIC (mm)	BAG PACK	BOX PACK	BULK PACK								
22-16	1.55 .061	#6	3.5	CR258	T186LF	BBY18LF6	6.35 .250	3.61 .142	16.99 .669	0.81 .032	0.00 +.000 -0.030	7.9 5/16	Y8MRB Y10-22	
		#8	4	CR259	T188LF	BBY18LF8	7.37 .290	4.24 .167	17.91 .705	0.81 .032	0.00 +.000 -0.030	7.9 5/16		
		#10	5	CR260	T1810LF	BBY18LF10	7.37 .290	4.83 .190	19.05 .750	0.81 .032	0.00 +.000 -0.030	7.9 5/16		
16-14	1.96 .077	#6	3.5	CR261	T146LF	BBY14LF6	7.62 .300	3.61 .142	19.56 .770	1.02 .040	0.00 +.000 -0.030	9.5 3/8	Y8MRB Y10-22	
		#8	4	CR262	T148LF	BBY14LF8	9.40 .370	4.24 .167	20.32 .800	1.02 .040	0.00 +.000 -0.030	9.5 3/8		
		#10	5	CR266	T1410LF	BBY14LF10	9.40 .370	4.83 .190	21.71 .855	1.02 .040	0.00 +.000 -0.030	9.5 3/8		
12-10	3.15 .124	#6	3.5	CR264	T106LF	BBY10LF6	12.45 .490	6.35 .250	25.86 1.018	1.02 .040	0.00 +.000 -0.030	9.5 3/8	Y8MRB Y10-22	
		#8	4	CR265	T108LF	BBY10LF8	12.45 .490	6.35 .250	25.86 1.018	1.02 .040	0.00 +.000 -0.030	9.5 3/8		
		#10	5	CR266	T1010LF	BBY10LF10	12.45 .490	6.35 .250	25.86 1.018	1.02 .040	0.00 +.000 -0.030	9.5 3/8		

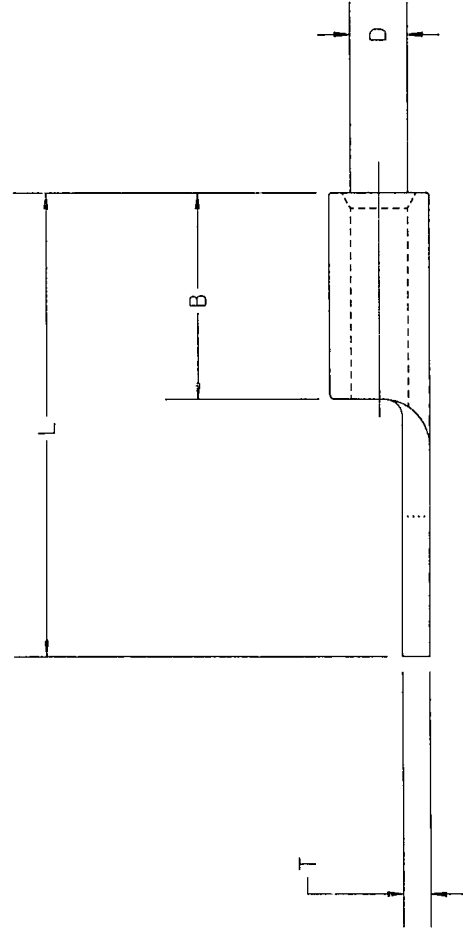

NOTES:

1. PURE ELECTROLYTIC COPPER, TIN PLATED
2. BRAZED SEAM, COMPLETE CIRCULAR BARREL
3. ZONE ANNEALING OFFERS SOFT BARREL FOR EASY CRIMPING WITHOUT LOOSING TEMPER OF PAD.

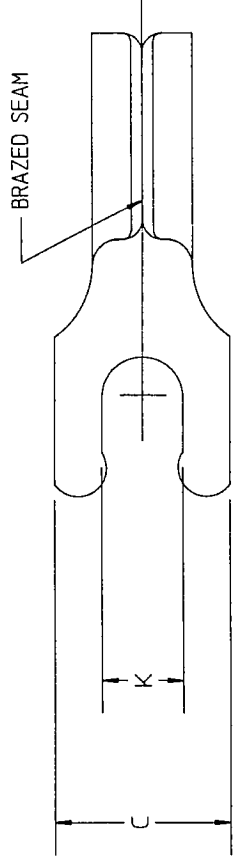

4. LISTED, FILE No. LR 38612

NO. OF DECIMAL PLACES	TOLERANCES	
	METRIC	INCH
1	±.8	±.03
2	±.8	±.03
3	±.38	±.015
ANGLES		±.0° -30°

APPROVED BY: *[Signature]* 5/16/94

FORKLOK, LOCKING FORK TERMINAL

TYPE CR, T-LF, BBY-LF SCALE $\frac{1}{2}$

DRAWN H. GILL 5/16/94 CHECKED *[Signature]* 5/16/94

DWG# CSD32959 REV. 0

BURNDY
an FCI Company
530 BIRCHMOUNT ROAD, SCARBOROUGH, ONTARIO

REV.	DATE	BY	CHECK	REVISION DESCRIPTION
0	5/19/94	HG	✓	NEW RELEASE

THIS DRAWING IS DUAL DIMENSIONED
ALL DIMENSIONS IN MILLIMETERS AND
INCHES eg. 25.4 mm OR 25.4 mm (1.00 INCH)
SIGNATURES BASED ON INCH SYSTEM.

