

G Series Connectors

Bulkhead Jack, Crimp

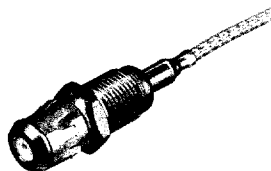

RG/U Cable	Termination Type	Body Plating	Part No.
179	Crimp	Nickel	415683-1
Conformable Cable	Crimp	Nickel	415683-2
RD 179 Double Braid	Crimp	Nickel	415683-3

Termination Tooling: Use 220210-1 die set for Contact only.
Use Certi-Crimp Hand Tool 220009-1 for ferrule.

Bulkhead Jack, PC Board

Connector will accept center conductor diameter range **0.97–1.65** [.038–.065] (415332-1 only)

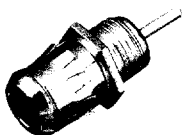

Part No. 415332-1 (15 Amp)
Part No. 415888-1
Part No. 1274032-1

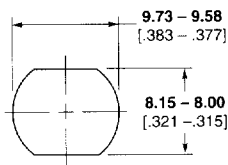

Recommended Panel Cutout for 415332-1 and 415888-1

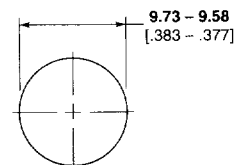

Recommended Panel Cutout for 1274032-1

Bulkhead Jack, PC Board, Sealed

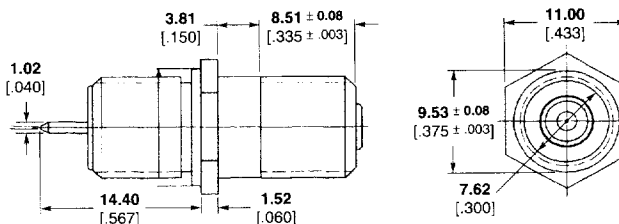
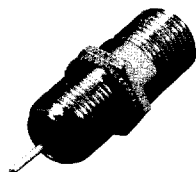

Part No. 1274064-1

Jack, Bulkhead PC Board

Connector will accept center conductor diameter range **0.97–1.07** [.038–.042]

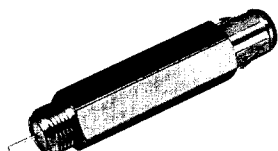

Part No. 887000-1

Right Angle PC Board Mount Jack with Louvertac Band

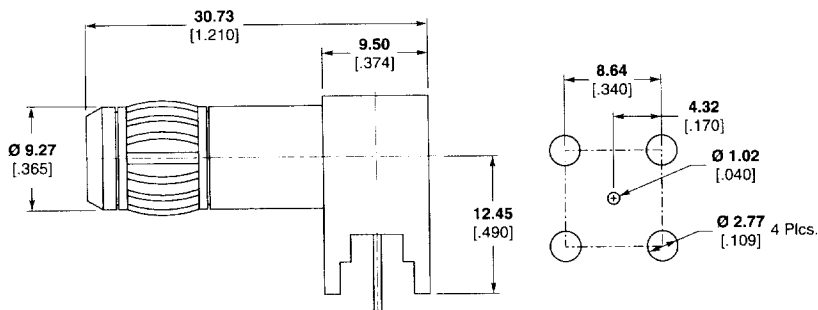
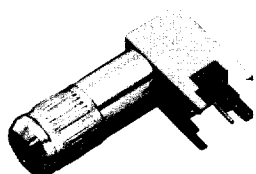

Part No. 1274401-1