

AMPLIMITE .050 Series, High Density Narrow Terminators With Internal Shield, All-Plastic Cover, Standard Profile, With Spring Latches (Continued)

Plug, 50-Position

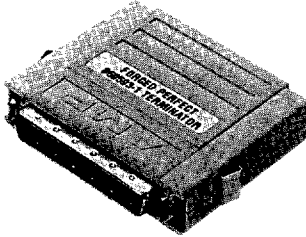

Material and Finish:

Shell—Carbon steel

Spring Latches—Stainless steel

Housing—UL 94V-0 rated polyester, black

Cover—UL 94V-0 rated ABS, gray

Contacts—Phosphor bronze, duplex plated .000030 [0.00076] min. gold for a length of .132 [3.35] min. from mating end over .000050 [0.00127] min. nickel

Circuitry—Thick film resistors and/or discreet components on alumina substrate or plastic laminate

Shield—Copper

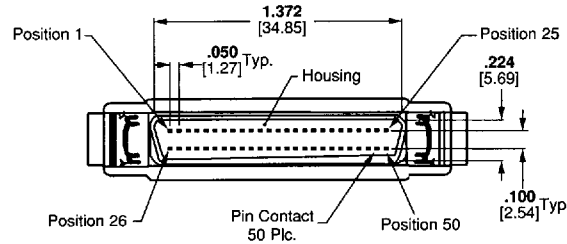
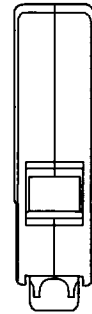
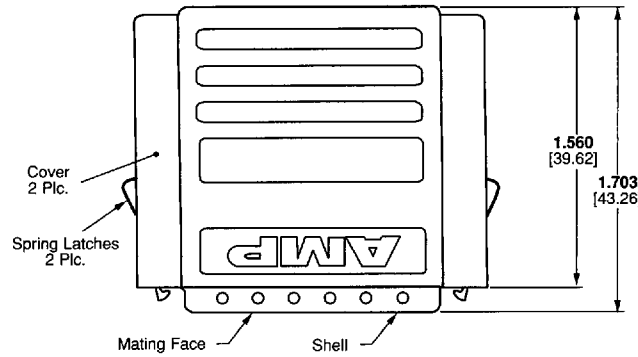
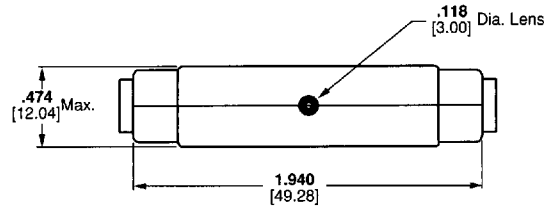

"A" Cable
Single-Ended, Active
Part No. 869912-1

