

**STRAIGHT JACK CLAMP TYPE  
CABLE LCF 7/8**

**R185.218.000**  
**SERIES 7-16**

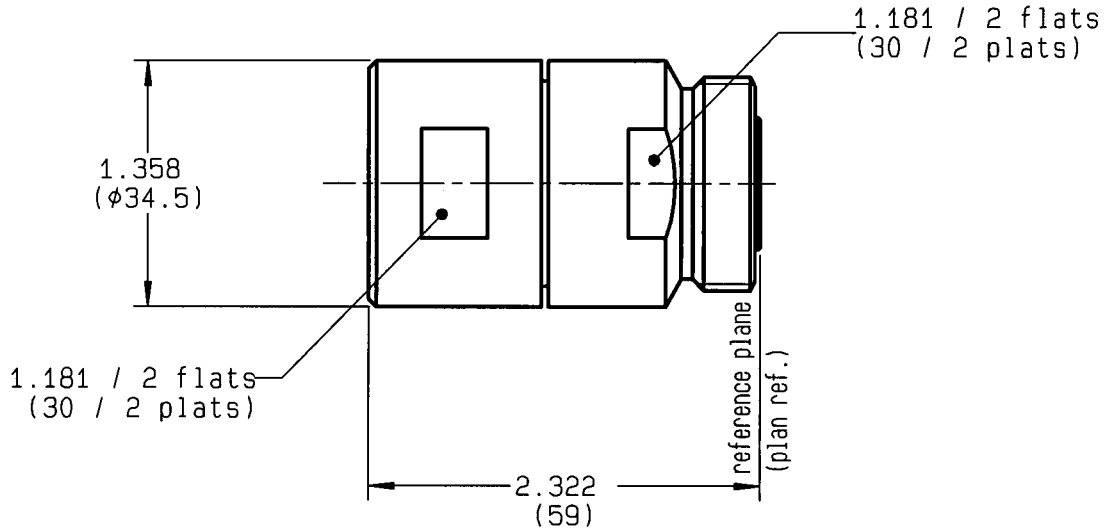

NOMINAL IMPEDANCE	<b>50</b> Ω	CABLES : LCF 7/8' Cu2Y
FREQUENCY RANGE	<b>0-7.5</b> GHz	
TEMPERATURE RATING	<b>-55/+155</b> °C	
V.S.W.R	<b>1.04</b> + x F(GHz)Maxi	
RF INSERTION LOSS	<b>0.05</b> √F(GHz) dB Maxi	
VOLTAGE RATING	<b>1400</b> Veff Maxi	
DIELECTRIC WITHSTANDING VOLTAGE	<b>2700</b> Veff Mini	
INSULATION RESISTANCE	<b>10000</b> M ΩMini	OTHERS CHARACTERISTICS
HERMETIC SEAL	<b>NA</b> Atm.cm <sup>3</sup> /s	CABLE RETENTION <b>500</b> N Mini
LEAKAGE (pressurized only)	<b>NA</b>	CENTER CONTACT RETENTION
MECHANICAL DURABILITY	<b>500</b> Cycles	Axial force - mating end <b>200</b> N Mini
WEIGHT	gr	Axial force - opposite end <b>200</b> N Mini
SPECIFICATION		Torque <b>NA</b> cm.N Mini
		RECOMMENDED TORQUES
		Mating <b>3000</b> cm.N
		Panel nut <b>NA</b> cm.N
		Clamp nut <b>2500</b> cm.N

CONNECTOR PARTS	MATERIALS	FINISH	(all values are given in micrometers)
BODY	BRASS	SILVER .	
OUTER CONTACT	BRASS	SILVER .	
CENTER CONTACT	BERYLLIUM COPPER	SILVER .	
INSULATOR	PTFE	-	
GASKET		-	
OTHERS PIECES		-	

GAUTIER	ISSUE	CREATION DATE	FILE PART-NUMBER	
	<b>9944D00</b>	<b>13/10/1994</b>		

The information given here is subject to change without notice.  
Design changes may be in order to improve the product .

*Connect to the future*

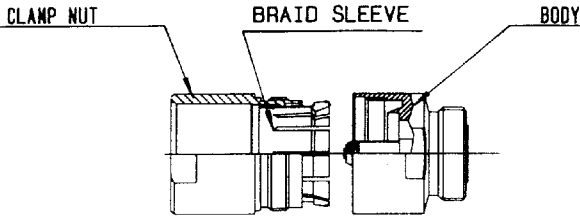

①

Disassembly of connector  
Strip the cable  
Position of cutting on corrugation crest.  
Deburn (remove all the particles)  
Do not deform the cable

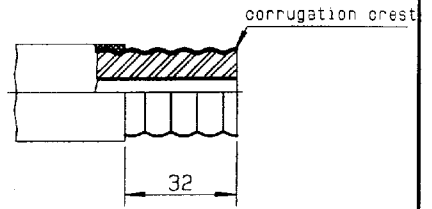

②

Slide the clamp nut and the braid sleeve onto cable until part snaps in at first corrugation root.

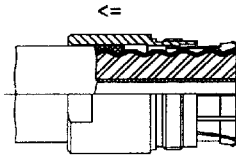

③

Slide the clamp nut over the braid sleeve until stop.

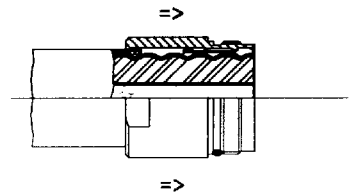

④

Slide the body.  
Screw the clamp nut only.  
(recommended coupling torque:25 Nm)

