

K8346-0034

K Jack Solder Clamp For Panel Receptacle 50Ω

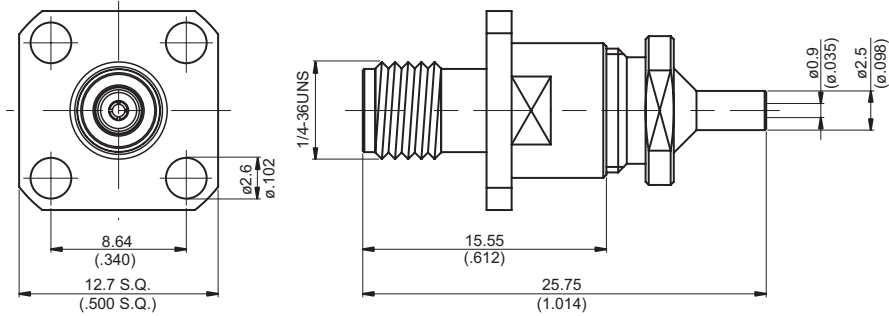

MOUNTING HOLE

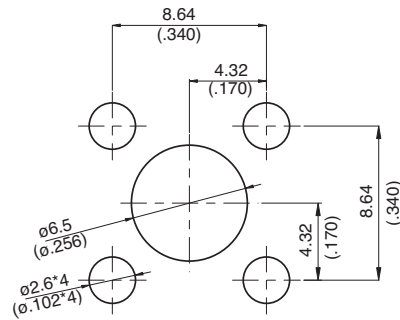

Parts	Material	Plating (Micro-inch)
Nut	Stainless Steel	Passivated
Solder Ferrule	Brass	Gold 5 over Nickel 50 over Copper 50
Ferrule	Stainless Steel	Passivated
Contact Pin	Beryllium Copper	Gold 20 over Nickel 50 over Copper 50
Insulator	P.P.O.	
Body	Stainless Steel	Passivated

Weight:
Suitable Cables: Semi-rigid.034

This part number complies with RoHS.
Notice: JYEBAO reserves the right to make modifications deemed appropriate.

CABLE ASSEMBLY INSTRUCTION

K8346-0034

JYE BAO CO., LTD.

C

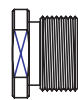

NUT

B

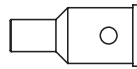

SOLDER FERRULE

A

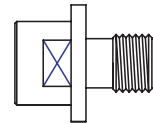

BODY

DIAGRAM

ASSEMBLY INSTRUCTION

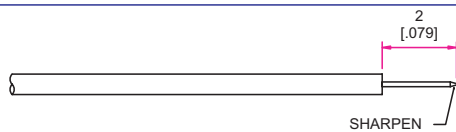

Step 1: STRIP AS SHOWN .
Step 2: SHARPEN CENTER CONDUCTOR TIP.

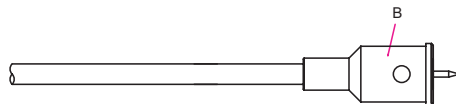

Step 3: PUT SOLDER FERRULE " B " IN PLACE .

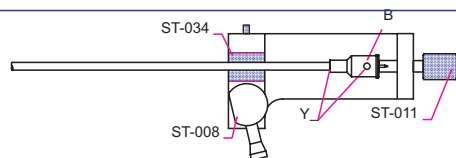

Step 4: INSERT PREPARED CABLE INTO SOLDERING FIXTURE " ST-008 ", INSERT TOOL " ST-034 " AND LOCATOR TOOL " ST-011 " TO FIX THE CONNECTOR. SOLDER IN " Y " .

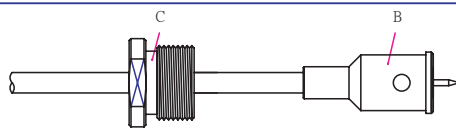

Step 5: SLIDE NUT " C " IN PLACE .

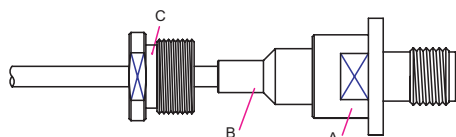

Step 6: SLIDE SOLDER FERRULE " B " INTO THE CONNECTOR BODY " A " .

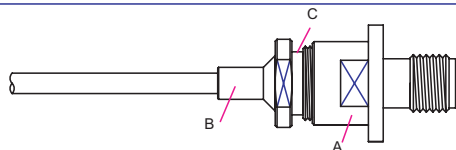

Step 7: FINALLY SCREW NUT " C " ON THE CONNECTOR BODY " A " .

This part number complies with RoHS.

Notice: JYEBAO reserves the right to make modifications deemed appropriate.