

GSD

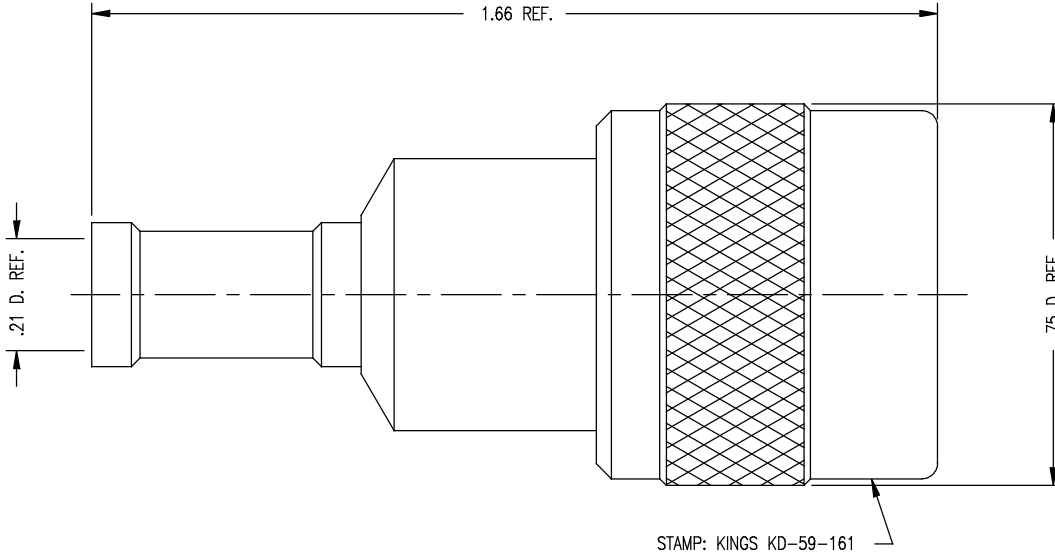

NOTES:

1. FOR USE WITH RG-58, BA-5903 & RAYCHEM 09-058 CABLES.
2. FOR CABLING INSTRUCTIONS SEE CP-5406.
3. FOR CABLE TRIMMING USE KTJ-160 & KTD-208.
4. FOR CRIMPING USE DIE KTH-2101.
5. CENTER CONTACT, 1-903-12MA9, & K-GRIP SLEEVE, C-19-126-8-M06, TO BE SUPPLIED UNASSEMBLED.
6. MARK PACKAGE: KINGS KD-59-161
XX XX (DATE CODE)
7. MATERIALS:
 INSULATOR: TEFLON, ASTM-D-1457
 GASKET: SIL. RUB., ZZ-R-765
 K-GRIP SLEEVE: COM. BRONZE TUBE, ALLOY 220
 OUTER CONTACT } BER. COP., ASTM-B-196
 SPRING WASHER }
 ALL OTHER PARTS: BRASS, ASTM-B16
8. FINISHES:
 OUTER CONTACT } SILVER PLT. PER QQ-S-365
 SPRING WASHER }
 CENTER CONTACT: HARD GOLD PLT. PER MIL-G-45204
 ALL OTHER METAL PARTS: KINGS TARNISH RESISTANT FINISH (TR-5)
9. ELECTRICAL CHARACTERISTICS:
 NOMINAL IMPEDANCE: 50 OHMS
 VOLTAGE RATING: 1000 VRMS
 FREQUENCY RANGE: DC TO 11 GHz
10. INTERFACE PER MIL-STD-348, FIG. 302-1.

KD-59-161

REVISIONS

ISSUE	CHANGES
4	CN 33167 C REDRAWN KH 07/08/91
5	CN 34558 A JCA 04/12/93

KAM1257

SCALE 4:1

APPROX SURFACE AREA

USED ON

REF: BOEING

PLUG, C

DRAWN KH DATE 07/08/91

DESIGN CT DATE 07/08/91

APPR. DATE

KINGS
ELECTRONICS CO., INC.
TUCKAHOE, NEW YORK 10707

GSD

KD-59-161