

SSMB Cable and Printed Circuit Board Connectors

Product Facts

- Meets requirements of IEC 169-19 document
- Performance to 12.4 GHz
- Crimp center contacts for straight plugs and jacks
- Uses industry standard crimp tools
- 30 to 40 percent smaller than SMB designs
- Low profile versions have mated height of less than .500 [12.7]
- Gold plated contacts
- Three-piece component assembly

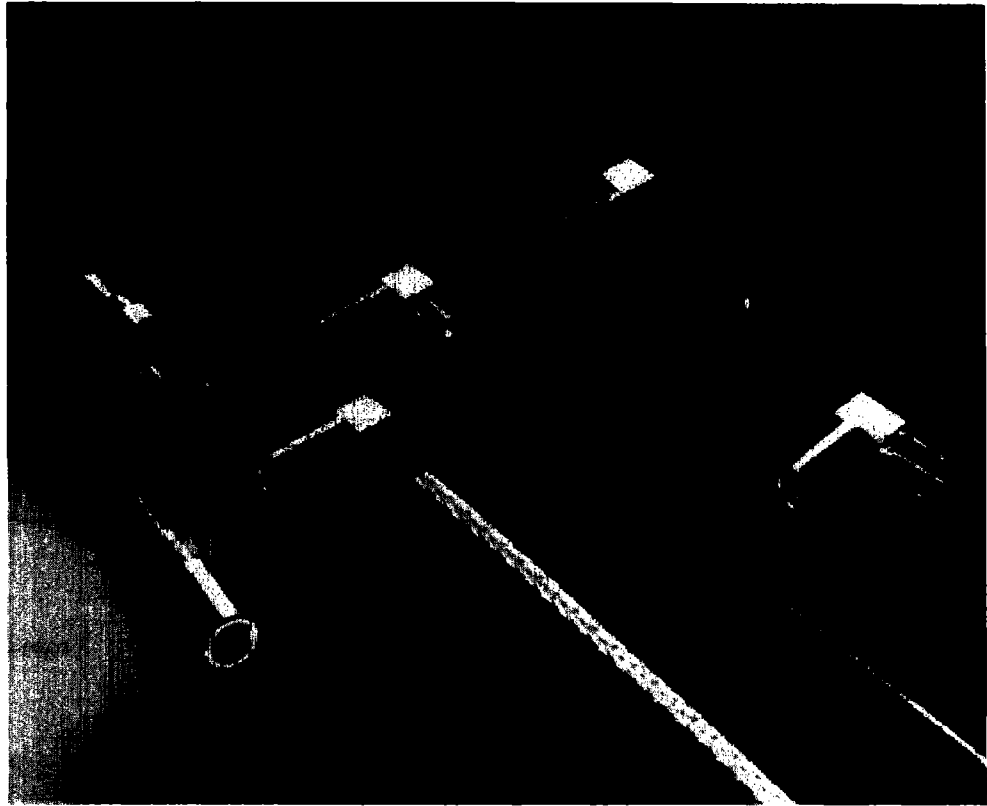

Packaging space is becoming a premium commodity, and a new low cost snap-on connector is needed. SSMB board mounted products have a .100 by .100 [2.54 by 2.54] center footprint, or a .200 by .200 [5.08 by 5.08] footprint for SMB retrofits. Its mated height and packaging volume reduces space requirements by 30 to 40 percent over present

conventional packaging. Increased performance to 12.4 GHz accommodates today's higher frequency requirements.

The AMP SSMB connectors conform to international standards such as IEC 169-19. By using industry standard crimp tools, no special manufacturing processes are needed. Crimping of various

center contacts increases yields while reducing assembly time. Popular cable sizes such as RG316, RD316, RG178 and RG405 are accommodated. Board mounted products offer options with and without stand-offs to conform to various printed circuit board assembly requirements. Three-piece component assembly reduces product complexity.

SSMB Cable and Printed Circuit Board Connectors

(Continued)

Straight Plug

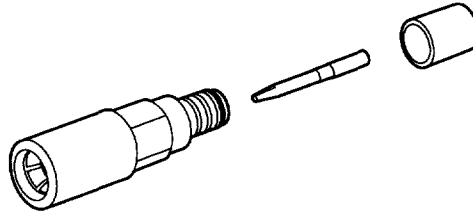

RG/U	Part No.	Center Contact Crimp		Ferrule Crimp	
		Military Tool	Positioner	Military Tool	Die Part No.
178, 178A, 178B, 196, 196A	447970-1	M22520/2-01	K996	M22520/5-01	M22520/5-03
174, 174A, 188, 188A, 316	447970-2	M22520/2-01	K996	M22520/5-01	M22520/5-03
174DB, 316DB	447970-3	M22520/2-01	K996	M22520/5-01	M22520/5-03

Bulkhead Jack

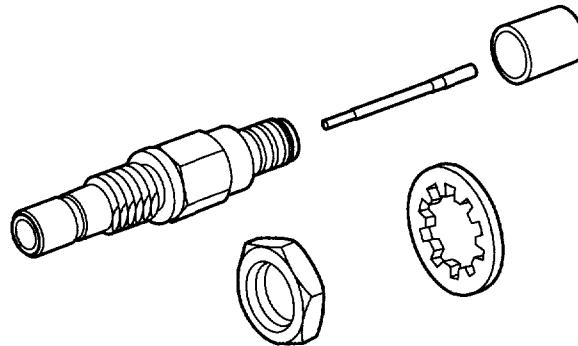

RG/U	Part No.	Center Contact Crimp		Ferrule Crimp	
		Military Tool	Positioner	Military Tool	Die Part No.
178, 178A, 178B, 196, 196A	447971-1	M22520/2-01	K996	M22520/5-01	M22520/5-03
174, 174A, 188, 188A, 316	447971-2	M22520/2-01	K996	M22520/5-01	M22520/5-03
174DB, 316DB	447971-3	M22520/2-01	K996	M22520/5-01	M22520/5-03

Right-Angle Plug

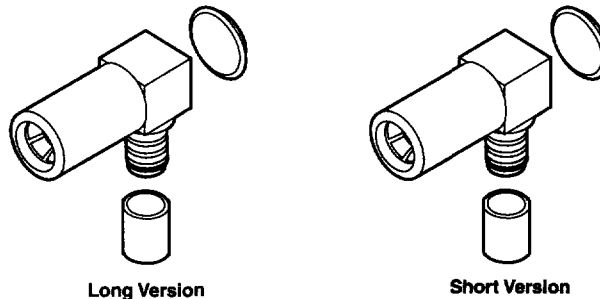

RG/U	Part No.	Ferrule Crimp	
		Military Tool	Die Part No.
178, 178A, 178B, 196, 196A	447392-1*	M22520/5-01	M22520/5-03
405, Belden 9307	447392-2*	N/A	N/A
174, 174A, 188, 188A, 316	447392-3*	M22520/5-01	M22520/5-03
174DB, 316DB	447392-4*	M22520/5-01	M22520/5-03
174, 174A, 188, 188A, 316	447392-5**	M22520/5-01	M22520/5-03

* Long Version

** Short Version to be used with Low Profile Jack, Part No. 448028-1

**SSMB Cable and
Printed Circuit
Board Connectors**
(Continued)
End Cap Insertion Tool

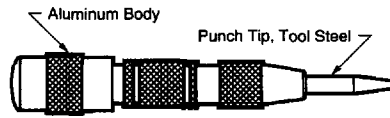

Part No. 448078-1

Vertical PCB Jack

Part No. 448028-1*
(Low Profile)

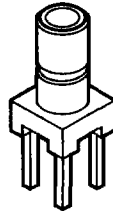

Part No. 447992-1
(With Standoffs)

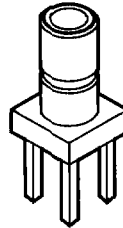

Part No. 447992-2
(Without Standoffs)

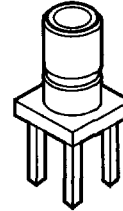

Part No. 447999-1
(.200 [5.08] Centerline with Standoffs)

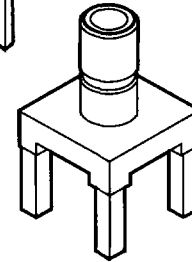

*Low Profile Jack to be used with Short Right-Angle Plug, **Part No. 447392-5**.

Right-Angle PCB Jack

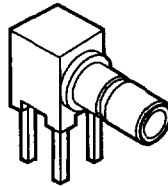

Part No. 447985-1
(With Standoffs)

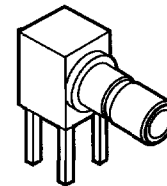

Part No. 447985-2
(Without Standoffs)

Right-Angle PCB Plug

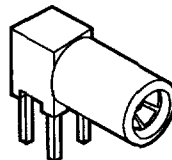

Part No. 447997-1
(With Standoffs)

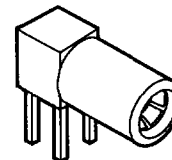

Part No. 447997-2
(Without Standoffs)

Coaxial and Flat Coaxial Cable Connectors
SSMB Connectors

4