

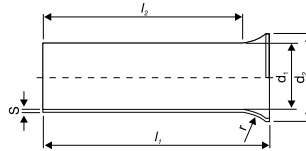

END SLEEVES

W/O Insulating Sleeve, DIN 46228, Part 1
 Material: ETP-Copper
 Surface: Tin Plated





Conductors mm ²	3D Cat No.	Dimension In mm					Tools	Packing Qty. 
		d ₁	d ₂	s	L ₁	L ₂		
25	3D-8046	7.3	9.5	0.2	15	13.0	3D-110	250
	3D-8047	7.3	9.5	0.2	18	16.0		
	3D-8048	7.3	9.5	0.2	25	23.0		
	3D-8049	7.3	9.5	0.2	32	29.0		
35	3D-8050	8.3	10.5	0.2	18	16.0	3D-110	100
	3D-8051	8.3	10.5	0.2	25	23.0		
	3D-8052	8.3	10.5	0.2	32	30.0		
50	3D-8053	10.3	13.0	0.3	18	15.0	3D-110	100
	3D-8054	10.3	13.0	0.3	25	22.0		
	3D-8055	10.3	13.0	0.3	32	29.0		
70	3D-8056	13.5	15.5	0.4	25	22.0	3D-110	100
	3D-8057	13.5	15.5	0.4	32	29.0		
95	3D-8058	14.7	17.0	0.4	25	22.0	3D-110	100
	3D-8059	14.7	17.0	0.4	32	29.0		
120	3D-8060	16.7	19.0	0.45	32	29.0	3D-110	50
	3D-8061	16.7	19.0	0.45	40	37.0		
150	3D-8062	19.5	21.5	0.5	32	29.0	3D-110	50
	3D-8063	19.5	21.5	0.5	40	37.0		
185	3D-8064	20.0	23.5	0.6	32	29.0	3D-110	25
	3D-8065	20.0	23.5	0.6	40	37.0		

SHEET METAL LUGS

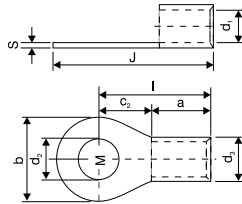
Ring Type
 Brazed Seam
 Material: ETP-Copper
 Surface: Tin Plated





Conductors mm ²	Bolt Ø	3D Cat No.	Dimensions in mm										Tools	Crimping Profile	Packing Qty
			d ₁	d ₂	d ₃	b	s	a	C ₂	l	J				
0.5 To 1.5mm ²	M 2	3D-1263	1.6	3.2	2.2	6	0.8	5	6	11	14	3D-2		200	
	M 2.5	3D-1242	1.6	3.2	2.6	6	0.8	5	6	11	14				
	M 3	3D-1247	1.6	3.2	3.2	6	0.8	5	6	11	14	3D-17			
	M 3	3D-1260	1.6	3.2	3.2	6.8	0.8	5	4.6	9.6	13				
	M 3	3D-1265	1.6	3.2	3.2	8	0.8	5	7	12	16				
	M 3.5	3D-1269	1.6	3.2	3.7	6	0.8	5	6	11	14				
	M 3.5	3D-1257	1.6	3.2	3.7	6.8	0.8	5	4.6	9.6	13				
	M 4	3D-1241	1.6	3.2	4.2	6	0.8	5	6	11	14				
	M 4	3D-1258	1.6	3.2	4.2	6.8	0.8	5	4.6	9.6	13				
	M 4	3D-1246	1.6	3.2	4.2	8	0.8	5	7	12	16				
	M 4	3D-1261	1.6	3.2	4.2	7	0.8	5	6	11	14.5				
	M 4	3D-1266	1.6	3.2	4.2	10	0.8	5	8	13	18				
	M 5	3D-1262	1.6	3.2	5.2	8	0.8	5	7	12	16				
	M 5	3D-1267	1.6	3.2	5.2	10	0.8	5	8	13	18				
	M 6	3D-1224	1.6	3.2	6.4	10	0.8	5	8	13	18				
M 6	3D-1268	1.6	3.2	6.4	12	0.8	5	7	12	18					
M 8	3D-1252	1.6	3.2	8.2	12	0.8	5	12	17	23					
2.5mm ²	M 3	3D-1308	2.3	3.9	3.2	6.5	0.8	5	4.5	9.5	12.7	3D-2		200	
	M 3.5	3D-1292	2.3	3.9	3.7	6.5	0.8	5	4.5	9.5	12.7				
	M 3.5	3D-1309	2.3	3.9	3.7	8	0.8	5	7	12	16	3D-17			
	M 4	3D-1296	2.3	3.9	4.2	8	0.8	5	7	12	16				
	M 5	3D-1304	2.3	3.9	5.2	8	0.8	5	7	12	16				
	M 5	3D-1310	2.3	3.9	5.2	10	0.8	5	8	13	18				
	M 5	3D-1313	2.3	3.9	5.2	12	0.8	5	11	16	22				
	M 6	3D-1342	2.3	3.9	6.4	10	0.8	5	8	13	18				
	M 6	3D-1305	2.3	3.9	6.4	12	0.8	5	11	16	22				
	M 6	3D-1314	2.3	3.9	6.4	16	0.8	5	12	17	25				
	M 8	3D-1307	2.3	3.9	8.2	12	0.8	5	11	16	22				
	M 8	3D-1311	2.3	3.9	8.2	16	0.8	5	12	17	25				
	M 10	3D-1287	2.3	3.9	10.2	16	0.8	5	12	17	25				
	M 10	3D-1524	2.3	3.9	10.2	18	0.8	5	15	20	29				
	M 12	3D-1438	2.3	3.9	12.7	18	0.8	5	15	20	29				

SHEET METAL LUGS

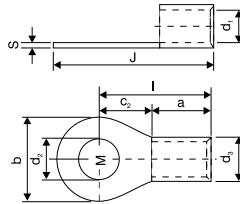
Ring Type
 Brazed Seam
 Material: ETP-Copper
 Surface: Tin Plated





Conductors mm ²	Bolt 0	3D Cat No.	Dimension in mm									Tools	Crimping Profile	Packing Qty
			d ₁	d ₂	d ₃	b	s	a	c ₂	l	J			
4mm ² To 6mm ²	M 4	3D-1432	3.5	5.5	4.2	8	1	6	7	13	17	3D-17 3D-2		200
	M 4	3D-1435	3.5	5.5	4.2	10	1	6	8	14	19			
	M 5	3D-1431	3.5	5.5	5.2	8	1	6	7	13	17			
	M 5	3D-1408	3.5	5.5	5.2	10	1	6	8	14	19			
	M 5	3D-1433	3.5	5.5	5.2	8	1	6	12.8	18.8	22.8			
	M 5	3D-1405	3.5	5.5	5.2	12	1	6	8	14	20			
	M 5	3D-1404	3.5	5.5	5.2	12	1	6	10	16	22			
	M 6	3D-1415	3.5	5.5	6.4	12	1	6	8	14	20			
	M 6	3D-1417	3.5	5.5	6.4	12	1	6	10	16	22			
	M 6	3D-1406	3.5	5.5	6.4	14	1	6	12.5	18.5	25.5			
	M 8	3D-1416	3.5	5.5	8.2	12	1	6	8	14	20			
	M 8	3D-1421	3.5	5.5	8.2	14	1	6	12.5	18.5	25.5			
	M 8	3D-1407	3.5	5.5	8.2	16	1	6	16	22	30			
	M 8	3D-1429	3.5	5.5	8.2	18	1	6	15	21	30			
	M 9	3D-1410	3.5	5.5	9.7	14	1	6	12.5	18.5	25.5			
	M 10	3D-1427	3.5	5.5	10.2	16	1	6	16	22	30			
M 10	3D-1428	3.5	5.5	10.2	18	1	6	15	21	30				
M 12	3D-1430	3.5	5.5	12.7	18	1	6	15	21	30				
10mm ²	M 4	3D-1463	4.3	6.3	4.2	10	1	8	9	17	22	3D-2		200
	M 4	3D-1464	4.3	6.3	4.2	10	1	8	7	15	20			
	M 5	3D-1459	4.3	6.3	5.2	10	1	8	9	17	22			
	M 5	3D-1460	4.3	6.3	5.2	10	1	8	7	15	20			
	M 6	3D-1465	4.3	6.3	6.4	12	1	8	9	17	23			
	M 8	3D-1466	4.3	6.3	8.2	16	1	8	11	19	27			
	M 8	3D-1467	4.3	6.3	8.2	18	1	8	13	21	30			
	M 10	3D-1461	4.3	6.3	10.2	18	1	8	13	21	30			
	M 10	3D-1468	4.3	6.3	10.2	22	1	8	15	23	34			
	M 12	3D-1462	4.3	6.3	12.7	22	1	8	15	23	34			

SHEET METAL LUGS

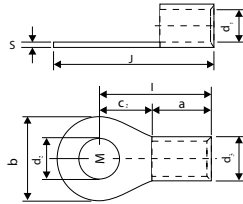
Ring Type
 Brazed Seam
 Material: ETP-Copper
 Surface: Tin Plated





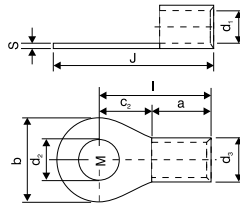

Conductors mm ²	Bolt 0	3D Cat No.	Dimension in mm									Tools	Crimping Profile	Packing Qty
			d ₁	d ₃	d ₂	b	s	a	C ₁	l	J			
16mm ²	M 5	3D-1516	5.6	8	5.2	10	1.2	10	9	19	24	3D-2		200
	M 5	3D-1517	5.6	8	5.2	12	1.2	10	10	20	26	3D-109		
	M 6	3D-1511	5.6	8	6.4	12	1.2	10	10	20	26	3D-109		
	M 6	3D-1518	5.6	8	6.4	16	1.2	10	12	22	30	3D-109		
	M 8	3D-1512	5.6	8	8.2	16	1.2	10	12	22	30	3D-109		
	M 8	3D-1519	5.6	8	8.2	18	1.2	10	14	24	33	3D-109		
	M 9	3D-1513	5.6	8	9.7	16	1.2	10	12	22	30	3D-109		
	M 10	3D-1514	5.6	8	10.2	18	1.2	10	14	24	33	3D-109		
	M 10	3D-1520	5.6	8	10.2	22	1.2	10	14	24	35	3D-109		
	M 12	3D-1515	5.6	8	12.7	22	1.2	10	14	24	35	3D-109		
25mm ²	M 6	3D-1561	7.5	11.1	6.4	12	1.8	11	14	25	31	3D-109		200
	M 6	3D-1557	7.5	11.1	6.4	16	1.8	11	11	22	30	3D-109		
	M 6	3D-1558	7.5	11.1	6.4	16	1.8	11	14	25	33	3D-109		
	M 8	3D-1556	7.5	11.1	8.2	12	1.8	11	14	25	31	3D-109		
	M 8	3D-1552	7.5	11.1	8.2	16	1.8	11	11	22	30	3D-109		
	M 8	3D-1554	7.5	11.1	8.2	16	1.8	11	14	25	33	3D-109		
	M 10	3D-1553	7.5	11.1	10.2	16	1.8	11	11	22	30	3D-109		
	M 10	3D-1559	7.5	11.1	10.2	18	1.8	11	14	25	34	3D-109		
	M 10	3D-1560	7.5	11.1	10.2	22	1.8	11	20	31	42	3D-109		
	M 12	3D-1555	7.5	11.1	12.7	22	1.8	11	20	31	42	3D-109		
35mm ²	M 6	3D-1584	9	12.6	6.4	16	1.8	12	11	23	31	3D-109		400
	M 8	3D-1581	9	12.6	8.2	16	1.8	12	11	23	31	3D-109		
	M 8	3D-1585	9	12.6	8.2	18	1.8	12	15	27	36	3D-109		
	M 8	3D-1582	9	12.6	10.8	18	1.8	12	15	27	36	3D-109		
	M 8	3D-1586	9	12.6	10.2	22	1.8	12	19	31	42	3D-109		
	M 8	3D-1583	9	12.6	12.7	22	1.8	12	19	31	42	3D-109		

SHEET METAL LUGS

Ring Type
 Brazed Seam
 Material: ETP-Copper
 Surface: Tin Plated





Conductors mm ²	Bolt 0	3D Cat No.	Dimension in mm										Tools	Crimping Profile	Packing Qty
			d ₁	d ₃	d ₂	b	s	a	C ₂	l	J				
50mm ²	M 8	3D-1609	10.5	14.1	8.2	18	1.8	16	18	34	43	3D-109		200	
	M 10	3D-1607	10.5	14.1	10.2	18	1.8	16	18	34	43				
	M 10	3D-1610	10.5	14.1	10.2	22	1.8	16	16	32	43				
	M 10	3D-1611	10.5	14.1	10.2	24	1.8	16	20	36	48				
	M 12	3D-1608	10.5	14.1	12.7	24	1.8	16	20	36	48				
	M 16	3D-1612	10.5	14.1	16.2	32	1.8	16	22	38	54				
70mm ²	M 10	3D-1637	12	16	10.4	22	2	18	18	36	47	3D-109		150	
	M 12	3D-1636	12	16	12.7	22	2	18	18	36	47				
	M 12	3D-1638	12	16	12.7	24	2	18	18	36	48				
	M 16	3D-1639	12	16	16.2	28	2	18	22	40	54				
95mm ²	M 10	3D-1651	13.5	18.1	10.2	22	2.3	20	15	35	46	3D-109		100	
	M 10	3D-1652	13.5	18.1	10.2	24	2.3	20	20	38	50				
	M 12	3D-1650	13.5	18.1	12.7	24	2.3	20	18	38	50				
	M 16	3D-1653	13.5	18.1	16.2	28	2.3	20	24	44	58				
120mm ²	M 12	3D-1658	15	20.2	12.7	26	2.6	22	17	39	52	3D-109		100	
	M 16	3D-1659	15	20.2	16.2	32	2.6	22	26	48	64				
	M 20	3D-1660	15	20.2	20.3	40	2.6	22	30	52	72				
150mm ²	M 12	3D-1668	16.5	23.7	12.7	34	3.6	24	25	49	66	3D-109		50	
	M 16	3D-1666	16.5	23.7	16.2	34	3.6	24	25	49	66				
	M 16	3D-1669	16.5	23.7	16.2	40	3.6	24	30	54	74				
	M 20	3D-1667	16.5	23.7	20.3	40	3.6	24	30	54	74				

SHEET METAL LUGS

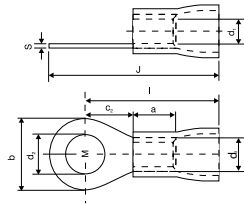
Ring Type, With Insulating Sleeve
 Material: ETP-Copper With PVC Sleeve
 Surface: Tin Plated





Conductors mm ²	Bolt 0	3D Cat No.	Dimension in mm									Tools	Crimping Profile	Packing Qty
			d ₁	d ₃	d ₂	b	s	a	C ₂	l	J			
0.5 To 1.5 mm ²	M 2	3D-3076	1.6	3.2	2.2	6	0.8	5	4	16	19	3D-41		200
	M 2.5	3D-3077	1.6	3.2	2.6	6	0.8	5	4	16	19			
	M 3	3D-3078	1.6	3.2	3.2	6	0.8	5	4	16	19			
	M 3	3D-3081	1.6	3.2	3.2	6.8	0.8	5	3.6	14.6	18			
	M 3	3D-3084	1.6	3.2	3.2	8	0.8	5	5	17	21			
	M 3.5	3D-3079	1.6	3.2	3.7	6	0.8	5	4	16	19			
	M 3.5	3D-3082	1.6	3.2	3.7	6.8	0.8	5	3.8	14.6	18			
	M 4	3D-3080	1.6	3.2	4.2	6	0.8	5	4	16	19			
	M 4	3D-3083	1.6	3.2	4.2	6.8	0.8	5	3.6	14.6	18			
	M 4	3D-3085	1.6	3.2	4.2	8	0.8	5	5	17	21			
	M 4	3D-3087	1.6	3.2	4.2	7.2	0.8	5	5	16	19.5			
	M 4	3D-3088	1.6	3.2	4.2	10	0.8	5	6	18	23			
	M 5	3D-3086	1.6	3.2	5.2	8	0.8	5	5	17	21			
	M 5	3D-3074	1.6	3.2	5.2	10	0.8	5	6	18	23			
	M 6	3D-3089	1.6	3.2	6.4	10	0.8	5	6	18	23			
M 6	3D-3090	1.6	3.2	6.4	12	0.8	5	6	17	23				
2.5 mm ²	M 3	3D-3126	2.3	3.9	3.2	6.5	0.8	5	3.5	14.5	17.7	3D-41		200
	M 3.5	3D-3127	2.3	3.9	3.7	6.5	0.8	5	3.5	14.5	17.7			
	M 3.5	3D-3128	2.3	3.9	3.7	8	0.8	5	5	17	21			
	M 4	3D-3129	2.3	3.9	4.2	8	0.8	5	5	17	21			
	M 5	3D-3130	2.3	3.9	5.2	8	0.8	5	5	17	21			
	M 5	3D-3131	2.3	3.9	5.2	10	0.8	5	7	18	23			
	M 5	3D-3133	2.3	3.9	5.2	12	0.8	5	9	21	27			
	M 6	3D-3132	2.3	3.9	6.4	10	0.8	5	7	18	23			
	M 6	3D-3134	2.3	3.9	6.4	12	0.8	5	9	21	27			
	M 6	3D-3136	2.3	3.9	6.4	16	0.8	5	10	22	30			
M 8	3D-3135	2.3	3.9	8.2	12	0.8	5	9	21	27				

SHEET METAL LUGS

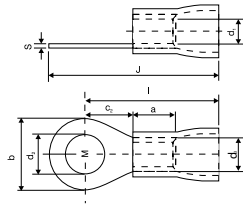
Ring Type, With Insulating Sleeve
 Material: ETP-Copper With PVC Sleeve
 Surface: Tin Plated





Conductors mm ²	Bolt Ø	3D Cat No.	Dimension in mm										Tools	Crimping Profile	Packing Qty
			d ₁	d ₂	d ₃	b	s	a	C ₂	l	J				
2.5 mm ²	M 8	3D-3137	2.3	3.9	8.2	16	0.8	5	10	22	30			200	
	M 10	3D-3138	2.3	3.9	10.2	16	0.8	5	10	22	30				
	M 10	3D-3139	2.3	3.9	10.2	18	0.8	5	14	25	34				
	M 12	3D-3140	2.3	3.9	12.7	18	0.8	5	14	25	34				
4 - 6 mm ²	M 4	3D-3196	3.5	5.5	4.2	8	1	6	5	21	25	3D-41		200	
	M 5	3D-3197	3.5	5.5	5.2	8	1	6	5	21	25				
	M 4	3D-3198	3.5	5.5	4.3	10	1	6	5	22	27				
	M 5	3D-3199	3.5	5.5	5.2	10	1	6	5	22	27				
	M 5	3D-3200	3.5	5.5	5.2	8	1	6	9.8	26	30				
	M 5	3D-3201	3.5	5.5	5.2	12	1	6	6	22	28				
	M 5	3D-3204	3.5	5.5	5.2	12	1	6	7	24	30				
	M 6	3D-3202	3.5	5.5	6.4	12	1	6	6	22	28				
	M 6	3D-3205	3.5	5.5	6.4	12	1	6	7	24	30				
	M 6	3D-3206	3.5	5.5	6.4	14	1	6	10.5	26.5	33.5				
	M 8	3D-3203	3.5	5.5	8.2	12	1	6	6	22	28				
	M 8	3D-3207	3.5	5.5	8.2	14	1	6	10.5	26.5	33.5				
	M 8	3D-3209	3.5	5.5	8.2	16	1	6	13	30	38				
	M 8	3D-3211	3.5	5.5	8.2	18	1	6	12	29	38				
	M 9	3D-3208	3.5	5.5	9.7	14	1	6	10.5	26.5	33.5				
	M 10	3D-3210	3.5	5.5	10.2	16	1	6	13	30	38				
M 10	3D-3212	3.5	5.5	10.2	18	1	6	12	29	38					
M 12	3D-3213	3.5	5.5	12.7	18	1	6	12	29	38					

SHEET METAL LUGS

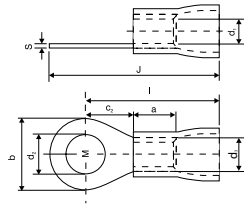
Ring Type Double Grip
 With Insulating Sleeve
 Material: ETP-Copper + PVC Sleeve
 Surface: Tin Plated



Conductors mm ²	Bolt 0	3D Cat No.	Dimension in mm									Tools	Crimping Profile	Packing Qty
			d ₁	b	d ₂	s	a	d ₃	C ₂	l	J			
0.5 To 1.5mm ²	M 2.5	3D-3337	1.6	6	2.6	0.8	5	3.2	4	16	19	3D-41		200
	M 3	3D-3338	1.6	6	3.2	0.8	5	3.2	4	16	19			
	M 3	3D-3341	1.6	6.8	3.2	0.8	5	3.2	3.6	14.6	18			
	M 3	3D-3344	1.6	8	3.2	0.8	5	3.2	5	17	21			
	M 3.5	3D-3366	1.6	7.2	3.7	0.8	5	3.2	4	17.4	21			
	M 3.5	3D-3339	1.6	6	3.7	0.8	5	3.2	4	16	19			
	M 3.5	3D-3342	1.6	6.8	3.7	0.8	5	3.2	3.8	14.6	18			
	M 4	3D-3340	1.6	6	4.2	0.8	5	3.2	4	16	19			
	M 4	3D-3343	1.6	6.8	4.2	0.8	5	3.2	3.6	14.6	18			
	M 4	3D-3345	1.6	8	4.2	0.8	5	3.2	5	17	21			
	M 4	3D-3347	1.6	7	4.2	0.8	5	3.2	5	16	19.5			
	M 4	3D-3348	1.6	10	4.2	0.8	5	3.2	6	18	23			
	M 5	3D-3346	1.6	8	5.2	0.8	5	3.2	5	17	21			
	M 5	3D-3349	1.6	10	5.2	0.8	5	3.2	6	18	23			
	M 6	3D-3350	1.6	10	6.4	0.8	5	3.2	6	18	23			
M 6	3D-3351	1.6	12	6.4	0.8	5	3.2	6	17	23				
2.5mm ²	M 3	3D-3382	2.3	6.5	3.2	0.8	5	3.9	3.5	14.5	17.8	3D-41		200
	M 3.5	3D-3383	2.3	6.5	3.7	0.8	5	3.9	3.5	14.5	17.7			
	M 3.5	3D-3384	2.3	8	3.7	0.8	5	3.9	5	17	21			
	M 4	3D-3385	2.3	8	4.2	0.8	5	3.9	5	17	21			
	M 5	3D-3386	2.3	8	5.2	0.8	5	3.9	5	17	21			
	M 5	3D-3387	2.3	10	5.2	0.8	5	3.9	7	18	23			
	M 5	3D-3389	2.3	12	5.2	0.8	5	3.9	9	21	27			
	M 6	3D-3388	2.3	10	6.4	0.8	5	3.9	7	18	23			
	M 6	3D-3390	2.3	12	6.4	0.8	5	3.9	9	21	27			
	M 6	3D-3392	2.3	16	6.4	0.8	5	3.9	10	22	30			
	M 8	3D-3391	2.3	12	8.2	0.8	5	3.9	9	21	27			
	M 8	3D-3393	2.3	16	8.2	0.8	5	3.9	10	22	30			
	M 10	3D-3394	2.3	16	10.2	0.8	5	3.9	10	22	30			
	M 10	3D-3395	2.3	18	10.2	0.8	5	3.9	14	25	34			
	M 12	3D-3396	2.3	18	12.7	0.8	5	3.9	14	25	34			

SHEET METAL LUGS

Ring Type Double Grip
With Insulating Sleeve
Material: ETP-Copper + PVC Sleeve
Surface: Tin Plated

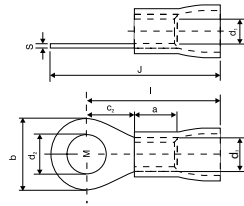





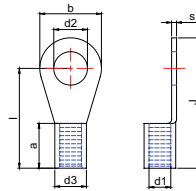

Conductors mm ²	Bolt Ø	3D Cat No.	Dimension in mm									Tools	Crimping Profile	Packing Qty
			d ₁	d ₂	d ₃	b	s	a	C ₂	l	J			
4 - 6mm ²	M 4	3D-3493	3.5	5.5	4.2	8	1	6	5	22	26	3D-41		200
	M 4	3D-3495	3.5	5.5	4.2	10	1	6	5	23	28			
	M 5	3D-3494	3.5	5.5	5.2	8	1	6	5	22	26			
	M 5	3D-3496	3.5	5.5	5.2	10	1	6	5	23	28			
	M 5	3D-3497	3.5	5.5	5.2	8	1	6	9.8	27.8	31.8			
	M 5	3D-3498	3.5	5.5	5.2	12	1	6	6	23	29			
	M 5	3D-3501	3.5	5.5	5.2	12	1	6	7	25	31			
	M 6	3D-3499	3.5	5.5	6.4	12	1	6	6	23	29			
	M 6	3D-3502	3.5	5.5	6.4	12	1	6	7	25	31			
	M 6	3D-3503	3.5	5.5	6.4	14	1	6	10.5	27.5	34.5			
	M 8	3D-3500	3.5	5.5	8.2	12	1	6	6	23	29			
	M 8	3D-3504	3.5	5.5	8.2	14	1	6	10.5	27.5	34.5			
	M 8	3D-3506	3.5	5.5	8.2	16	1	6	13	31	39			
	M 8	3D-3508	3.5	5.5	8.2	18	1	6	12	30	39			
	M 9	3D-3505	3.5	5.5	9.7	14	1	6	10.5	27.5	34.5			
	M 10	3D-3507	3.5	5.5	10.2	16	1	6	13	30	39			
M 10	3D-3509	3.5	5.5	10.2	18	1	6	12	30	39				
M 12	3D-3510	3.5	5.5	12.7	18	1	6	12	30	39				

SHEET METAL LUGS

Tailormade Ring Type,
 Brazed Seam
 Material: ETP-Copper
 Surface: Tin Plated





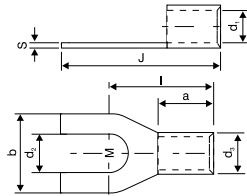

Conduc-tors mm ²	Bolt 0	3D Cat No.	Dimension in mm								Tools	Crimping Profile	Packing Qty
			d1	d3	d2	b	s	a	l	J			
4	5	3D-1368	3.1	5.5	5.2	10	1.2	6	14	19	3D-17		200
4	6	3D-1370	3.1	5.5	6.4	12	1.2	6	16	22	3D-2		200
4-6	8	3D-1421D DDI	3.6	6.2	8.2	16	1.3	8	28.5	36.5	3D-17		200
4-6	10	3D-1427D DDI	3.8	6.2	10.2	16	1.2	8	28.5	36.5	3D-2		200
70	16	3D-1639D BHE	11.5	15.5	16.2	32	2	28	54	70	3D-109		150
95	16	3D-1653D BHE	14	19	16.2	32	2.5	32	72	88	3D-109		100

SHEET METAL LUGS

Fork Type , Brazed Seam
Material: ETP-Copper
Surface: Tin Plated





Conductors mm ²	Bolt 0	3D Cat No.	Dimension in mm							Tools	Crimping Profile	Packing Qty	
			d ₁	b	d ₂	s	a	d ₃	l				J
0.5 To 1.5mm ²	M 2	3D-1709	1.6	4.6	2.3	0.8	5.0	3.2	10.6	13	3D-17 3D-2		200
	M 3	3D-1923	1.6	6.0	3.1	0.8	5.0	3.2	11.0	14			
	M 3.5	3D-1699	1.6	6.8	3.6	0.8	5.0	3.2	11.1	14.5			
	M 3.5	3D-1700	1.6	6.0	3.6	0.8	5.0	3.2	11.0	14			
	M 4	3D-1701	1.6	8.0	4.1	0.8	5.0	3.2	12.0	16			
	M 4	3D-1704	1.6	6.5	4.1	0.8	5.0	3.2	11.0	15			
	M 5	3D-1875	1.6	8.0	5.1	0.8	5.0	3.2	12.0	16			
	M 5	3D-1702	1.6	10.0	5.1	0.8	5.0	3.2	13.0	18			
M 5	3D-1698	1.6	8.0	5.1	0.8	5.0	3.2	17.0	21				
2.5mm ²	M 3	3D-1902	2.4	5.6	3.1	0.8	5.0	4	10.0	14	3D-17 3D-2		200
	M 3	3D-1889	2.3	6.0	3.1	0.8	5.0	3.9	11.0	14			
	M 3.5	3D-1890	2.3	6.0	3.6	0.8	5.0	3.9	11.0	14			
	M 3.5	3D-1884	2.3	6.5	3.6	0.8	5.0	3.9	11.8	15			
	M 4	3D-1898	2.3	6.5	4.1	0.8	5.0	3.9	11.8	15			
	M 4	3D-1891	2.3	8.0	4.1	0.8	5.0	3.9	12.0	16			
	M 5	3D-1892	2.3	10.0	5.1	0.8	5.0	3.9	14.0	19			
	M 5	3D-1903	2.6	10.6	5.0	1.0	6.2	4.6	15.7	21			
	M 6	3D-1896	2.3	10.0	6.5	0.8	5.0	3.9	14.0	19			
4mm ² To 6mm ²	M 3	3D-1906	3.5	6.0	3.1	1.0	6.0	5.5	11.5	15	3D-17 3D-2		200
	M 3.5	3D-1907	3.5	6.0	3.6	1.0	6.0	5.5	11.0	15			
	M 4	3D-1733	3.5	8.0	4.1	1.0	6.0	5.5	13.0	18.5			
	M 4	3D-1914	3.6	8.0	4.1	1.0	6.0	5.6	14.0	18			
	M 5	3D-1734	3.5	8.0	5.1	1.0	6.0	5.5	13.0	18.5			
	M 5	3D-1916	3.6	10.0	5.1	1.0	6.0	5.6	15.0	20			
	M 6	3D-1915	3.6	11.0	6.4	1.0	6.0	5.6	16.0	21.5			
10mm ²	M 6	3D-1917	4.5	16.0	6.5	1.2	8.0	6.9	19.0	27	3D-2		200
	M 8	3D-1918	4.5	16.0	8.2	1.2	8.0	6.9	19.0	27			
16mm	M 5	3D-1922	5.3	10.0	5.1	1.2	10.0	7.7	20.0	26	3D-2		200

SHEET METAL LUGS

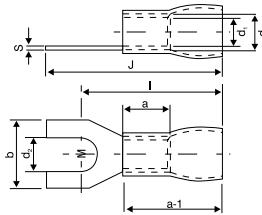
Fork Type with Insulating Sleeve
 Material: ETP-Copper With PVC Sleeve
 Surface: Tin Plated





Conductors mm ²	Bolt 0	3D Cat No.	Dimension in mm										Tools	Crimping Profile	Packing Qty
			d ₁	b	d ₂	s	a	a-1	d ₁	l	J				
0.5 To 1.5mm ²	M 2	3D-3695	1.6	4.6	2.3	0.8	5	11	3.2	15.2	18	3D-41		200	
	M 3	3D-3640	1.6	6	3.1	0.8	5	11	3.2	16	19				
	M 3.5	3D-3641	1.6	6	3.6	0.8	5	11	3.2	16	19				
	M 3.5	3D-3639	1.6	6.8	3.5	0.8	5	11	3.2	15	19				
	M 4	3D-3647	1.6	6.5	4.1	0.8	5	11	3.2	16	20				
	M 4	3D-3642	1.6	8	4.1	0.8	5	11	3.2	17	21				
	M 5	3D-3650	1.6	8	5.1	0.8	5	11	3.2	17	21				
	M 5	3D-3643	1.6	10	5.1	0.8	5	11	3.2	19	23				
	M 5	3D-3638	1.6	8	5.1	0.8	5	11	3.2	22	26				
2.5mm ²	M 3	3D-3671	2.4	5.6	3.1	0.8	5	11	4	15	19	3D-41		200	
	M 3	3D-3661	2.3	6	3.1	0.8	5	11	3.9	16	19				
	M 3.5	3D-3662	2.3	6	3.6	0.8	5	11	3.9	16	19				
	M 3.5	3D-3657	2.3	6.5	3.5	0.8	5	11	3.9	16.8	20				
	M 4	3D-3663	2.3	8	4.1	0.8	5	11	3.9	17	21				
	M 4	3D-3668	2.3	6.5	4.1	0.8	5	11	3.9	16.8	20				
	M 5	3D-3664	2.3	10	5.1	0.8	5	11	3.9	19	24				
	M 5	3D-3673	2.6	10.6	5.0	1	6.2	11	4.6	20	25				
	M 6	3D-3670	2.3	10	6.4	0.8	5	11	3.9	19	24				
4mm ² To 6mm ²	M 3	3D-3674	3.5	6	3.1	1	6	14	5.5	21	24	3D-41		200	
	M 3.5	3D-3675	3.5	6	3.5	1	6	14	5.5	21	24				
	M 4	3D-3679	3.6	8	4.1	1	6	14	5.6	23	27				
	M 4	3D-3720	3.5	8	4.1	1	6	11	5.5	21	25				
	M 5	3D-3721	3.5	8	5.1	1	6	11	5.5	21	25				
	M 5	3D-3681	3.6	10	5.1	1	6	14	5.6	24	29				
	M 6	3D-3680	3.6	11	6.4	1	6	14	5.6	25	30.5				

SHEET METAL LUGS

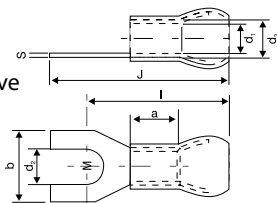
Fork Type Double Grip,
With Insulating Sleeve
Material: ETP-Copper With PVC Sleeve
Surface: Tin Plated





Conductors mm ²	Bolt 0	3D Cat No.	Dimension in mm									Tools	Crimping Profile	Packing Qty
			d1	d3	d2	b	s	a	l	J				
0.5 to 1.5mm ²	M 3.5	3D-3685	1.6	3.2	3.5	6.8	0.8	4	14.8	19	3D-41		200	
2.5mm ²	M 3.5	3D-3687	2.3	3.9	3.5	6.5	0.8	5	16.8	20	3D-41		200	
4mm ² to 6mm ²	M 3	3D-3689	3.5	5.5	3.1	6	1	6	20.5	24	3D-41		200	
	M 3.5	3D-3690	3.5	5.5	3.5	6	1	6	20	24				

SHEET METAL LUGS

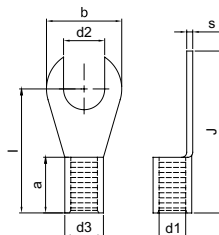
Tailormade Fork Type
With Brazed Seam
Material: ETP-Copper
Surface: Tin Plated





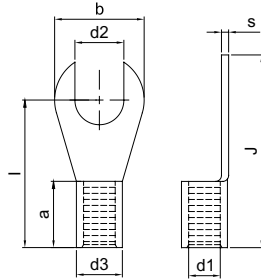

Conductors mm ²	Bolt 0	3D Cat No.	Dimension in mm									Tools	Crimping Profile	Packing Qty
			d1	d3	d2	b	s	a	l	J				
1.5	M 3	3D-1672	1.60	3.20	3.10	6.00	0.80	5.00	11.00	14.00	3D-17		200	
	M 4	3D-1673	1.60	3.20	4.10	8.00	0.80	5.00	12.00	16.00	3D-2			
	M 4	3D-1674	1.60	3.20	4.10	7.00	0.80	5.00	11.00	14.50				
	M 5	3D-1675	1.60	3.20	5.10	10.00	0.80	5.00	13.00	18.00				
	M 3.5	3D-1676	1.60	3.20	3.60	6.00	0.80	5.00	11.00	14.00				
	M 3.5	3D-1678	1.60	3.20	3.60	6.80	0.80	5.00	9.60	13.00				
	M 6	3D-1679	1.60	3.20	6.10	10.00	0.80	5.00	13.00	18.00				
2.5	M 4	3D-1680	2.30	3.90	4.10	8.00	0.80	5.00	12.00	16.00	3D-17		200	
	M 5	3D-1681	2.30	3.90	5.10	10.00	0.80	5.00	13.00	18.00	3D-2			
	M 3	3D-1682	2.30	3.90	3.10	6.50	0.80	5.00	9.50	12.70				
	M 3.5	3D-1683	2.30	3.90	3.60	6.50	0.80	5.00	9.50	12.20				

SHEET METAL LUGS

Tailormade Fork Type
 With Brazed Seam
 Material: ETP-Copper
 Surface: Tin Plated



Conductors mm ²	Bolt Ø	3D Cat No.	Dimension in mm								Tools	Crimping Profile	Packing Qty
			d1	d3	d2	b	s	a	l	J			
4-6	M 4	3D-1685	3.50	5.50	4.10	8.00	1.00	6.00	13.00	17.00	3D-17		200
	M 5	3D-1688	3.50	5.50	5.10	12.00	1.00	6.00	16.00	22.00	3D-2		200
10	M 4	3D-1690	4.30	6.30	4.10	10.00	1.00	8.00	17.00	22.00	3D-2		200
	M 6	3D-1692	4.30	6.30	6.10	12.00	1.00	8.00	17.00	23.00			
	M 8	3D-1693	4.30	6.30	8.20	16.00	1.00	8.00	19.00	27.00			
16	M 5	3D-1694	5.60	8.00	5.10	10.00	1.20	10.00	19.00	24.00	3D-2		200
	M 6	3D-1695	5.60	8.00	6.10	12.00	1.20	10.00	20.00	26.00			
	M 8	3D-1696	5.60	8.00	8.10	16.00	1.20	10.00	22.00	30.00			
	M 8	3D-1697	5.60	8.00	8.10	18.00	1.20	10.00	24.00	33.00			





SHEET METAL LUGS

Fork Type With hook Brazed Seam

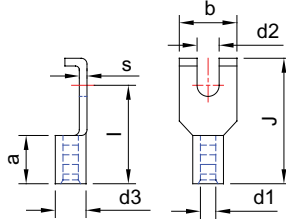
Material: ETP-Copper

Surface: Tin Plated



Conductors mm ²	Bolt 0	3D Cat No.	Dimension in mm								Tools	Crimping Profile	Packing Qty
			d1	d3	d2	b	s	a	l	j			
0.75	M 2	3D-1707	0.90	1.90	2.30	4.60	0.50	3.00	8.00	11.00	3D-17		200
1.5	M 5	3D-1708	1.60	3.20	5.20	8.00	0.80	5.00	12.00	17.00	3D-17		200
	M 2	3D-1709	1.60	3.20	2.30	4.60	0.80	5.00	-	13.00	3D-2		
	M 6	3D-1710	1.60	3.20	6.30	12.00	0.80	5.00	13.00	19.00			
	M 8	3D-1711	1.60	3.20	8.10	12.00	0.80	5.00	13.00	19.00			
	M 2	3D-1712	1.30	3.20	2.30	6.00	0.80	5.00	10.20	13.00			
	M 4	3D-1713	1.70	3.30	4.20	7.50	0.80	5.00	9.40	15.00			
	M 3	3D-1714	1.80	3.20	3.60	6.50	0.70	5.00	10.00	15.00			
	M 3	3D-1717	1.60	3.20	3.70	6.80	0.80	5.00	10.00	15.00			
2.5	M 4	3D-1718	2.30	3.90	4.20	7.70	0.80	5.00	10.00	16.00	3D-17		200
	M 5	3D-1719	2.30	3.90	5.20	10.00	0.80	5.00	12.00	18.00	3D-2		
	M 6	3D-1720	2.30	3.90	6.30	12.00	0.80	5.00	13.00	19.00			
	M 8	3D-1721	2.30	3.90	8.10	12.00	0.80	5.00	13.00	19.00			
	M 4	3D-1722	2.30	3.90	4.10	8.00	0.80	5.00	13.00	17.00			
4	M 4	3D-1726	3.10	5.50	4.10	10.00	1.20	6.00	14.00	20.00	3D-17		200
	M 5	3D-1727	3.10	5.50	5.10	10.00	1.20	6.00	14.00	20.00	3D-2		
	M 8	3D-1729	3.10	5.50	8.10	12.00	1.20	6.00	14.00	20.00			
4-6	M 5	3D-1731	3.50	5.50	5.20	10.00	1.00	6.00	14.00	20.00	3D-17		200
	M 5	3D-1732	3.50	5.50	5.20	12.00	1.00	6.00	14.00	20.00	3D-2		

SHEET METAL LUGS

Tailormade Fork Type
 Type-I Brazed Seam
 Type-II With Insulating Sleeve
 Material: ETP-Copper
 Surface: Tin Plated

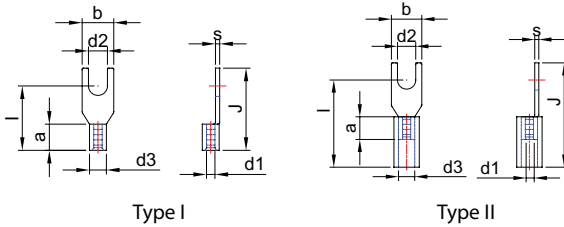

Conductor mm ²	Bolt Ø	3D CAT NO	Dimensions in mm								TYPE
			d1	d3	d2	b	s	a	l	J	
1.5	3.5	3D-1700 RCF	1.6	3.2	3.6	6	0.8	5	12.3	15.7	I
1.5	3.5	3D-3641 RCF	1.6	3.2	3.6	6	0.8	5	17.8	21.2	II

SHEET METAL LUGS

Chain Form Fork Type
 Material: ETP-Copper
 Surface: Tin Plated

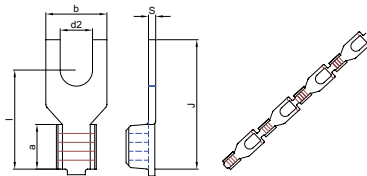



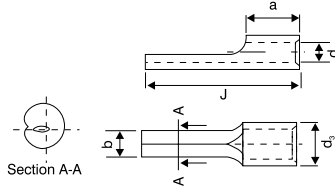

Conductor mm ²	Bolt Ø	3D CAT NO	Dimensions in mm					
			d2	b	s	a	l	J
1.5	3.5	3D-1700-1	3.6	6	0.8	5	11.1	14.5
2.5	3.5	3D-1884-1	3.6	6.5	0.8	5	11.8	15

SHEET METAL LUGS

Round Pin Type,
Brazen Seam
Material: ETP-Copper
Surface: Tin Plated









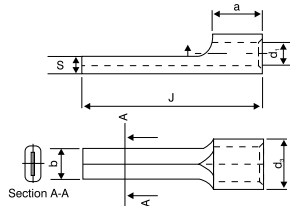

Conductors mm ²	3D Cat No.	Dimension in mm					Tools	Crimping Profile	Packing Qty
		d ₁	d ₃	b	a	J			
0.5 To 1.5mm ²	3D-1012	1.6	3.2	1.9	5	17	3D-17		200
	3D-1015	1.6	3.2	1.9	5	14	3D-2		
	3D-1019	1.8	3.2	1.9	5	17			
2.5mm ²	3D-1020	2.4	4	1.7	4.2	14.4	3D-17		200
	3D-1021	2.3	3.9	1.9	5	17	3D-2		
	3D-1023	2.3	3.9	1.9	5	21			
4mm ²	3D-1028	2.8	4.5	1.7	4.2	14.4	3D-17		200
	3D-1030	2.9	4.9	2.7	6	20	3D-2		
6mm ²	3D-1037	3.6	5.6	2.6	6.4	20.4	3D-17		200
	3D-1036	3.6	5.6	2.7	6	20	3D-2		
	3D-1039	4	6	2.7	6	20			

SHEET METAL LUGS

Rectangular Pin Type,
Brazen Seam,
Material : ETP-Copper
Surface : Tin Plated





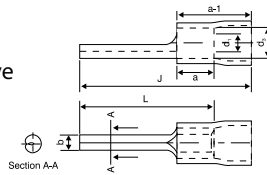

Conductors mm ²	3D Cat No.	Dimension in mm						Tools	Crimping Profile	Packing Qty
		d ₁	d ₃	b	s	a	J			
10mm ²	3D-1041	4.3	6.7	4.3	2.4	8	22	3D-17		200
16mm ²	3D-1042	5.3	7.3	2.7	2	10	25	3D-17		200
16mm ²	3D-1043	5.8	8.2	5.5	2.4	10	26.0	3D-17		200
25mm ²	3D-1044	7.5	11.1	7.0	3.6	11	31.0	3D-109		200
35mm ²	3D-1045	9.0	12.6	8.0	3.6	12	37.0	3D-109		400
50mm ²	3D-1046	10.5	14.1	9.0	3.6	16	42.0	3D-109		200
70mm ²	3D-1047	12.0	16.0	10.0	4	18	45.0	3D-109		100
95mm ²	3D-1048	13.5	18.5	12.5	5	24	55.0	3D-109		25

SHEET METAL LUGS

Round Pin Type,
With Insulating Sleeve
Material: ETP-Copper With PVC Sleeve
Surface: Tin Plated



Conductors mm ²	3D Cat No.	Dimension in mm						Tools	Crimping Profile	Packing Qty
		d ₁	d ₃	b	a	a-1	J			
0.5 To 1.5mm ²	3D-3008	1.6	3.2	1.9	5	11	22	3D-41		200
	3D-3013	1.6	3.2	1.9	5	11	19			
	3D-3020	1.8	3.8	1.9	5	11	22			
2.5mm ²	3D-3022	2.3	3.9	1.9	5	11	22	3D-41		200
4mm ²	3D-3026	2.9	4.9	2.7	6	14	28	3D-41		200
6mm ²	3D-3030	3.6	5.6	2.7	6	14	28	3D-41		200

SHEET METAL LUGS

Round Pin Type
Double Grip, with Insulating Sleeve
Material: ETP-Copper with PVC Sleeve
Surface: Tin Plated

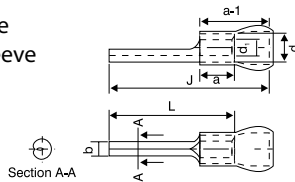

Conductors mm ²	3D Cat No.	Dimension in mm									Tools	Crimping Profile	Packing Qty
		d ₁	d ₃	b	s	a	a-1	J	L				
0.5 to 1.5mm ²	3D-3040	1.6	3.2	1.9	0.8	5	11	22	17	3D-41		200	
2.5mm ²	3D-3043	2.3	3.9	1.9	0.8	5	11	22	17	3D-41		200	
4mm ²	3D-3046	2.9	4.9	2.7	1	6	14	29	20	3D-41		200	

SHEET METAL LUGS

Tailormade Round Pin Type
 Material: ETP-Copper
 Surface: Tin Plated

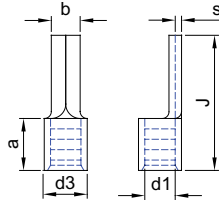

Conductors mm ²	3D Cat No.	Dimension in mm						Tools	Crimping Profile	Packing Qty
		d1	d3	b	s	a	J			
1	3D-1010B	1.2	2.8	1.8	0.8	4	16	3D-17		200

SHEET METAL LUGS

Tailormade Rectangular Pin Type
 with Insulating Sleeve
 Material: ETP-Copper With PVC Sleeve
 Surface: Tin Plated

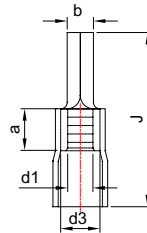



Conductors mm ²	3D Cat No.	Dimension in mm						Packing Qty
		d1	d3	b	s	a	J	
10	3D-3033	4.3	6.7	4.3	1.2	8	30	200
16	3D-3034	5.8	8.2	5.5	1.2	10	36	200

SHEET METAL LUGS

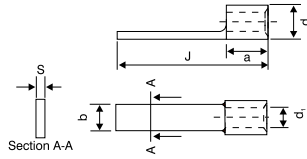
Flat Pin Type, Brazed Seam
 Material: ETP-Copper
 Surface: Tin Plated





Conductors mm ²	3D Cat No.	Dimension in mm						Tools	Crimping Profile	Packing Qty
		d ₁	d ₂	b	s	a	J			
0.5 to 1.5mm ²	3D-1011	1.6	3.2	3.1	0.8	5	17	3D-17		200
	3D-1013	1.6	3.2	2.3	0.8	5	15.5	3D-2		
	3D-1014	1.6	3.2	2.3	0.8	5	23.5			
2.5mm ²	3D-1022	2.3	3.9	3.1	0.8	5	17	3D-17		200
	3D-1027	2.4	4	3.1	0.8	4.2	14.4	3D-2		
	3D-1024	2.3	3.9	2.3	0.8	5	23.5			
	3D-1025	2.3	3.9	2.8	0.8	5	14			
	3D-1029	2.8	4.4	3.1	0.8	4.2	14.4			
4mm ² To 6mm ²	3D-1032	3.6	5.6	5.1	1	6	20	3D-17		200
	3D-1035	3.4	5.5	5.1	1	6.35	20.6	3D-2		
	3D-1038	3.6	5.6	2.8	1	6	16			

SHEET METAL LUGS

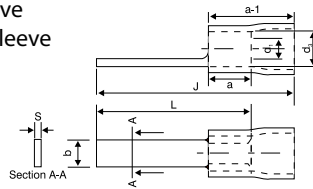
Flat Pin Type with Insulating Sleeve
 Material: ETP-Copper with PVC Sleeve
 Surface: Tin Plated



Conductors mm ²	3D Cat No.	Dimension in mm								Tools	Crimping Profile	Packing Qty
		d ₁	d ₂	b	s	a	a-1	J	L			
0.5mm ² To 1.5mm ²	3D-3009	1.6	3.2	3.1	0.8	5	11	22	17	3D-41		200
	3D-3011	1.6	3.2	2.3	0.8	5	11	20.5	15.5			
	3D-3012	1.6	3.2	2.3	0.8	5	11	28.5	23.5			
2.5mm ²	3D-3023	2.3	3.9	3.1	0.8	5	11	22	17	3D-41		200
	3D-3025	2.3	3.9	2.3	0.8	5	11	28.5	23.5			
4mm ² to 6mm ²	3D-3027	3.6	5.6	5.1	1	6	14	36	20	3D-41		200

SHEET METAL LUGS

Flat Pin Type Double grip
with insulating sleeve
Material: ETP-Copper With PVC Sleeve
Surface: Tin Plated

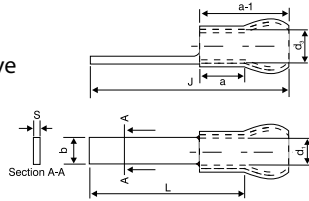



Conductors mm ²	3D Cat No.	Dimension in mm									Tools	Crimping Profile	Packing Qty
		d ₁	d ₂	b	s	a	a-1	J	L				
2.5	3D-3044	2.3	3.9	3.1	0.8	5	11	22	17	3D-41		200	

SHEET METAL LUGS

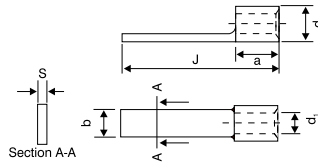
Tailormade Flat Pin Type
Material: ETP-Copper
Surface: Tin Plated



Conductors mm ²	3D Cat No.	Dimension in mm						Tools	Crimping Profile	Packing Qty
		d ₁	d ₂	b	s	a	J			
1	3D-1010	1.2	2.8	3.1	0.8	4	16	3D-17		200
2.5	3D-1024	2.6	4	2.5	0.7	5.1	25.2	3D-17 & 3D-2		200

SHEET METAL LUGS

Tailormade Flat Pin Type
with Insulating Sleeve
Material: ETP-Copper with PVC Sleeve
Surface: Tin Plated

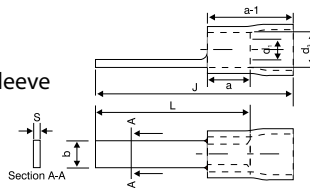

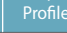
Conductors mm ²	3D Cat No.	Dimension in mm								Tools	Crimping Profile	Packing Qty
		d ₁	d ₂	b	s	a	a-1	J	L			
1.5	3D-3012S DG	1.6	3.2	2.3	0.8	5	11	23.5	18.5	3D-41		200