

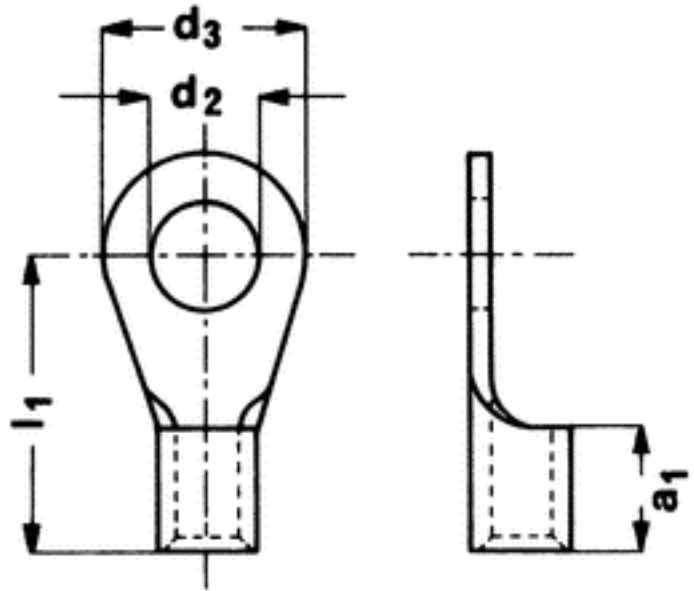

Characteristics and dimensions of terminals

Part number	03417.311.011
Specification	Cable lug ring type
Material	SE-Cu
Surface / Colour	Sn 3
Form	Single form
Single part	X
Packing unit / piece	750
Section area (mm ²)	6.00-10.00
DIN	46234
Nominal size	8-10
Material thickness (mm)	1.10
Footnote	Type test according to VG 96933-13
a ₁	8.00
d ₂	8.40
d ₃	14.00
l ₁	20.00



Note: The drawing only gives an overview of the geometry of the part. The crimp area is shown as supplied in strip form. A technical drawing is available on request.

[Contents of your inquiry](#)

Packing Units (per 750 pieces)

CW