

# Current Transformers Low Current Type

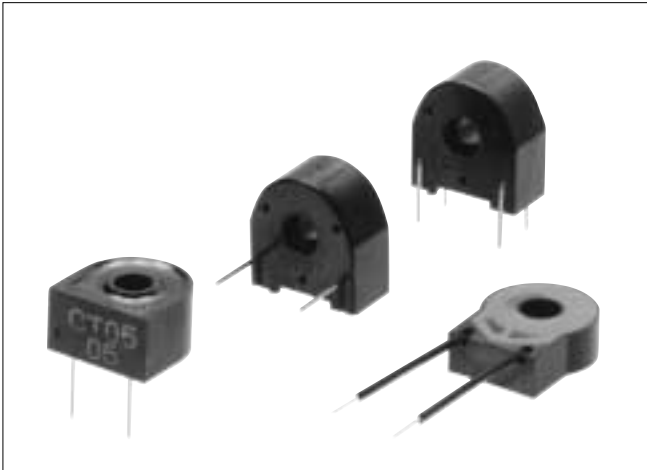

## Outline

This series of compact current transformers (current sensors) can be used for detecting very low current levels and overcurrent protection in electronic appliances.

## Features

- High sensitivity (detection of low current) and high performance.
- Compact, lightweight.
- Mountable on printed circuit boards.

## Applications

- Overcurrent detection in microcomputer-controlled equipment.
- Current detection in electric refrigerators, air conditioners and electromagnetic cookers.

## Specifications

Product name	CT-05	CT-06	CT-07
Core	Permalloy (TMB)	Permalloy (TMH)	Permalloy (TMB)
Lead wires	Pin connectors, annealed copper wire $\phi 0.6$ mm	Polyethylene sheath $\phi 0.5$ mm single wire	Pin connectors, solder-plated hard-drawn copper wire $\phi 0.8$ mm
Materials	Phenolic resin case, epoxy-filled	Phenolic resin case, silicon-filled	Phenolic resin case, epoxy-filled

Notes: (1) In the standard lineup there are three types of CT-06, depending on differences in secondary windings.

(2) The CT-05 has 500T as standard.

## Shape and Dimensions

### ● CT-05

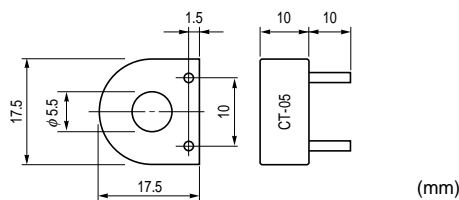

### ● CT-06

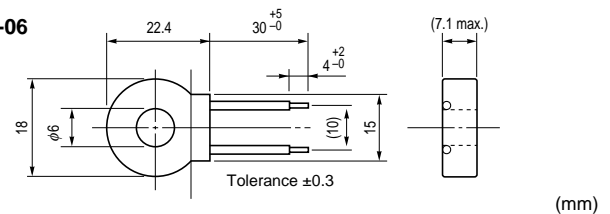

### ● CT-07V (vertical type)

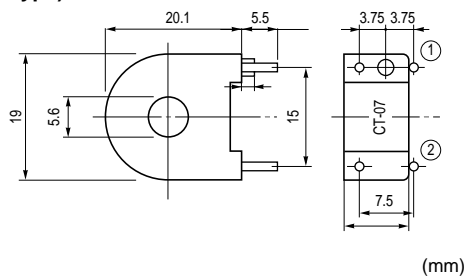

### ● CT-07H (horizontal type)

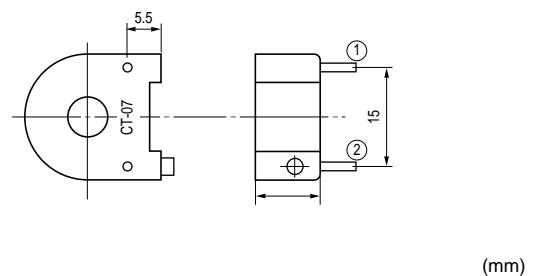

Output Characteristics

• CT-05 AC output characteristics (example)

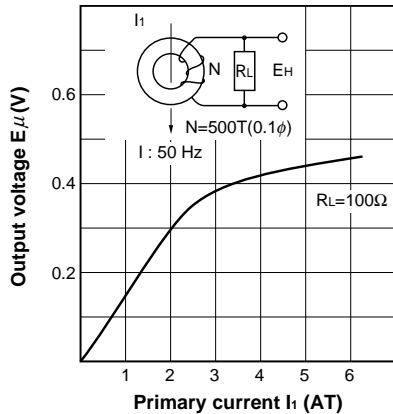

• CT-06 AC output characteristics (example)

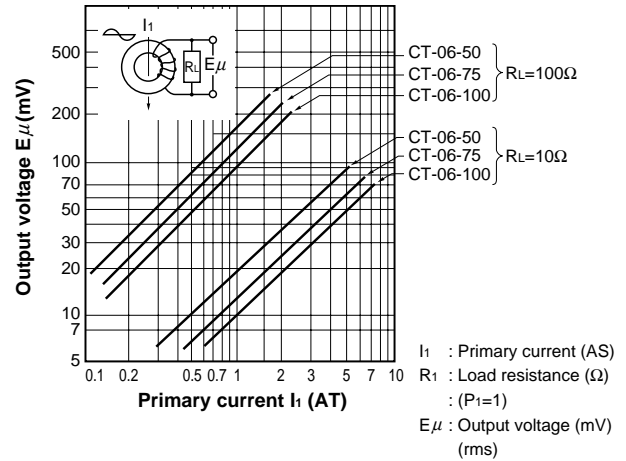

• CT-07 AC output characteristics (example)

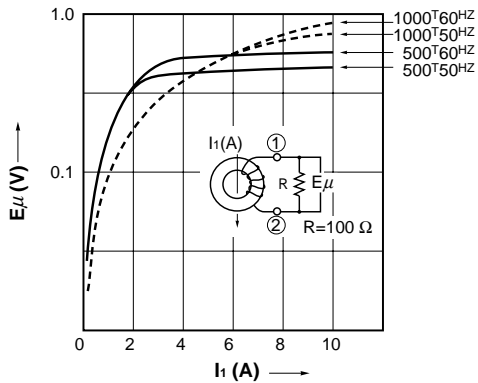

Markings

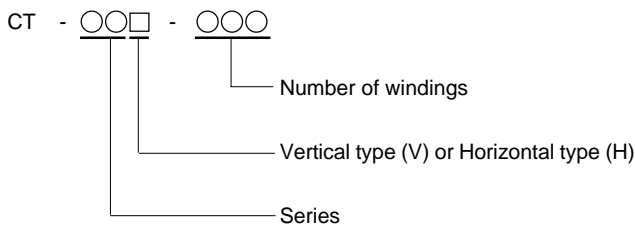

**Before Using Current Transformers Low Current Type**

- The core may be damaged if applied with a strong impact. Carefully avoid dropping or applying any other strong impacts.
- Preliminary study is needed with regard to heating by current conduction.