

INTRODUCTION:

Adam Tech ASJ Series Stereo Jacks are a broad range of 2.6mm and 3.5mm jacks used primarily in computer and multi-media audio applications. This series provides a multitude of sizes and configurations that are available in single or multiple switching forms. Options include choice of full plastic or metal reinforced bodies, single, stacked or ganged versions and color-coded jacks for port identification.

FEATURES:

- Broad range of sizes and configurations
- Single or Multiple switching functions
- Plastic or Metal reinforced bodies
- Ganged and Stacked versions
- Color Coded option for Port Identification

MATING PLUGS:

All industry standard 2.50mm and 3.50mm mono or stereo plugs.

SPECIFICATIONS:

Material:

Standard insulator: PBT or LCP, Glass reinforced, rated UL94V-0
 Optional Hi-Temp insulator: Nylon 6T, rated UL94V-0
 Insulator Color: Black
 Bushing: Brass, Nickel plated
 Contacts: Copper alloy

Contact Plating:

Tin over Copper underplate

Electrical:

Operating voltage: 12V DC max.
 Current rating: 1 Amp max.
 Contact resistance: 30 mΩ max. initial
 Insulation resistance: 100 MΩ min.
 Dielectric withstanding voltage: 500V AC for 1 minute

Mechanical:

Insertion force: 4.4 lbs max.
 Withdrawal force: 0.3 kg min
 Mating durability: 5000 cycles min.

Temperature Rating:

Operating temperature: -25°C to +85°C
 Soldering process temperature:
 Standard insulator: 235°C
 Hi-Temp insulator: 260°C

PACKAGING:

Anti-ESD plastic bags or Tape and Reel

APPROVALS AND CERTIFICATIONS:

UL Recognized & CSA Certified, File no. E224053

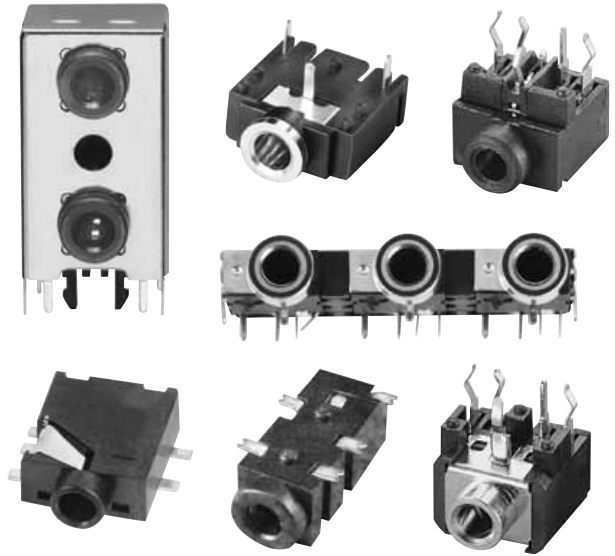

ORDERING INFORMATION

ASJ

SERIES INDICATOR
 ASJ = Stereo Jack

1

JACK TYPE

1, 5, 6, 7, 12, 15, 18, 37, 38, 40, 41, 103, 104, 105, 106, 107, 108, 109, 110, 111, 112, 113
 (see page 209-214)

3

CONTACT FORMS
 (see page 207-209 for individual schematics)



OPTIONS:

Add designator(s) to end of part number

E = No back cover (Type 1 only)

M = M6 x 0.5 threaded bushing

HT = Hi-Temp Nylon 6T insulator for Hi-Temp soldering processes up to 260°C

TR = Tape & Reel packaging

ASJ-1

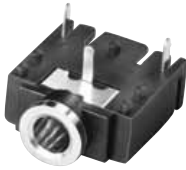

ASJ-1-3

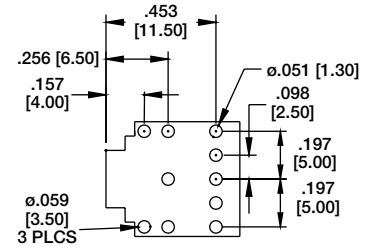
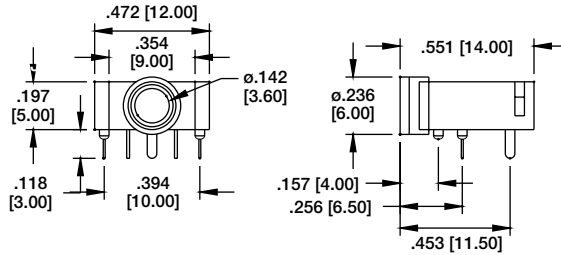

Recommended PCB Layout

ASJ-5



ASJ-5-4A

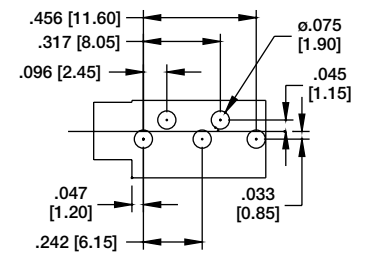
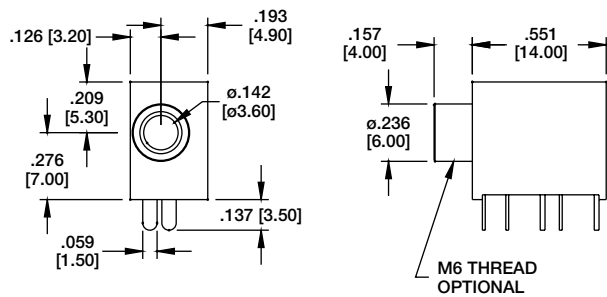

Recommended PCB Layout

ASJ-37



ASJ-37-5-M

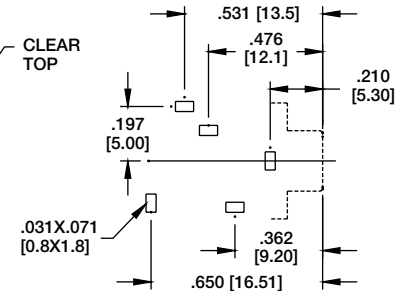
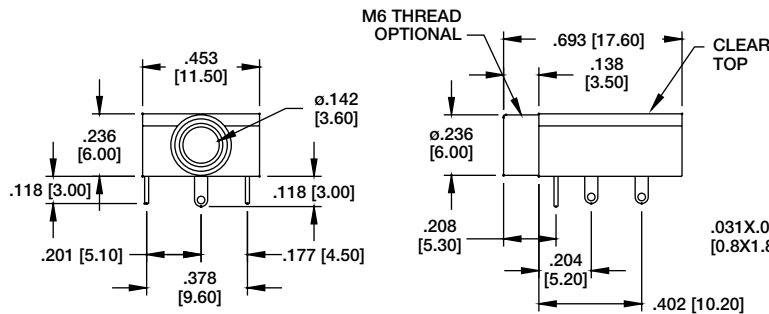

Recommended PCB Layout

ASJ-6



ASJ-6-5

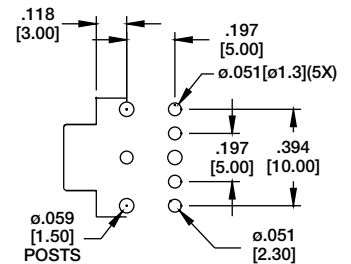
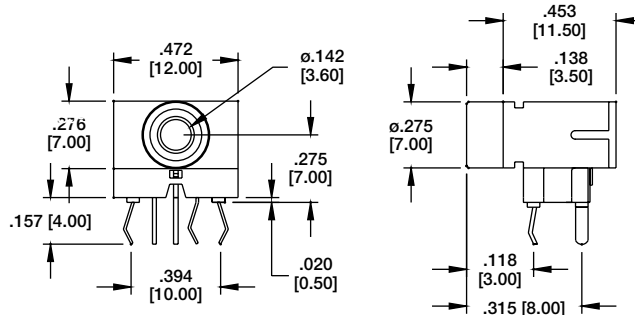

Recommended PCB Layout

CONTACT FORM	FORM 2	FORM 3	FORM 3A	FORM 4A	FORM 4B	FORM 5
SCHEMATIC						

ASJ-7



ASJ-7-5

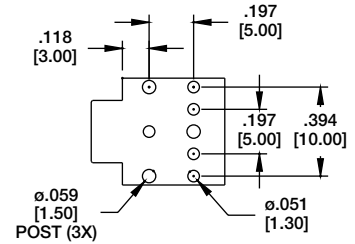
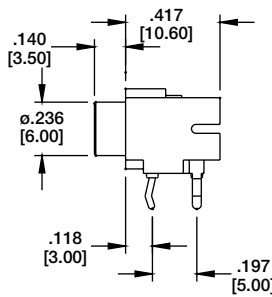
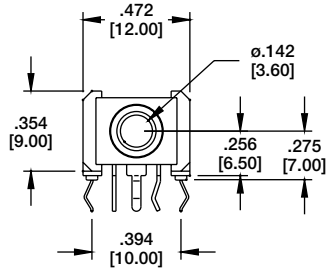

Recommended PCB Layout

ASJ-40

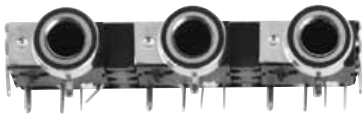

ASJ-40-4A

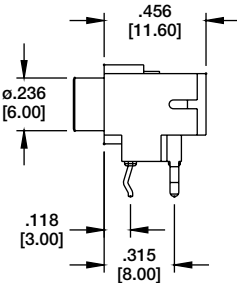
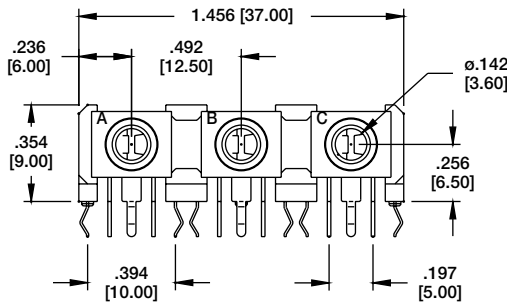

Recommended PCB Layout

ASJ-15



ASJ-15-4B

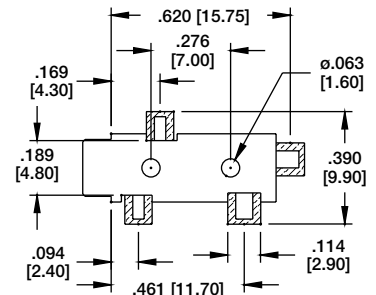
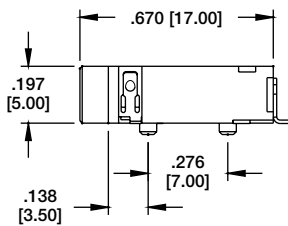
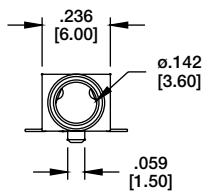

Recommended PCB Layout

ASJ-41



ASJ-41-5

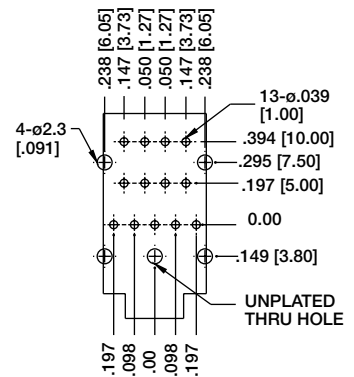
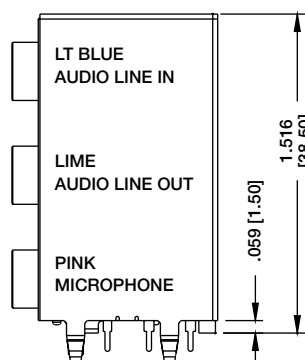
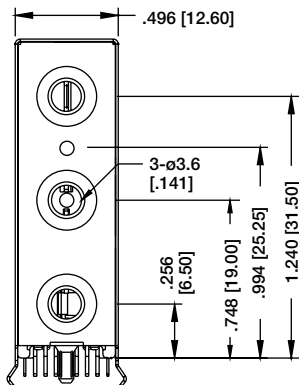

Recommended PCB Layout

ASJ-12



ASJ-12-5

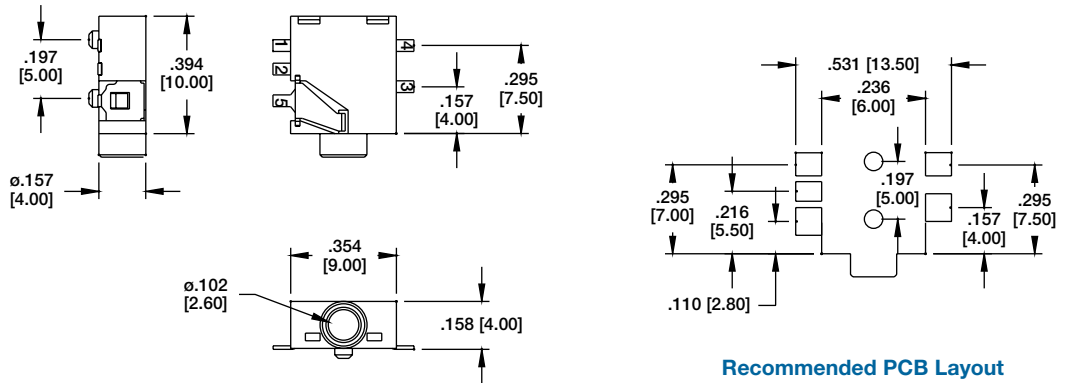

Recommended PCB Layout

ASJ-18



ASJ-18-4B

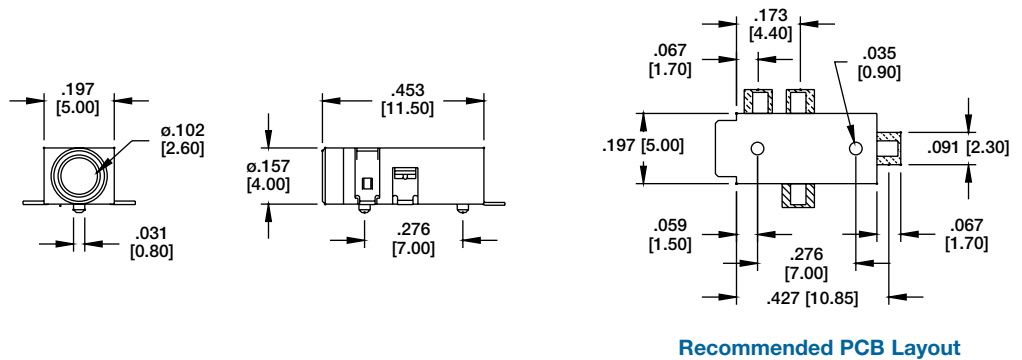

Recommended PCB Layout

ASJ-38



ASJ-38-5

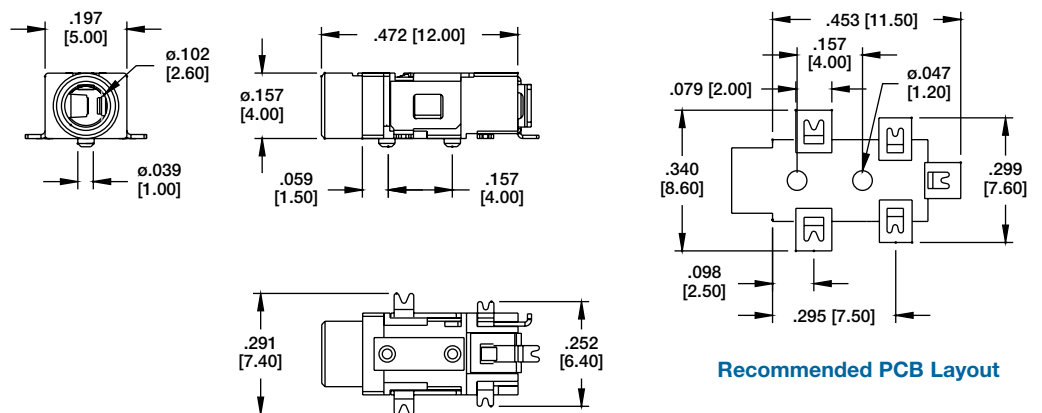

Recommended PCB Layout

ASJ-103

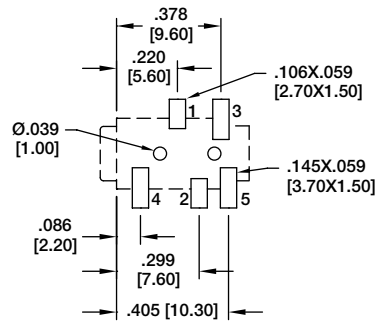
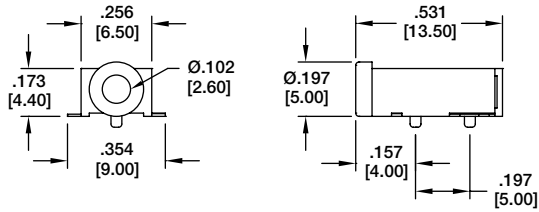

Recommended PCB Layout



ASJ-103-J

ASJ-103-J	ASJ-103-M

ASJ-104

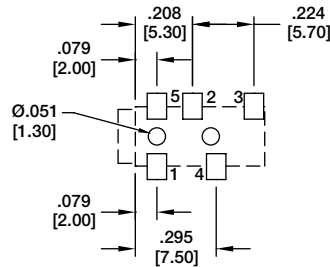
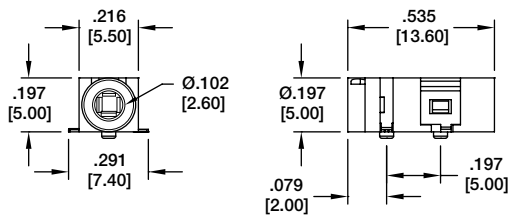

Recommended PCB Layout



ASJ-104-J

ASJ-104-J

ASJ-105

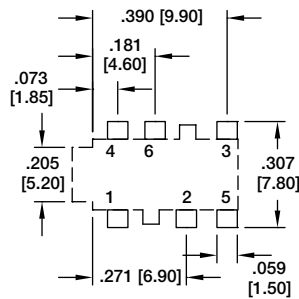
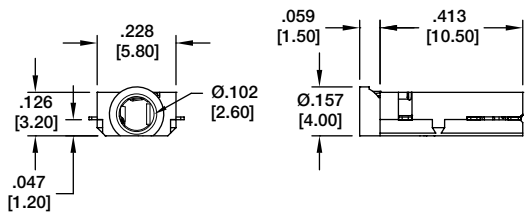

Recommended PCB Layout



ASJ-105-A

ASJ-105-A	ASJ-105-B	
ASJ-105-D	ASJ-105-M	ASJ-105-I

ASJ-106

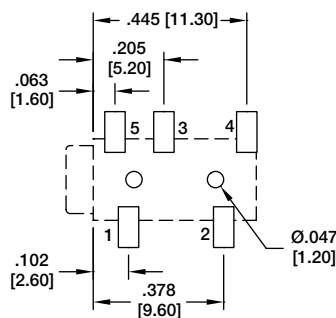
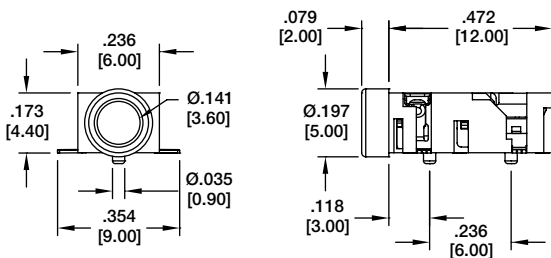

Recommended PCB Layout



ASJ-106-C

ASJ-106-C	ASJ-106-D	
ASJ-106-K	ASJ-106-P	ASJ-106-B

ASJ-107

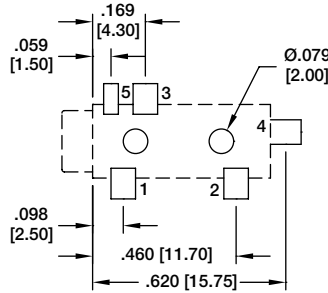
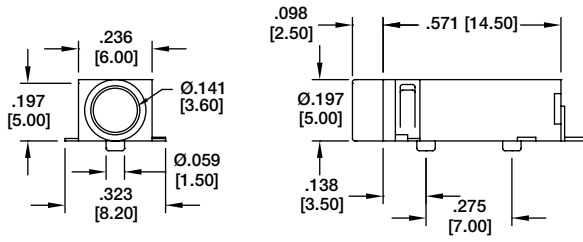

ASJ-107-B

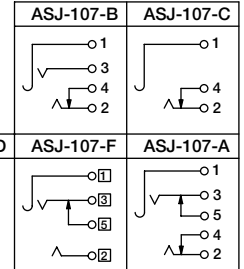

Recommended PCB Layout

ASJ-108

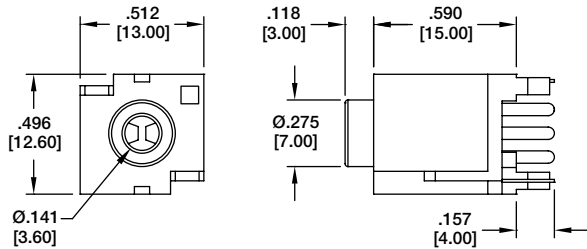

ASJ-108-A

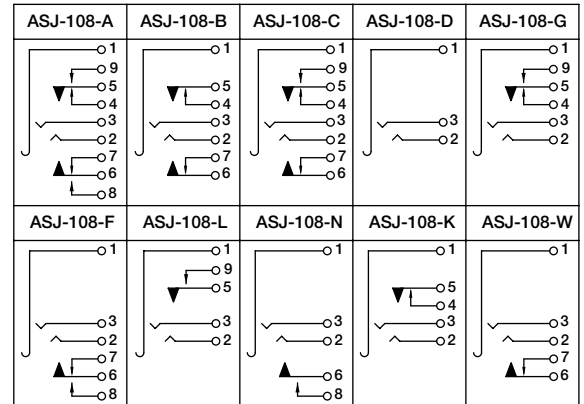

ASJ-109

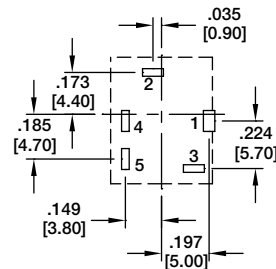
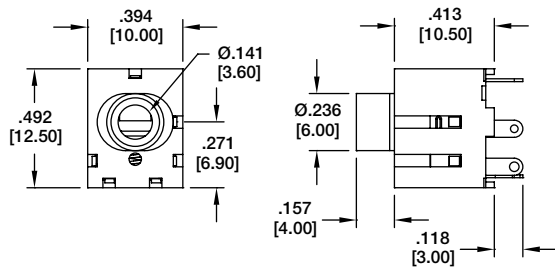

ASJ-109-A

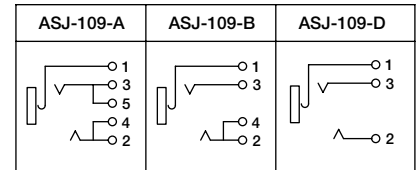

Recommended PCB Layout

ASJ-110

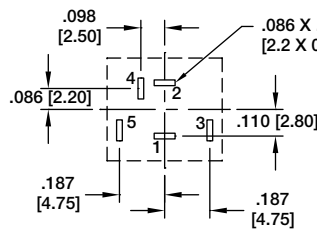
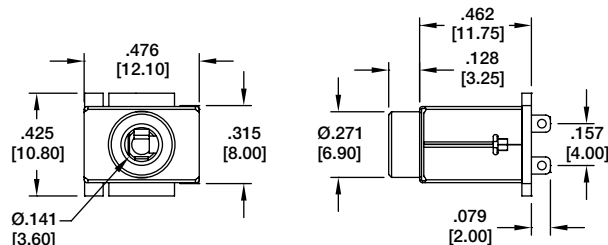

ASJ-110-A

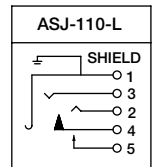

Recommended PCB Layout

ASJ-111

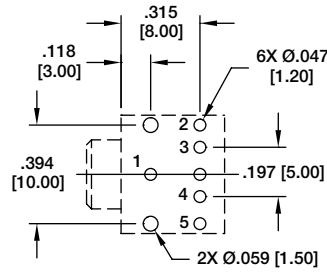
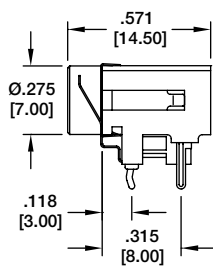
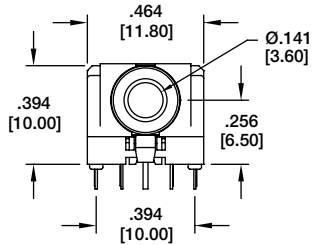

Recommended PCB Layout



ASJ-111-1

ASJ-111-1	ASJ-111-1A

ASJ-112



ASJ-112-J

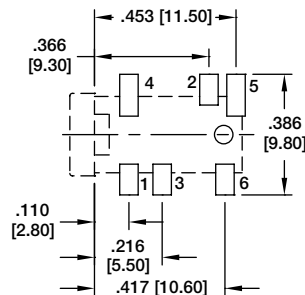
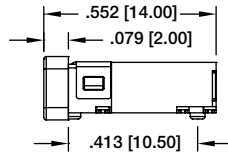
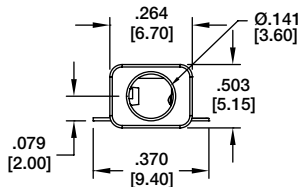

Recommended PCB Layout

ASJ-112-I	ASJ-112-J	ASJ-112-M
ASJ-112-A	ASJ-112-B	ASJ-112-D

ASJ-113



ASJ-113-B

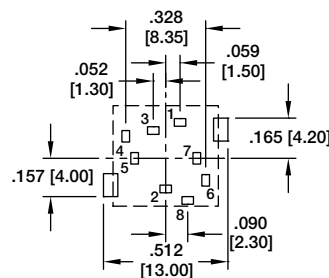
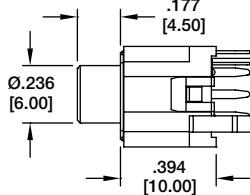
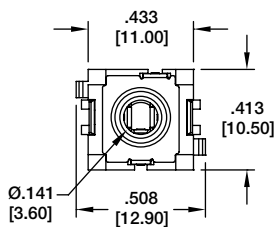

Recommended PCB Layout

ASJ-113-B	ASJ-113-D
ASJ-113-K	ASJ-113-W

MONO AUDIO PLUG

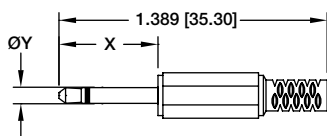

DIMENSION	X	Y
ASP-2.5-M	.468 [11.90]	Ø.098 [2.50]
ASP-3.5-M	.590 [15.00]	Ø.137 [3.50]

STEREO AUDIO PLUG 2 CHANNEL

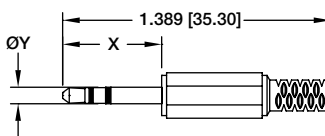

DIMENSION	X	Y
ASP-2.5-S	.468 [11.90]	Ø.098 [2.50]
ASP-3.5-S	.590 [15.00]	Ø.137 [3.50]

STEREO AUDIO PLUG 3 CHANNEL

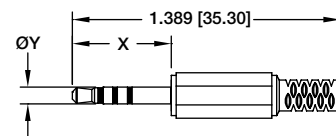

DIMENSION	X	Y
ASP-2.5-S3	.468 [11.90]	Ø.098 [2.50]
ASP-3.5-S3	.590 [15.00]	Ø.137 [3.50]