

## Single hole mounting 22 mm ▶ 2- und 3-pole, IP 66, IP 69k



Similar image



Thermal current (Iu/Ith)	Rating AC-23B (A)	Face plate	Order number
<b>2-pole</b>			
<b>230 V</b>			
20 A	1,5 kW	48 x 48	KG10A.T202/04.FT2
		64 x 64	KG10B.T202/04.FT2
<b>3-pole</b>			
<b>3 x 400 V</b>			
20 A	5,5 kW	48 x 48	KG10A.T203/04.FT2
		64 x 64	KG10B.T203/04.FT2
25 A	7,5 kW	48 x 48	KG20A.T203/04.FT2
		64 x 64	KG20B.T203/04.FT2
32 A	11 kW	48 x 48	KG32A.T203/04.FT2
		64 x 64	KG32B.T203/04.FT2

Thermal current (Iu/Ith)	Rating AC-23B (A)	Face plate	Order number
<b>2-pole</b>			
<b>230 V</b>			
20 A	1,5 kW	48 x 48	KG10A.T102/04.FT2
		64 x 64	KG10B.T102/04.FT2
<b>3-pole</b>			
<b>3 x 400 V</b>			
20 A	5,5 kW	48 x 48	KG10A.T103/04.FT2
		64 x 64	KG10B.T103/04.FT2
25 A	7,5 kW	48 x 48	KG20A.T103/04.FT2
		64 x 64	KG20B.T103/04.FT2
32 A	11 kW	48 x 48	KG32A.T103/04.FT2
		64 x 64	KG32B.T103/04.FT2



2-/3-pole



Complete items

2-pole



3-pole

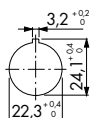

Maximum number of padlocks		
Face plate	Shackle-Ø	Number of padlocks
48 x 48	7	3
	5	4
	8	3
64 x 64	5	4

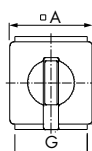
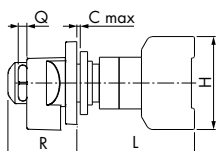

	A	L	G	H	R	Q	C max
KG10A 2-pole	48	57,4	48	50	52	7,2	6
KG10A 3-pole	48	66,9	48	50	52	7,2	6
KG10B 2-pole	64	64,4	48	50	58	8	6
KG10B 3-pole	64	73,9	48	50	58	8	6
KG20A, KG32A	48	68,3	42	54	52	7,2	6
KG20B, KG32B	64	68,3	42	54	58	8	6