

POWR-SAFE “Dead Front” Holders



NEW

Littelfuse POWR-SAFE “Dead Front” holders provide optimum protection to personnel. Indicating and non-indicating versions are available in 1, 2, 3, or 4 poles for Class CC and Midget fuses.

BLOCKS AND HOLDERS

FEATURES/BENEFITS

- Meets “Dead Front” requirements and IEC Type IP2 Protection
- Mountable on 35mm Din Rail
- Blown fuse identification (Indicating versions only)
- Easy installation and removal of fuses. No special fuse pullers or tools required.
- UL Listed for branch circuit protection (Class CC versions only)
- Compact design
- Ventilated design for cooler operation

DIMENSIONS in inches (mm in parentheses)

■ LPSM/LPSC POWR-SAFE Holders

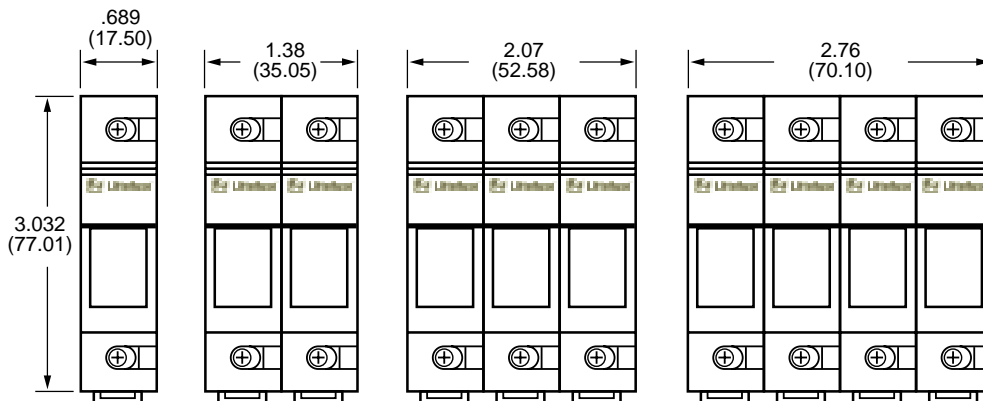

SPECIFICATIONS

- Voltage rating:** 600 Volts
- Ampere rating:** 30 amperes
- Interrupting rating:** 200 kA (Class CC)
100 kA (Midget)
- Terminal type:** Pressure plate
- Suggested Torque:** 15 lb.
- Wire range:** #6—#14CU
- Material:** Thermo-Plastic
- Flammability Rating:** 94VO
- Approvals:** UL Listed
CSA Certified
IEC Type IP2 Protection
CE Certified

ORDERING INFORMATION

Indicating Part Number	Non-Indicating Part Number	Fuse Type	Number of Poles
LPSC001ID	LPSC001	Class CC	1
LPSC002ID	LPSC002	Class CC	2
LPSC003ID	LPSC003	Class CC	3
LPSC004ID	LPSC004	Class CC	4
LPSM001ID	LPSM001	Midget	1
LPSM002ID	LPSM002	Midget	2
LPSM003ID	LPSM003	Midget	3
LPSM004ID	LPSM004	Midget	4

POWR-Covers - Fuse Block Covers



Littelfuse fuse block covers protect personnel from accidentally contacting energized contacts. Covers are available for Class H, R, J, and CD type fuses up to 100 amps.

ORDERING INFORMATION

Littelfuse Part Number	For Use With Fuse Block Number	Voltage	Amp	Fuse Class
LH25030-PC	LH25030/LR25030 series	250	30	H/R
LH25060-PC	LH25060/LR25060 series	250	60	H/R
LH25100-PC	LH25100/LR25100 series	250	100	H/R
LH60030-PC	LH60030/LR60030 series	600	30	H/R
LH60060-PC	LH60060/LR60060 series	600	60	H/R
LH60100-PC	LH60100/LR60100 series	600	100	H/R
LJ60030-PC	LJ60030 series only	600	30	J
LJ60060-PC	LJ60060 series only	600	60	J
LJ60100-PC	LJ60100 series only	600	100	J
L60060C-PC	L60060C series only	600	60	CD

SPECIFICATIONS

Voltage rating: 600 Volts

Ampere rating: Class H: 0-100 amps
 Class R: 0-100 amps
 Class J: 0-100 amps
 Class CD: 60 amps

Material: Thermoplastic

Approvals: UL Listed
 IEC Type IP2 Protection

FEATURES/BENEFITS

- Meets "Dead Front" requirements and IEC Type IP2 Protection for most applications (see note)
- Easily gangable with optional "gang-slide" adapters
- Added safety to personnel
- Unique design allows Littelfuse Indicator™ fuses to be seen through covers
- Ventilated to avoid fuse derating
- Covers are reusable
- Covers fit most competitor blocks

For "Gang Slide" Adapters order:

PCGS-2 for 2 poles
 PCGS-3 for 3 poles

NOTE: Contact Factory for specific applications.



Fuse Pullers



Littelfuse fuse pullers are the safe way of handling power fuses.

Littelfuse's new ergonomically-designed fuse puller offers greater ease in removing fuses. This new molded design is superior to standard pullers because it offers a more comfortable and natural grip when pulling fuses, improving performance. Part No. LPFP

PART NUMBER & APPLICATION

Midget Fuse Puller

MFP: For 3/16" to 1/2" dia. fuses.

Pocket Fuse Puller

LPFP: For 0 – 200A 250V,
 0 – 100A 600V
 (9/16" – 1-19/32" dia. fuses)

Giant Fuse Puller

GFP: 61 – 600A 250V,
 61 – 400A 600V
 (1-1/16" – 2-19/32" dia. fuses)

Tri-Puller

097023: For ATO® and glass fuses.

571 Series Panel Mounted Fuseholders



Panel mount fuseholders are available for supplementary or Class CC branch circuit protection. Class CC fuses have a rejection feature on one end cap which mates with the rejection feature of Littelfuse Class CC fuse blocks and fuseholders to prevent the installation of fuses with lower voltage ratings or interrupting ratings. Watertight version must be front panel mounted.

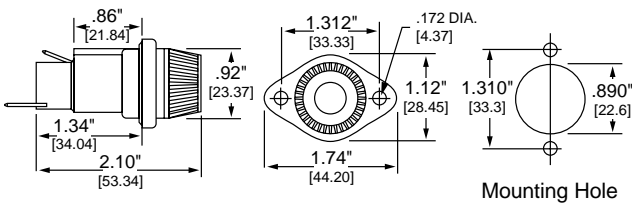

SPECIFICATIONS

Voltage rating: 600 Volts

Ampere rating: 30 amperes for Class CC and Midget fuses

Dielectric strength: 4000 Volts

Terminals: Tin-plated brass combination solder and quick-connect

Molded parts: Black thermoplastic

Approvals: UL Recognized (File No. E14721) — 571 series
 UL Recognized for branch circuit protection — 571 OCC/RCC
 CSA Certified (File No. LR7316)

ORDERING INFORMATION

Part Number		Bottom Terminal	Fuse Length Range*	For Use With
Standard	Watertight			
571 027	571 027P	Straight Rt. Angle	1 ⁵ / ₁₆ " — 1 ³ / ₈ "	Midget Fuses
571 028	571 028P			
571 007	571 007P	Straight Rt. Angle	1 ¹³ / ₃₂ " — 1 ¹ / ₂ "	Midget Fuses
571 008	571 008P			
571 OCC	571 OCCP	Straight Rt. Angle	1 ¹ / ₂ "	Class CC Fuses
571 RCC	571 RCCP			

* Fuse diameter is 1³/₃₂".

POWR-JAW Clip Clamps



POWR-JAW clamps improve the contact between fuse and clip. The unnecessary heat from poor contact due to the loss of spring force in the clips can cause nuisance fuse opening and premature aging of surrounding components.

- High temperature phenolic resin knob designed for the most severe environments.
- 7 sizes to provide effective coverage.
- Simple design makes installation easy.

Part Number	Volts	Amperes
LCC 1	250	0-30
LCC 2	250	35-60
LCC 2	600	0-30
LCC 4	600	35-60
LCC 5	250/600	70-100
LCC 6	250/600	110-200
LCC 7	250/600	225-400
LCC 8	250/600	450-600