

**Industrial Ethernet
IE-XRJ45/IDC**

Weidmüller Interface GmbH & Co. KG
Klingenbergstraße 16
D-32758 Detmold
Germany
Fon: +49 5231 14-0
Fax: +49 5231 14-292083
www.weidmueller.com



IE plug-in connectors, IP20, for copper and fibre optic cables

General ordering data

Type	IE-XRJ45/IDC
Order No.	8808330000
Version	Flange insert, Cat.6 _A / Class E _A (ISO/IEC 11801 2010)
GTIN (EAN)	4032248505913
Qty.	1 pc(s).

Industrial Ethernet IE-XRJ45/IDC

Weidmüller Interface GmbH & Co. KG
 Klingenbergstraße 16
 D-32758 Detmold
 Germany
 Fon: +49 5231 14-0
 Fax: +49 5231 14-292083
 www.weidmueller.com

Technical data

Dimensions and weights

Length	43.8 mm	Length (inches)	1.724 inch
Width	14.7 mm	Width (inches)	0.579 inch
Height	23.4 mm	Height (inches)	0.921 inch
Wall thickness, max.	1.55 mm	Wall thickness, min.	1.45 mm
Net weight	32 g		

Temperatures

Operating temperature, max.	70 °C	Operating temperature, min.	-40 °C
Storage temperature, max.	70 °C	Storage temperature, min.	-40 °C
Operating temperature	-40 °C...70 °C		

General data

Housing main material	Zinc diecast	Insulation cross-section, max.	1.8 mm
Category	Cat.6 _A / Class E _A (ISO/IEC 11801 2010)	Connection diameter, solid	0.41...0.64 mm
Conductor connection cross-section, solid (AWG)	AWG 26...AWG 22	Connection diameter, flexible	0.48...0.76 mm
Conductor connection cross-section, flexible (AWG)	AWG 26...AWG 22	Insertion force	20 N

Electrical properties

Contact resistance	≤ 20 mΩ	Dielectric strength, contact / contact	≥ 1000 V DC
Insulation resistance	500 MΩ		

Standards

Generic communication cable facilities	ISO/IEC 11801	Connector standard	IEC 60603-7-51
Certificate No. (GERMLLOYD)	33451-06		

Classifications

ETIM 3.0	EC001264	ETIM 4.0	EC001264
ETIM 5.0	EC001264	ETIM 6.0	EC001121
UNSPSC	43-17-27-10	eClass 5.1	27-25-05-04
eClass 6.2	27-25-05-04	eClass 7.1	27-25-05-04
eClass 8.1	19-17-01-25	eClass 9.0	19-17-01-25
eClass 9.1	27-44-09-90		

Approvals

Approvals



ROHS Conform

Data sheet**Industrial Ethernet
IE-XRJ45/IDC**

Weidmüller Interface GmbH & Co. KG
Klingenbergstraße 16
D-32758 Detmold
Germany
Fon: +49 5231 14-0
Fax: +49 5231 14-292083
www.weidmueller.com

Technical data**Downloads**

Brochure/Catalogue	CAT 9 IETH 15/16 EN FL FIELDWIRING EN PI PROFINET CABLING EN
User Documentation	MAN IE GUIDE DE MAN IE GUIDE EN

**Industrial Ethernet
IE-XRJ45/IDC**

Weidmüller Interface GmbH & Co. KG
Klingenbergstraße 16
D-32758 Detmold
Germany
Fon: +49 5231 14-0
Fax: +49 5231 14-292083
www.weidmueller.com

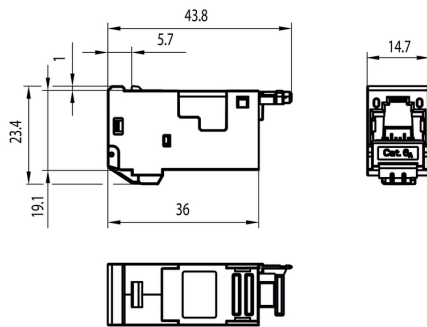
Drawings**Dimensioned drawing****Installation cut-out**