

## PRINCIPAL SPECIFICATIONS

Model Number	Center Frequency $f_0$ , MHz	Usable Bandwidth
PSS-2B-**B	10 to 400	$f_0 \pm 5\%$

For complete Model Number replace \*\* with desired center Frequency,  $f_0$  in MHz.

## GENERAL SPECIFICATIONS

Phase Shift Range:	90° min. @ $f_0$
Insertion Loss:	1.5 dB max.
Impedance:	50 $\Omega$ nom.
VSWR:	1.6:1 max.
Screw Drive:	Multi-turn
(insertion phase increases with clockwise rotation)	
Turns for max. Shift:	18 turns nom.
CW Power:	0.5 Watts max.
Package:	PC Plug-In
Weight, nominal:	1.1 oz. (31 g)
Operating Temp:	-55° to +85°C

## Package Outline

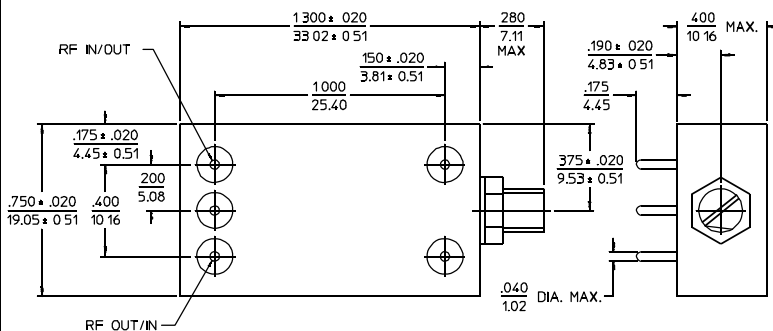

- NOTES: 1. Tolerance on 3 place decimals  $\pm .010(.25)$  except as noted.  
 2. Dimensions in inches over millimeters.  
 3. All unmarked pins are internally ground.

## General Notes:

- The PSS-2B series consists of PC mountable phase shifters with continuous multi-turn adjustment from 0° to at least 90°.
- This series employs lumped element quadrature hybrids with capacitor tuned LC networks acting as sliding short circuits on the outputs. The electrical length of the short effectively delays the reflected signal that appears at the isolated port of the quadrature hybrid.
- Similar Phase Shifters are available in a variety of connectorized packages as well as electronically tuned models in flatpacks and surface mounts.

15Feb96

## Typical Performance

