

Adapter zwischen den Serien Inter Series Adaptors

20 TNC auf FME TNC to FME

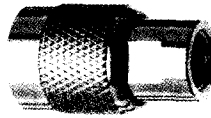

A

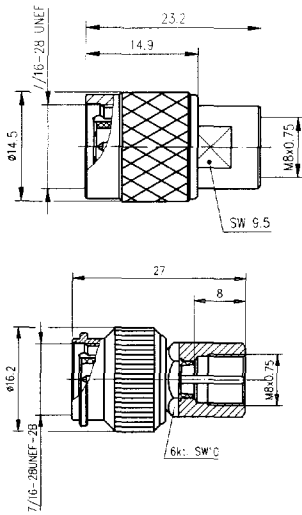

B

Bestell-Nr. Order Nr.	Abb. Fig.	Anmerkungen Remarks
J01019F0004	A	Sti-Sti / m-m
J01019A0004	B	Sti-Sti Innenleiter Ag / m-m conductor Ag

21 Winkeladapter TNC auf FME Angle Adaptor TNC to FME

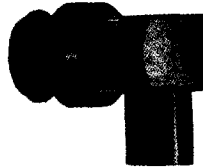
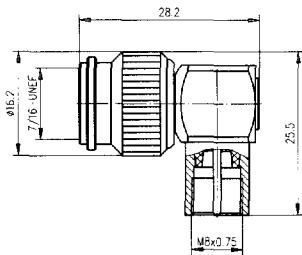

Bestell-Nr. Order Nr.	Anmerkungen Remarks
J01019A0012	Sti-Sti / m-m

22 TNC auf MCX TNC to MCX

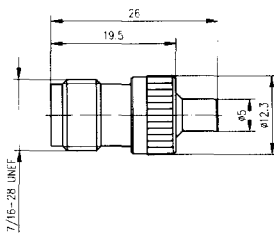

Bestell-Nr. Order Nr.	Anmerkungen Remarks
J01019A0024	Bu-Bu / f-f

23 N auf Mini-UHF N to Mini UHF

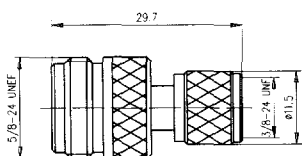

A

Adapter zwischen den Serien Inter Series Adaptors

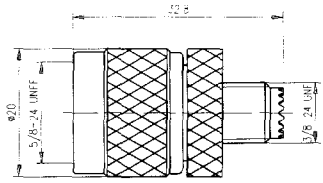

B

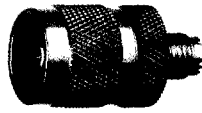

Bestell-Nr. Order Nr.	Abb. Fig.	Anmerkungen Remarks
J01027F0011	A	Bu-Sti / f-m
J01027F0012	B	Sti-Bu / m-f

24 N auf FME N to FME

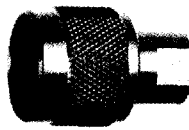
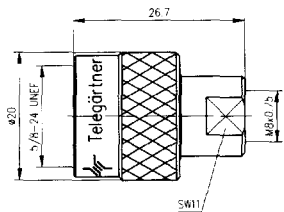

Bestell-Nr. Order Nr.	Anmerkungen Remarks
J01027A0013	Sti-Sti / m-m

25 Winkeladapter N auf FME Angle Adaptor N to FME

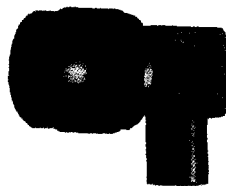
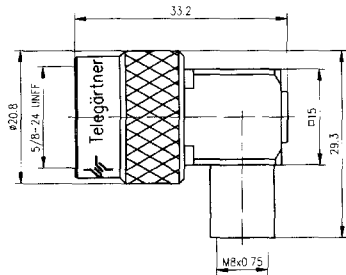

Bestell-Nr. Order Nr.	Anmerkungen Remarks
J01027A0009	Sti-Sti / m-m

26 N auf SMB Einbauadapter N to SMB Bulkhead Adaptor

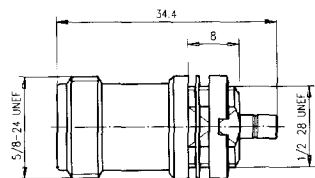

Bestell-Nr. Order Nr.	Einbaumaß Mount. dim.	Anmerkungen Remarks
J01027A0001	Z49	Bu-Sti / f-m

27 N auf SMA N to SMA

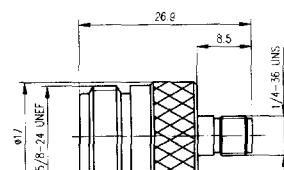

A



Adapter zwischen den Serien Inter Series Adaptors

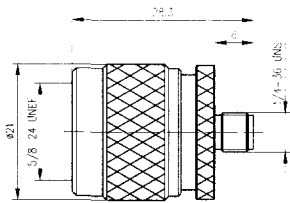

B

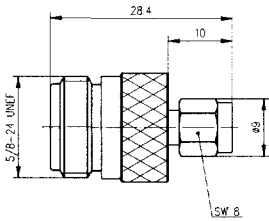

C

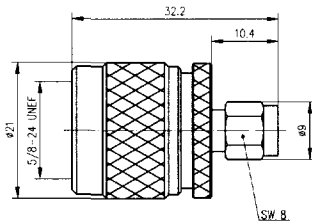

D

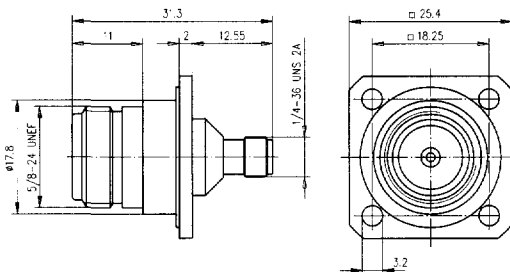

E



Bestell-Nr. Order Nr.	Abb. Fig.	Einbaumaß Mount. dim.	Anmerkungen Remarks
J01027A0017	A		Bu-Bu, $r < 0.1/10$ GHz / $f-f$, $r < 0.1/10$ GHz
J01027A0018	B		Sti-Bu, $r < 0.1/10$ GHz / $m-f$, $r < 0.1/10$ GHz
J01027A0016	C		Bu-Sti, $r < 0.1/10$ GHz / $f-m$, $r < 0.1/10$ GHz
J01027A0019	D		Sti-Sti, $r < 0.1/10$ GHz / $m-m$, $r < 0.1/10$ GHz
J01027B0008	E	Z53	Bu-Bu mit Flansch / $f-f$ Panel

28 UHF auf N UHF to N

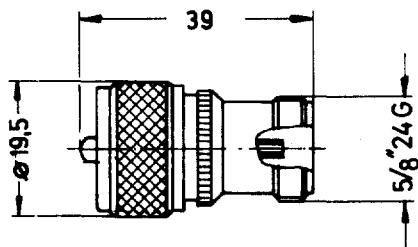

A

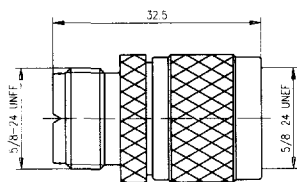

B

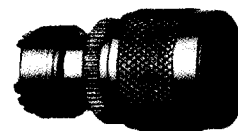

Bestell-Nr. Order Nr.	Abb. Fig.	MIL-Std. MIL-Std.	Anmerkungen Remarks
J01043A0831	A	UG-83 B/U	Sti-Bu / $m-f$
J01043A0832	B	UG-146 /U	Bu-Sti / $f-m$