

COAXIAL CONNECTORS ACCESSORIES & ADAPTERS

BNC FEMALE TO FEMALE



800-2406-03-25
Teflon* Insulated.
Gold Plated
Beryllium Center
Contacts.

50 OHM
500 VRMS

BNC MALE TO MALE



800-2407-03-25
Teflon* Insulated.
Gold Plated
Beryllium Outer
Finger Contacts.

50 OHMS
500 VRMS

TYPE "N" FEMALE TO BNC MALE



800-2450-03-25
Teflon* Insulated.
Gold Plated
Beryllium Male
and Female
Center Contacts

50 OHMS
500 VRMS

BNC "T" 3 FEMALES

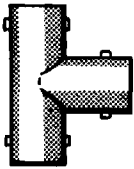

800-2408-03-25
Teflon* Insulated.
Gold Plated
Beryllium
Center Contacts

50 OHMS
500 VRMS

BNC FEMALE TO FEMALE FLANGE MOUNT

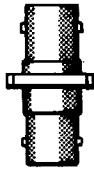

800-2463-03-25

Teflon* Insulated.
Gold Plated
Beryllium
Center Contacts
50 OHMS
500 VRMS

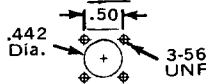

BNC FEMALE TO TYPE "N" MALE



800-2451-03-25

Teflon* Insulated
Gold Plated
Beryllium
Center Contacts

50 OHM
500 VRMS

BNC "T" FEMALE, MALE, FEMALE

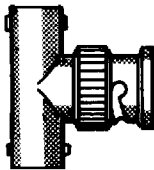

800-2460-03-25

Teflon* Insulated.
Gold Plated
Beryllium Female
Center and Male
Outer Finger
Contacts

50 OHM
500 VRMS

ISOLATED GROUND BNC FEMALE TO FEMALE



800-2464-03-25

Teflon* Insulated.
Gold Plated
Beryllium
Center Contacts
Outer Conductor
is Isolated from
Panel

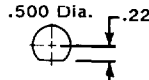

50 OHM
500 VRMS

BNC FEMALE TO UHF MALE



800-2452-03-25

Rexolite Insulation.
Gold Plated
Male and Female
Center Contacts

500 VRMS

BNC "T" MALE, FEMALE, FEMALE

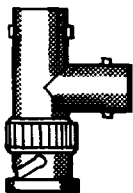

800-2461-03-25

Teflon* Insulated.
Gold Plated
Beryllium Female
Center and Male
Outer Finger
Contacts

50 OHM
500 VRMS

HERMETICALLY SEALED BNC FEMALE TO FEMALE



800-2465-03-25

Teflon* Insulated.
Silicone Rubber
O Ring
Gold Plated
Beryllium
Center Contacts

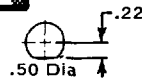

50 OHM
500 VRMS

UHF FEMALE TO BNC MALE



800-2453-03-25

Rexolite Insulation.
Gold Plated
Phos. Bronze Male
and Female
Center Contacts

50 OHM
500 VRMS

RIGHT ANGLE BNC FEMALE TO BNC MALE

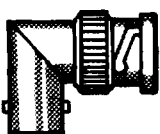

800-2462-03-25

Teflon* Insulated
Gold Plated
Beryllium Center
and Male Outer
Finger Contacts

50 OHM
500 VRMS

TNC FEMALE TO FEMALE ADAPTER



800-2409-03-25

Teflon* Insulated.
Gold Plated
Beryllium
Center Contact

50 OHM
500 VRMS

BNC FEMALE TO TNC MALE



800-2454-03-25

Teflon* Insulated.
Gold Plated
Beryllium Male and
Female Center
Contacts

50 OHM
500 VRMS

COAXIAL CONNECTORS ACCESSORIES & ADAPTERS

TNC FEMALE TO BNC MALE



800-2455-03-25
Teflon* Insulated.
Gold Plated
Beryllium Male
and Female
Center Contact

50 OHM
500 VRMS

UHF MALE CABLE PLUG

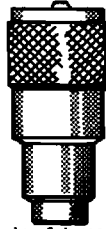

800-2457-03-25
Phenolic Insulation.
Gold Plated
Center Contact.
For use on RG8, 9,
11, 13, 58C, 141,
149, 213, 214,
and 216 cable

500 VRMS

75 OHM BNC MALE CABLE PLUG FIELD SERVICEABLE

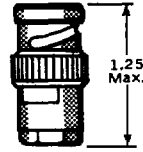

800-2475-03-25
Teflon* Insulated.
Gold Plated Brass
Center Contact

BNC FEMALE TO TYPE "C" MALE

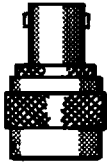

800-2456-03-25
Teflon* Insulated.
Gold Plated
Beryllium Male
and Female
Center Contacts

50 OHM
500 VRMS

TNC MALE CABLE PLUG



800-2401-03-25
Teflon* Insulated.
Gold Plated Brass
Center Contact
For use on RG55, 58,
141, 142, and 223
cable

50 OHM
500 VRMS

TYPE "N" OR UHF DUST CAP

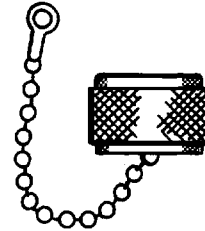

800-2485-03-25
Beaded Chain.
.14 Dia. Hole
in Lug.

BNC SHORTING PLUG



800-2400-03-25
Gold Plated
Center Contact
Beaded Chain
with .140 Dia.
Mounting Hole in
Lug.

500 VRMS

BNC MALE CABLE PLUG



Teflon* Insulated.
Gold Plated Brass
Center Contact
800-2411-03-25
For use on RG55, 58,
141, 142, and 223
800-2412-03-25
For use on RG59, 62,
71, and 210
800-2580-03-25
For use on RG174,
316

50 OHM
500 VRMS

BNC MALE CABLE PLUGS FIELD SERVICEABLE



800-2532-03-25
For RG58.
800-2533-03-25
For RG59.
800-2534-03-25
For RG174.

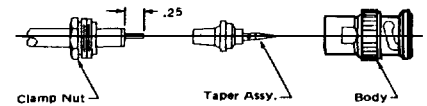

Strip Cable — Push the taper assembly under the braid and solder. Thread clamp nut into body.

DUST CAP FOR BNC FEMALE



800-2402-02-25
Beaded Chain
with .140 Dia.
Mounting Hole
in Lug.

BNC FEMALE CABLE JACK



Teflon* Insulated.
Gold Plated
Beryllium
Center Contact
800-2413-03-25
For use on RG55, 58,
141, 142, and 223
800-2414-03-25
For use on RG59, 62,
71, and 210

50 OHM
500 VRMS

CRIMP-TYPE BNC MALE CABLE PLUG



800-2570-03-25
For RG55, 58, 141,
142, and 223
800-2571-03-25
For RG59, 62, 71
and 210

50 OHM
500 VRMS

Teflon* Insulated. Center Contact
Brass, Gold Plated

DUST CAP FOR BNC MALE

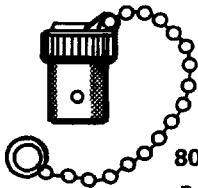

800-2403-02-25
Beaded Chain
.28 Dia Hole in Lug.

BNC RIGHT ANGLE MALE CABLE PLUG

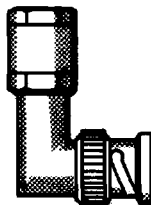

800-2415-03-25
Teflon* Insulated.
Gold Plated Brass
Center Contact.
For use on RG55, 58,
141, 142, and 223

50 OHM
500 VRMS

COAXIAL ACCESSORIES/TERMINATIONS

BNC 50 OHM ATTENUATORS MALE BNC TO FEMALE BNC

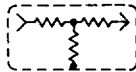
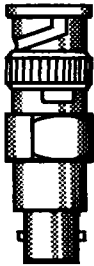

50 Ohm Metal Film Resistor,
Deposited Nichrome Over Ceramic
Core. 2 Watt T-Pad Network.
Teflon* Insulated.
Gold Plated Center Contact.

Part No.	Attenuator	VSWR	Attenuation Tolerance
800-2510-03-25	3 dB	1.1 to 1 GHz	±0.4 dB to 1 GHz
800-2511-03-25	6 dB	1.2 to 2 GHz	±0.45 dB to 2 GHz
800-2512-03-25	10 dB	1.35 to 4 GHz	±0.65 dB to 4 GHz
800-2513-03-25	14 dB	1.45 to 6 GHz	±0.75 dB to 6 GHz
800-2514-03-25	20 dB	1.65 to 8 GHz	±0.9 dB to 8 GHz

BNC FEED-THRU SERIES RESISTOR MALE BNC TO FEMALE BNC



1% 2 Watt Non-Inductive Film
Resistor. Teflon* Insulator.
Gold Plated Center Contact.

500 VRMS	Part No.	Resistance
	800-2523-03-25	25 OHMS
	800-2524-03-25	50 OHMS
	800-2525-03-25	75 OHMS
	800-2526-03-25	93 OHMS

BNC RESISTOR TERMINATED MALE PLUG

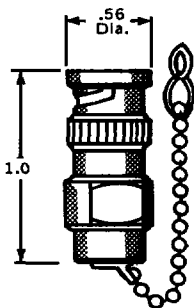

1% 1/2 Watt Carbon Resistor
Teflon* Insulator
Gold Plated Center Contact

* 1% 1 Watt Carbon Resistor

500 VRMS
Beaded Chain
with .140 Dia.
Hole in Lug.

Part No. With Chain	Part No. Without Chain	Resistance
* 800-2515-03-25	800-2543-03	50 OHMS
* 800-2516-03-25	800-2541-03	75 OHMS
800-2517-03-25	800-2542-03	93 OHMS

BNC FEED-THRU TERMINATION MALE BNC TO FEMALE BNC



Termination Metal Film Resistor
Deposited Nichrome Over Ceramic
Core, 2 W.
Teflon* Insulator.
Gold Plated Center Contact.

500 VRMS

Part No.	Resistance
800-2528-03-25	50 OHMS
800-2529-03-25	75 OHMS
800-2530-03-25	93 OHMS
800-2531-03-25	600 OHMS

TYPE "N" RESISTOR TERMINATED MALE PLUG

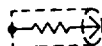
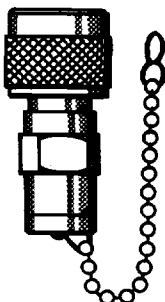

1000 VRMS
Beaded Chain with
.140 Hole in Lug.

1% 1 Watt Deposited Carbon
Resistor. Teflon* Insulator.
Gold Plated Center Contact.
Rated +102° C Max.
Frequency Range: DC to 500 MHz.

Part No. With Chain	Part No. Without Chain	Resistance
800-2520-03-25	800-2545-03	50 OHMS
800-2521-03-25	800-2546-03	75 OHMS