

NOTES:

1. MATERIALS AND FINISHES: (SEE 349-50759 FOR DETAILS)
 - BODY = BRASS NICKEL PLATED
 - CONTACT = BRASS, GOLD PLATED
 - BRACKET = C1008 CARVON STEEL, TIN PLATED
 - INSULATOR = NYLON(PA), UNFILLED
 - FAKRA HOUSING = NYLON(PA), UNFILLED
2. ELECTRICAL:
 - A. IMPEDANCE: 50 OHM, NOMINAL
 - B. OPERATING FREQ: 200KHZ-500MHZ
 - C. DIELECTRIC WITHSTANDING VOLTAGE: 1000 VRMS, MIN.
3. MECHANICAL:
 - A. DURABILITY: 100 CYCLES MIN.
 - B. TEMPERATURE RANGE: -40° C TO +85° C
4. PACKAGING:
 - A. QUANTITY: TRAY PACK
 - B. MARKING: TRAY TO BE MARKED "AMPHENOL, PART NUMBER PER TABLE, AND DATE CODE"

THIRD ANGLE PROJ.

REVISIONS

REV	DESCRIPTION	DATE	ECO	APPR
A	RELEASE TO MFG	08-Sep-06	46253	HELLEN

TABLE

KEY CODING	PART NO.	DRAWING NO.	COLOR
B	2FAI-SDRP-PCB-B	FKI252BS-019-NNYL10G-50	CREAM WHITE
I	2FAI-SDRP-PCB-I	FKI252IS-019-NNYL10G-50	BEIGE

CONFIGURATION CONTROL:
NO CHANGES PERMITTED TO DRAWING WITHOUT
PPAP QUALIFIED CUSTOMER APPROVAL

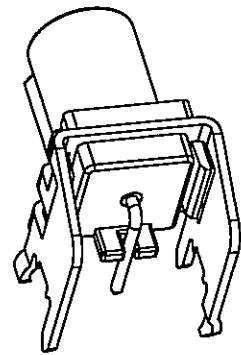

FAKRA PLUG
INTERFACE PER
DIN 72594-1

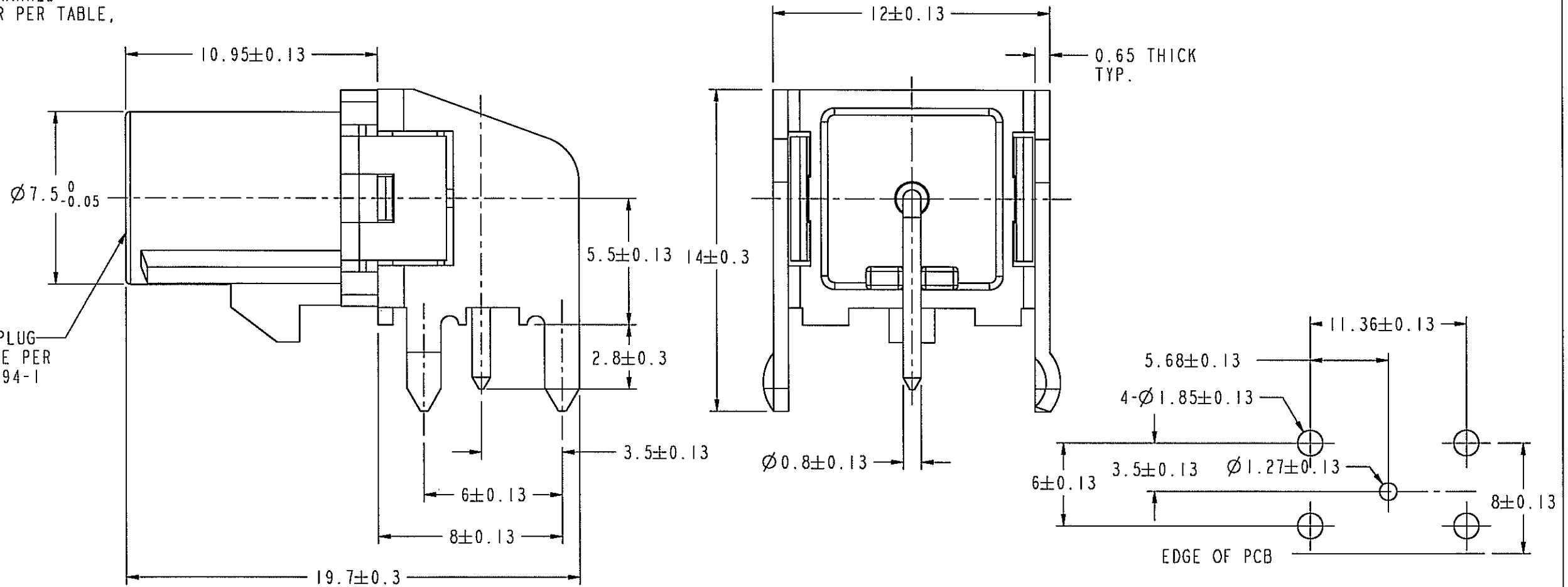

SCALE 2.000

SCALE 5.000

SCALE 3.000

RECOMMENDED MOUNTING HOLE

METRIC DRAWING

CUSTOMER OUTLINE DRAWING

ALL OTHER SHEETS ARE FOR INTERNAL USE ONLY

UNLESS OTHERWISE SPECIFIED, DIMENSIONS ARE METRIC AND TOLERANCES ARE: 1 PLACE DECIMAL ± 0.3MM (.012") 2 PLACE DECIMAL ± .10 MM (.004") ANGLES ± 1°	MATERIAL	DRAWN HELLEN	DATE 08-Sep-06	TITLE FAKRA R/A PLUG FOR PCB		Amphenol RF Danbury CT USA, Tainan, Taiwan, Shenzhen, China www.amphenolrf.com	
	REFERENCE REF. 28045990 & 28045992	ENGINEER JERRY	DATE 08-Sep-06				
NOTICE - These drawings, specifications, or other data (1) are, and remain the property of Amphenol Corp. (2) must be returned upon request; and (3) are confidential and not to be disclosed to any person other than those to whom they are given by Amphenol Corp. the furnishing of these drawings, specifications, or other data by Amphenol Corp., or to any other person to anyone for any purpose is not to be regarded by implication or otherwise in any manner licensing, granting rights to permitting such holder or any other person to manufacture, use or sell any product, process or design, patented or otherwise, that may in any way be related to or disclosed by said drawings, specifications, or other data.	CONFIGURATION LEVEL:	APPROVED <i>B-Cyl</i>	DATE 9/8/06	SCALE: 5.0:1.0	SHEET 2 OF 2	DRAWING NO. FKI252XX-019-NNYL10G-50	
	FINISH	1/FKI252XX-019-NNYL10G-50	DWG SIZE B	CODE ID 74868	REV A	ITEM NO. FKI252SMXA1JG5F PART NO. SEE TABLE	