

**Series 801 "Mighty Mouse"  
Cable Plugs  
801-007 & 801-008**



## How to Order Series 801 Cable Plugs

**Series 801 Double Start Plugs** are available in two shell styles:

An *Integral Band Platform* provides a convenient means of attaching cable shields directly to the connector.

An *Accessory Thread* provides accommodation for a wide variety of strain reliefs and backshells.

### How to Order Series 801 Cable Plugs

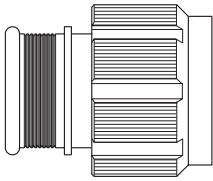
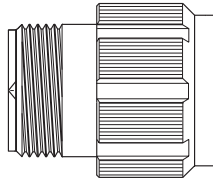
Series	Shell Style	Shell Material / Finish	Shell Size / Insert Arrangement	Contact Type	Shell Key Position		
<b>801-007</b> Banding Platform for Direct Attachment of Cable Shield and Overmold  	<b>16</b> Plug, with Anti-Decoupling Spring	<b>C</b> Aluminum, with Black Anodized Finish	<b>5-3</b> 3 Contacts	<b>P</b> Pin	<b>A</b> Normal		
		<b>M</b> Aluminum, with Electroless Nickel Finish	<b>6-4</b> 4 Contacts	<b>S</b> Socket	Alternate Key Positions: <b>B</b> <b>C</b> <b>D</b>		
		<b>NF</b> Aluminum, with Olive Drab Cadmium Finish	<b>6-7</b> 7 Contacts				
		<b>801-008</b> Rear Accessory Thread  		<b>ZN</b> Aluminum, with Olive Drab Zinc-Nickel Finish	<b>7-10</b> 10 Contacts		
				<b>ZNU</b> Aluminum, with Black Zinc-Nickel Finish	<b>8-13</b> 13 Contacts		
				<b>Z1</b> Stainless Steel, with Passivated Finish	<b>9-19</b> 19 Contacts		
					<b>10-26</b> 26 Contacts		
					<b>13-37</b> 37 Contacts		
					<b>16-55</b> 55 Contacts		
					<b>17-85</b> 85 Contacts		

### Part Number Example

801-008

—16

NF

9—19

P

A

## Series 801 Cable Plug Dimensions

### Series 801 Plug Dimensions

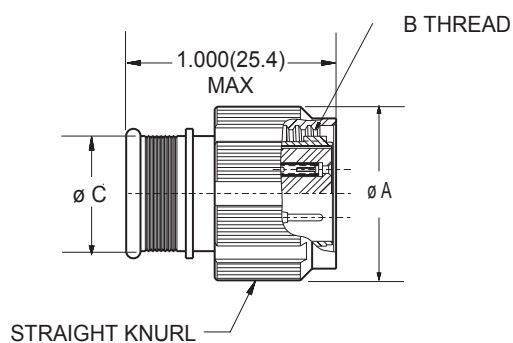

Integral Band Platform  
801-007

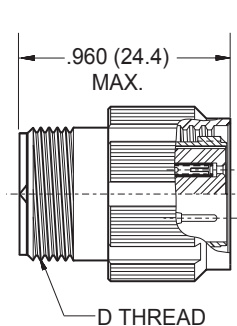

Accessory Thread  
801-008

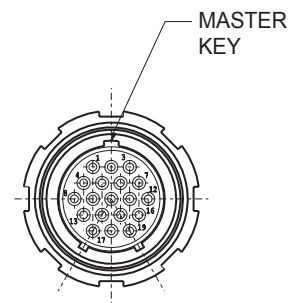

### Series 801 Plug Dimensions

Layout	$\varnothing A$	B Thread	$\varnothing C$	D Thread UNEF-2A
5-3	.540 (13.2)	.3125-.05P-.1L-2B	.245 (6.2)	.250-32
6-4	.600 (15.2)	.375-.05P-.1L-2B	.290 (7.4)	.3125-32
6-7	.600 (15.2)	.375-.05P-.1L-2B	.290 (7.4)	.3125-32
7-10	.680 (17.3)	.4375-.05P-.1L-2B	.390 (9.9)	.4375-28
9-19	.810 (20.6)	.5625-.05P-.1L-2B	.500 (12.7)	.5625-24
13-37	1.050 (26.7)	.8125-.1P-.2L-2B	.650 (16.5)	.6875-24
16-55	1.240 (31.5)	1.000-.1P-.2L-2B	.805 (20.4)	.9375-20
17-85	1.300 (33.0)	1.062-.1P-.2L-2B	.850 (21.6)	.9375-20

### Master Key Rotation

