

# Connectors

## SSMA Panel Mount Receptacles Terminal, Tab and Printed Circuit Type

### Straight Flange Mount Female Jack Receptacle - 4 Hole

Model Number

SSM-5510-15-TRM-02

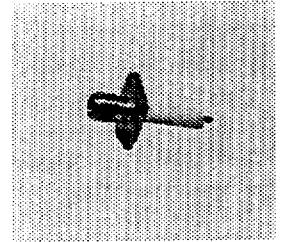
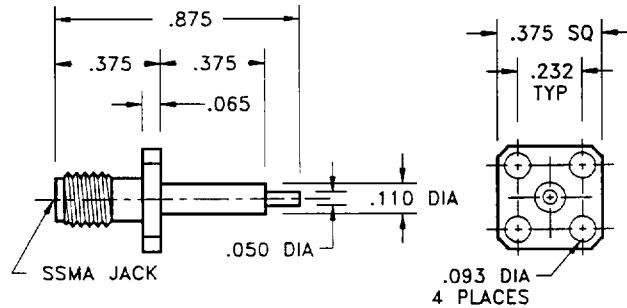

Note: Standard finish is passivated stainless steel, for gold plating change -02 suffix to -00.

### Straight Flange Mount Female Jack Receptacle - 2 Hole

Model Number

SSM-5210-15-TRM-02

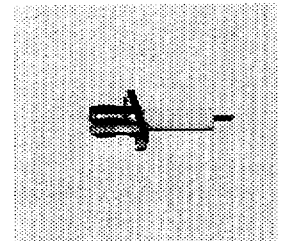
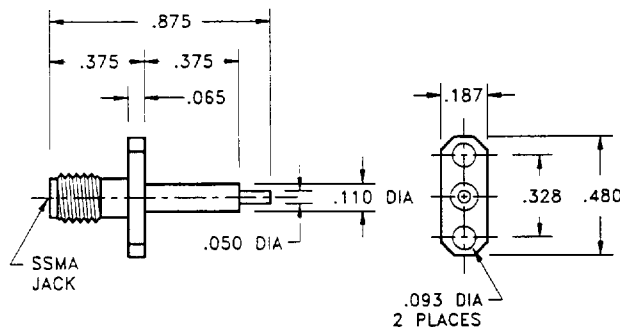

Note: Standard finish is passivated stainless steel, for gold plating change -02 suffix to -00.

### Straight Flange Mount Female Jack Receptacle

Model Number

SSM-5530-15-TAB-02

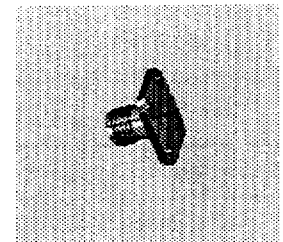
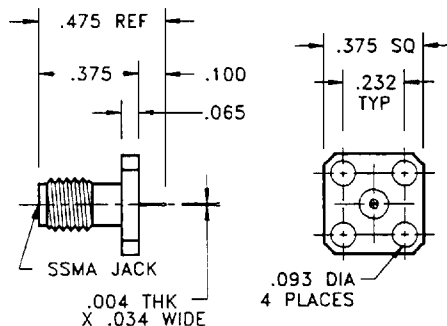

Note: Standard finish is passivated stainless steel, for gold plating change -02 suffix to -00.

### Straight Printed Circuit Board Mount Female Jack Receptacle

Model Number

SSM-5010-93-PCB-00

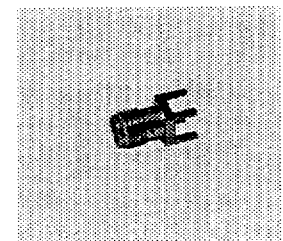
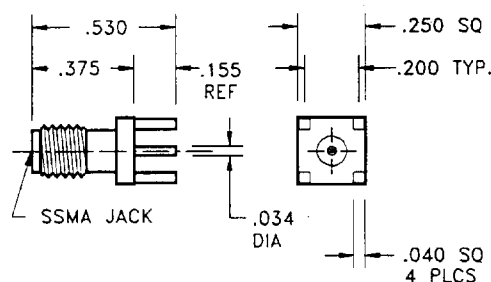

Note: Standard finish is gold plating for direct solder to circuit board. Detail interface dimension information can be found in the Appendix.