



Home > Product introduction > PC Terminal > P01~P04

PC Terminal (printed circuit board) ... page Nanba1
 PC-Terminal Material: brass, tin-plated Material: Brass, Tin-plated

● 50 pieces minimum lot
 Minimum Lot 50 Pieces RoHS compliant products

Part number P01

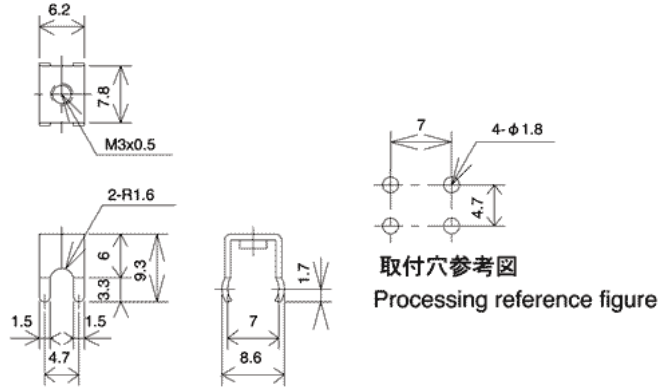

Part number P02

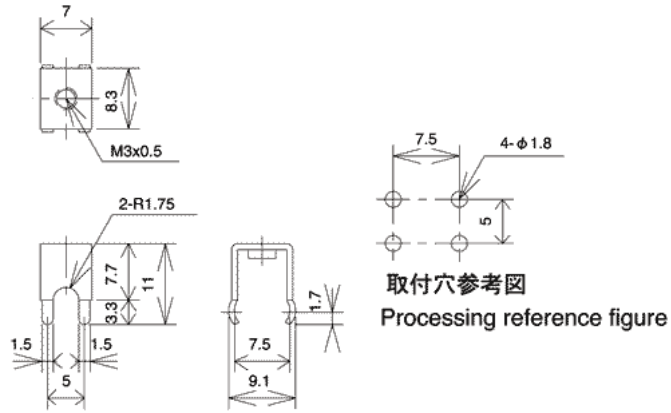

Rated: 15A
 Rating: 15A

Part number P03A

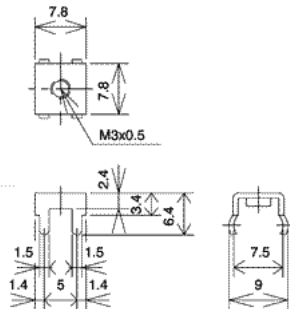

P03C

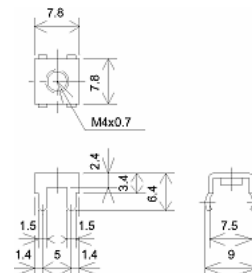
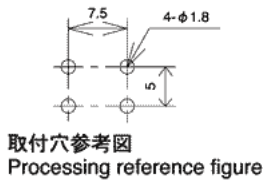

Rated: 15A
 Rating: 15A

Part number P04

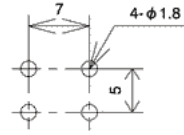
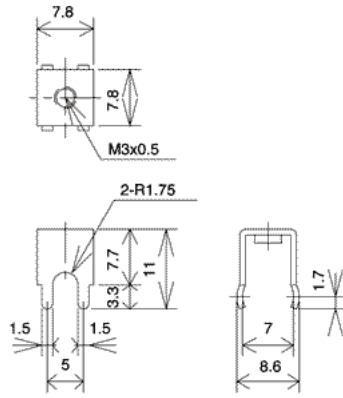

取付穴参考図
Processing reference figure

Rated: 15A
Rating: 15A

[PAGE TOP](#)

[| HOME](#) | [| Site Map](#) | [| Recruit](#) | [| Products](#) | [| Company](#) | [| sales network](#) | [| custom product](#) | [| Contact](#) |

© 2010 WORLD Co., Ltd. All Rights Reserved