

## Features

### ◆ 8300 Socket:

- Low profile
- Dual contact terminal
- Available in 6,8,14,16,18,24,28,32,40 and 48 circuits
- Glass filled polyester UL94V-0
- Anti solder wicking
- Contact: Phosphor bronze
- Plating: Tin plated

### ◆ 8305 Socket:

- Low profile
- Dual contact terminal
- Available in 16,20,22,24,28,30,32,40,42,48,52,56 and 64 contacts
- Glass filled polyester UL94V-0
- Anti solder wicking
- Contact: Phosphor bronze
- Tin plated contact as standard
- Saving on P.C.B. real estate
- Manually and automatically insertable

### ◆ LICS Socket:

- Low profile
- Available in 22,24,28 and 32 circuits
- Glass filled polyester UL94V-0
- Contact: Phosphor bronze
- Plating: Tin plated

## Specifications

- ◆ Current rating: 1A AC,DC
- ◆ Voltage rating: 250V AC,DC
- ◆ Temperature rating: -25°C ~ +105°C
- ◆ Contact resistance:
  - Initial: 20mΩ max.
  - After environmental test: 40mΩ max.
- ◆ Insulation resistance:
  - Initial: 1,000MΩ min.
  - After humidity and thermal shock test: 500MΩ min
- ◆ Withstanding voltage: 1,000V AC /minute
- ◆ Applicable PC board thickness: 1.6mm

# 8112 Series 1.27mm (.050") SOJ Surface Mount Socket



Unit :  $\frac{\text{mm}}{\text{inch}}$

### Ordering Information:

$\frac{8112}{1} - \frac{**}{2} \frac{T}{3} \frac{000}{4}$

1. Series No.
2. No. of circuits
3. Contact plating :  
 T = Tin plated  
 U = Gold, flash over 50 $\mu$ " nickel  
 W = 15 $\mu$ " gold over 50 $\mu$ " nickel  
 Z = 30 $\mu$ " gold over 50 $\mu$ " nickel
4. Special options  
 Color :  
 000 = Brown  
 001 = Black  
 002 = Without SMT standoff

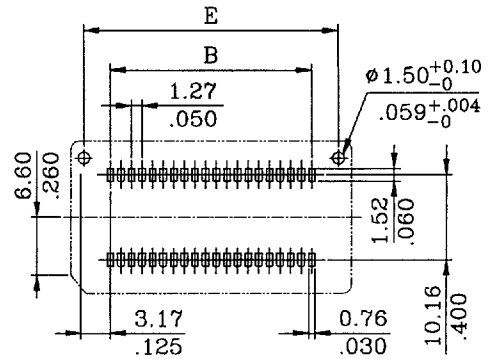
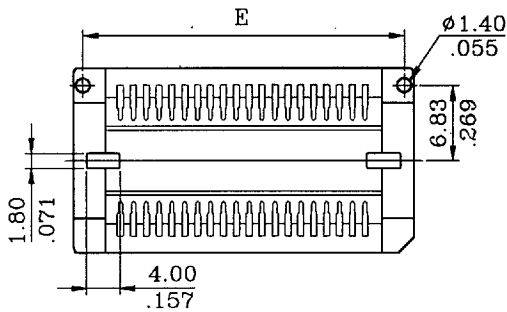
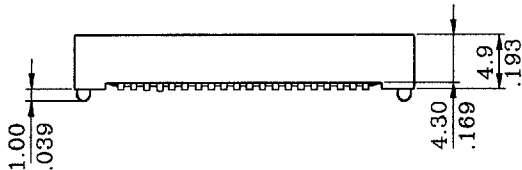
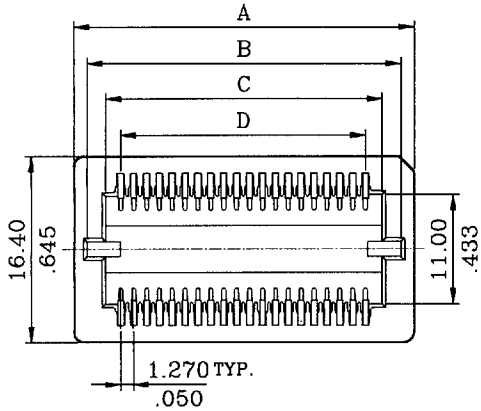

RECOMMENDED HOLE PATTERN

### Dimensional & Ordering Information:

Circuits	Dimension				
	Dim. A	Dim. B	Dim. C	Dim. D	Dim. E
24	23.14(.911)	21.00(.827)	16.64(.655)	13.97(.550)	21.59(.850)
26	24.41(.961)	22.27(.877)	17.91(.705)	15.24(.600)	22.86(.900)
28	25.68(1.011)	23.54(.927)	19.18(.755)	16.51(.650)	24.13(.950)
32	28.22(1.111)	26.08(1.027)	21.72(.855)	19.05(.750)	26.67(1.050)