

PCB LAYOUT

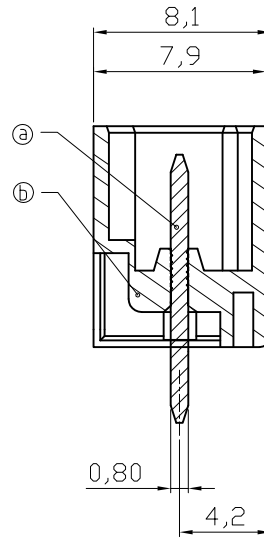
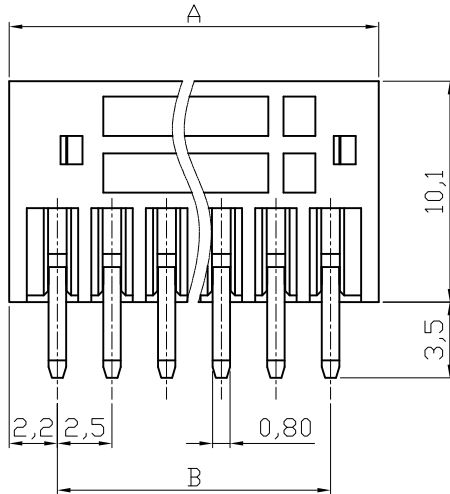

Material

- ① 1. Insulator(housing): Thermoplastic(UL94V-0), Black
- ② 2. Contact Pin: Brass(CuZn)Tin plated

Electrical

- cULus
- 1. Voltage rating: 150V
- 2. Current rating: 4A
- 3. Withstanding Voltage: 1.3KV
- 4. Operating temperature: -40°C to +115°C
- 5. Soldering temperature: 250°C ± 10°C / 5Sec

6. Safety Approval: US

POLE	2	3	4	5	6	7	8	9	10	11	12	
A	6.90	9.40	11.90	14.40	16.90	19.40	21.90	24.40	26.90	29.40	31.90	
B	2.50	5.00	7.50	10.00	12.50	15.00	17.50	20.00	22.50	25.00	27.50	
Tol.	±0.10						±0.15					
POLE	13	14	15	16	17	18	19	20	21	22	23	24
A	34.40	36.90	39.40	41.90	44.40	46.90	49.40	51.90	54.40	56.90	59.40	61.90
B	30.00	32.50	35.00	37.50	40.00	42.50	45.00	47.50	50.00	52.50	55.00	57.50
Tol.	±0.20						±0.30					

RoHS compliant

Scale	1:1						Date	Name	Customer-No.	
TOLERANCE							Drawn	Dean	ASSMANN WSW-No. A-TB250-OQxxCV-BK	
X.	±0.50						Approved	Hellwig		
X.X	±0.30									
X.XX	±0.10									
DIM	TOL								Drawing-No.	
X.°	±1°									ASS 4042 CO
Angle	TOL	①	Drawn	26.01.2010	Dean				Replace	Sheet
		Id.	Modification	Date	Name					