

PLEASE CHECK WWW.MOLEX.COM FOR LATEST PART INFORMATION

Part Number: **0190690235**
Status: **Active**
Overview: Solderless Terminals
Description: Krimptite Ring Tongue Terminal for 10-12 AWG Wire, Stud Size 8 (M4), Length 18.82mm, Mylar Tape Carrier

Documents:

3D Model	Product Specification PS-19902-011-001 (PDF)
Drawing (PDF)	Product Specification PS-19902-015-001 (PDF)
3D Model (PDF)	RoHS Certificate of Compliance (PDF)

Agency Certification

CSA	LR18689
UL	E32244

General

Product Family	Ring and Spade Terminals
Series	<u>19069</u>
Crimp Quality Equipment	Yes
Overview	<u>Solderless Terminals</u>
Product Name	Krimptite
Type	Ring
UPC	800753068216

Physical

Barrel Type	Closed
Insulation	None
Material - Plating Mating	Tin
Material - Plating Termination	Tin
Net Weight	1.349/g
Packaging Type	Adhesive Tape on Reel
Plating min - Mating	2.540µm
Plating min - Termination	2.540µm
Stud Size	8 (M4)
Termination Interface: Style	Crimp or Compression
Wire Size AWG	10, 12
Wire Size mm ²	4.00-6.00

Solder Process Data

Lead-free Process Capability	N/A
------------------------------	-----

Material Info

Engineering Number	C-136-08T
--------------------	-----------

Reference - Drawing Numbers

Product Specification	PS-19902-011-001, PS-19902-015-001
Sales Drawing	190690192-000

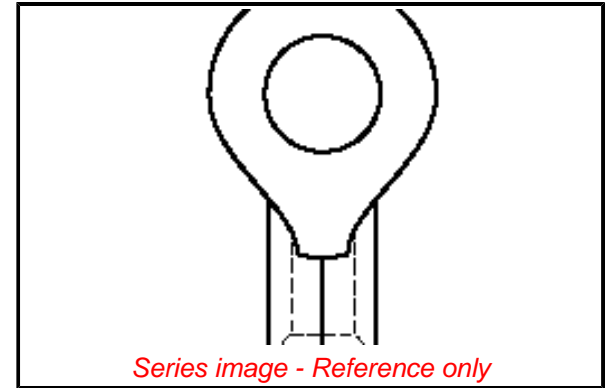

EU ELV

Not Relevant

EU RoHS

Compliant

REACH SVHC

Not Contained Per -
D(2021)4569-DC (8
July 2021)

Halogen-Free

Status

Low-Halogen

For more information, please visit [Contact US](#)

China ROHS

ELV

RoHS Phthalates

China RoHS

Green Image

Not Relevant

Not Contained

Search Parts in this Series

[19069 Series](#)

Application Tooling | FAQ

Tooling specifications and manuals are found by selecting the products below. Crimp Height Specifications are then contained in the Application Tooling Specification document.

Global

Description

Product #

ATP Crimp Dies for the Tape Crimp Module and ATP-101 & 301 Press	190270088
Mini-Mac Applicator	638851000

Mouser Electronics

Authorized Distributor

Click to View Pricing, Inventory, Delivery & Lifecycle Information:

[Molex:](#)

[19069-0235](#)