

Technical Specification

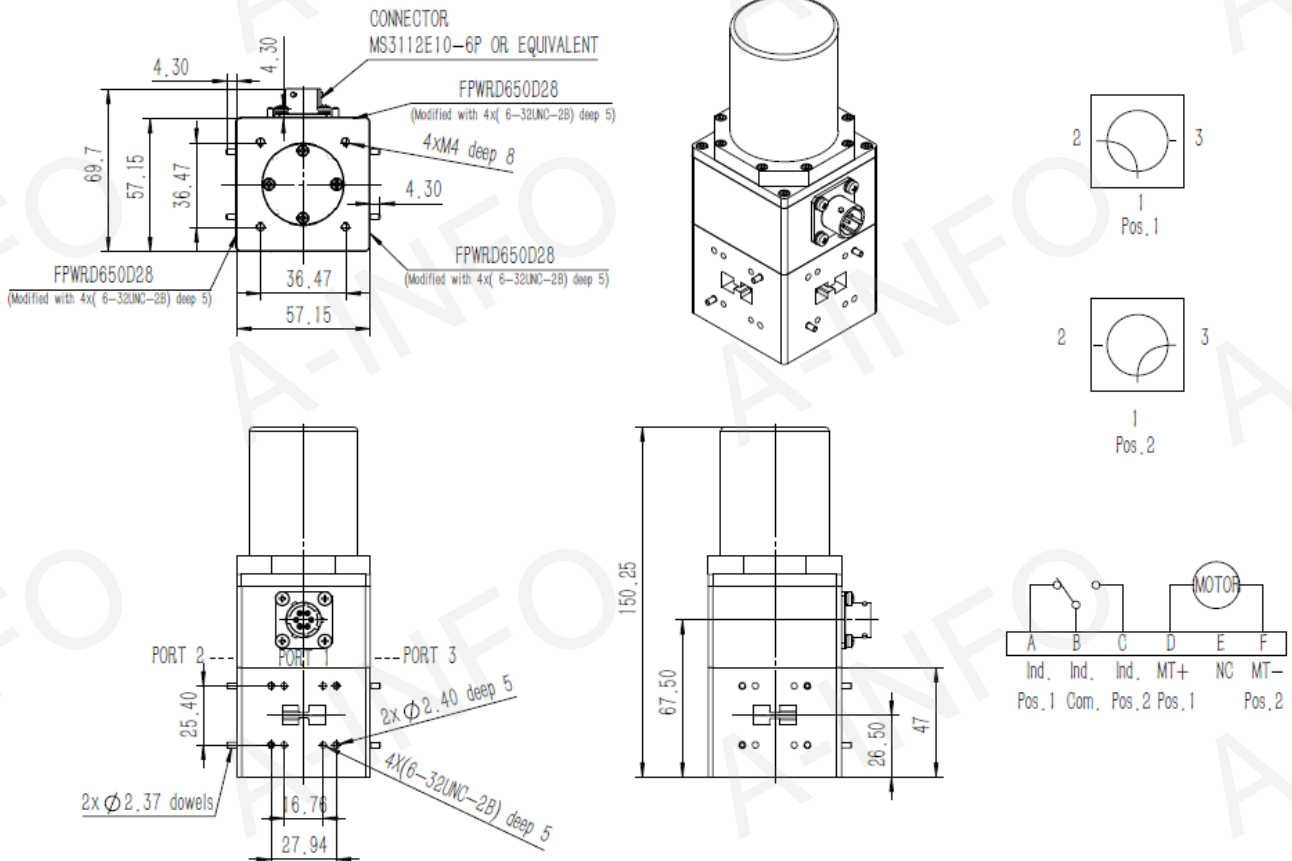

EIA WRD	WRD650
Switch Type	SPDT Latching
Frequency Range(GHz)	6.5-18.0
DC Power Supply(V)	27 ± 3
Current(A)	1.0 Max.
VSWR	1.20 Max.
Isolation(dB)	60 Min.
Insertion Loss(dB)	0.5 Max.
Switching Time(ms)	60 Max.
Average Power(W)	500 Max.
Flange	FPWRD650D28 (Modified with 4x 6-32UNC-2B D5)
Size(mm)	57.15x57.15x150.25
Material	Al
Operating Temperature(°C)	-55 ~ +85
Net Weight(Kg)	Around 1.0

Outline Drawing (Size: mm)



Flange Drawing (Size: mm)

FPWRD650D28

(With two through mounting holes
and two screws holes)

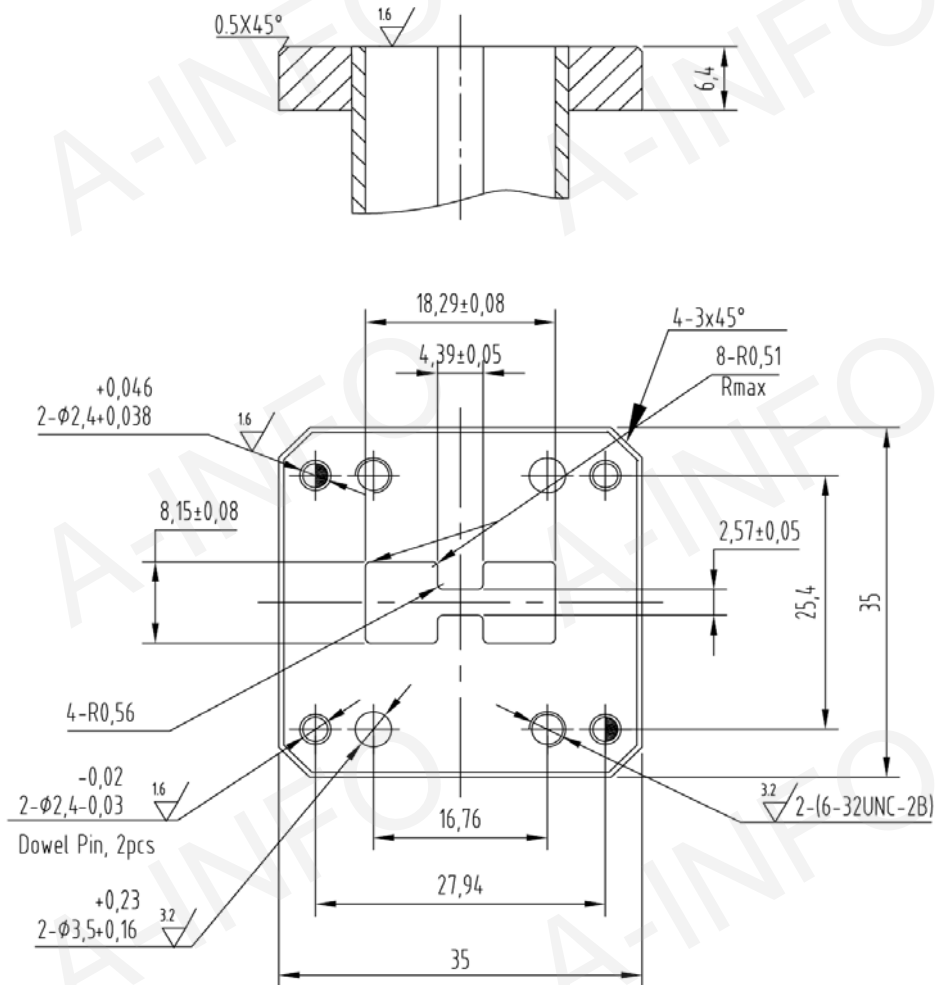

Test Results

I.L. @Pos. 1

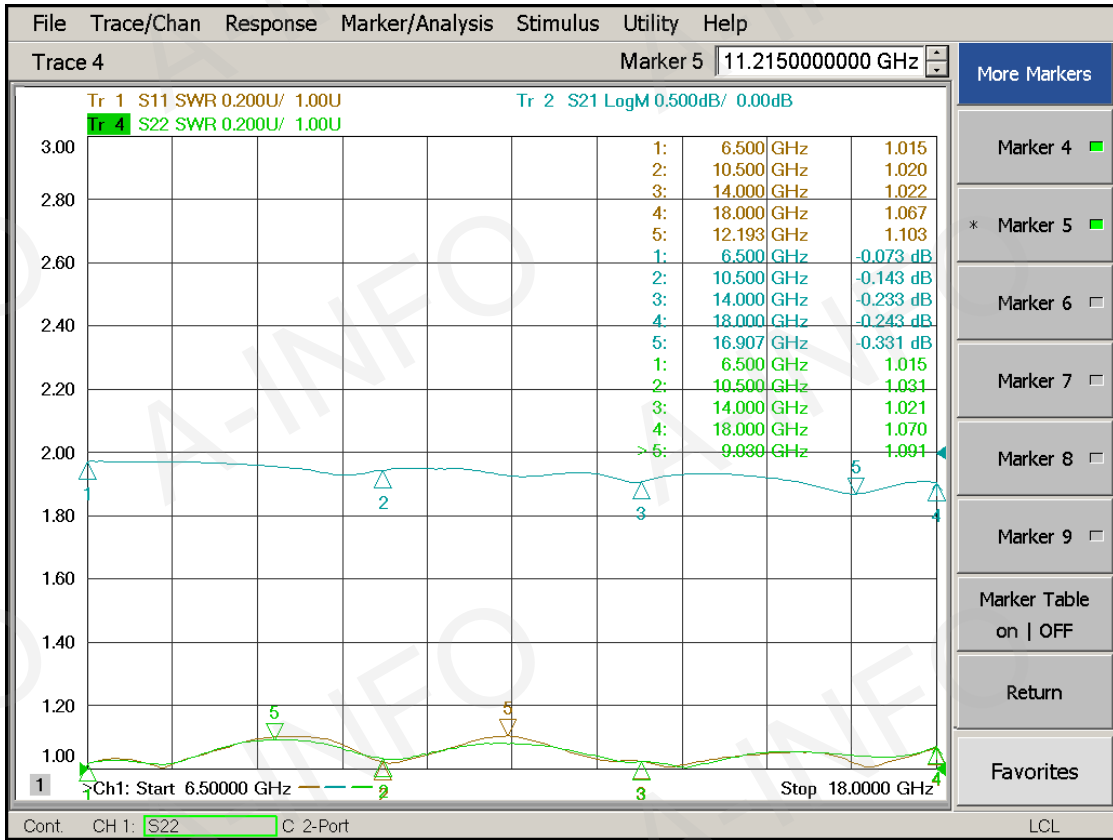

Iso.(From port 1 to port 3) @ Pos. 1

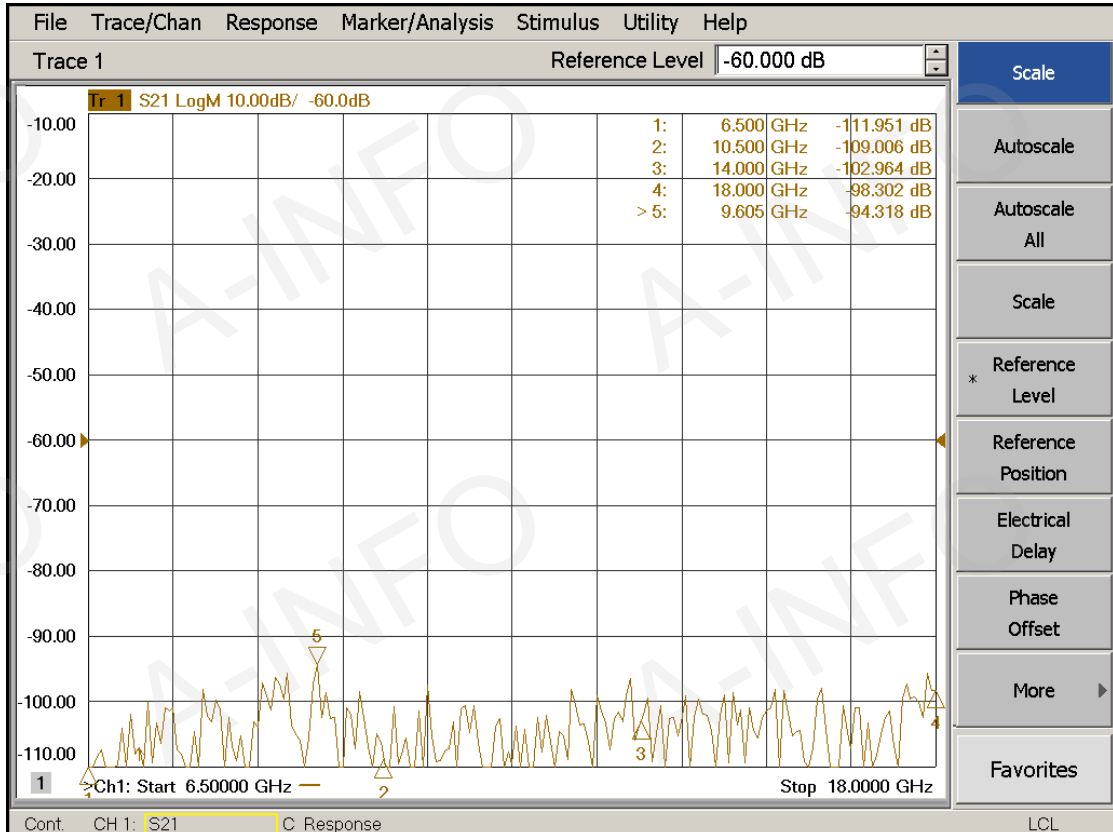

Iso.(From port 2 to port 3) @ Pos. 1

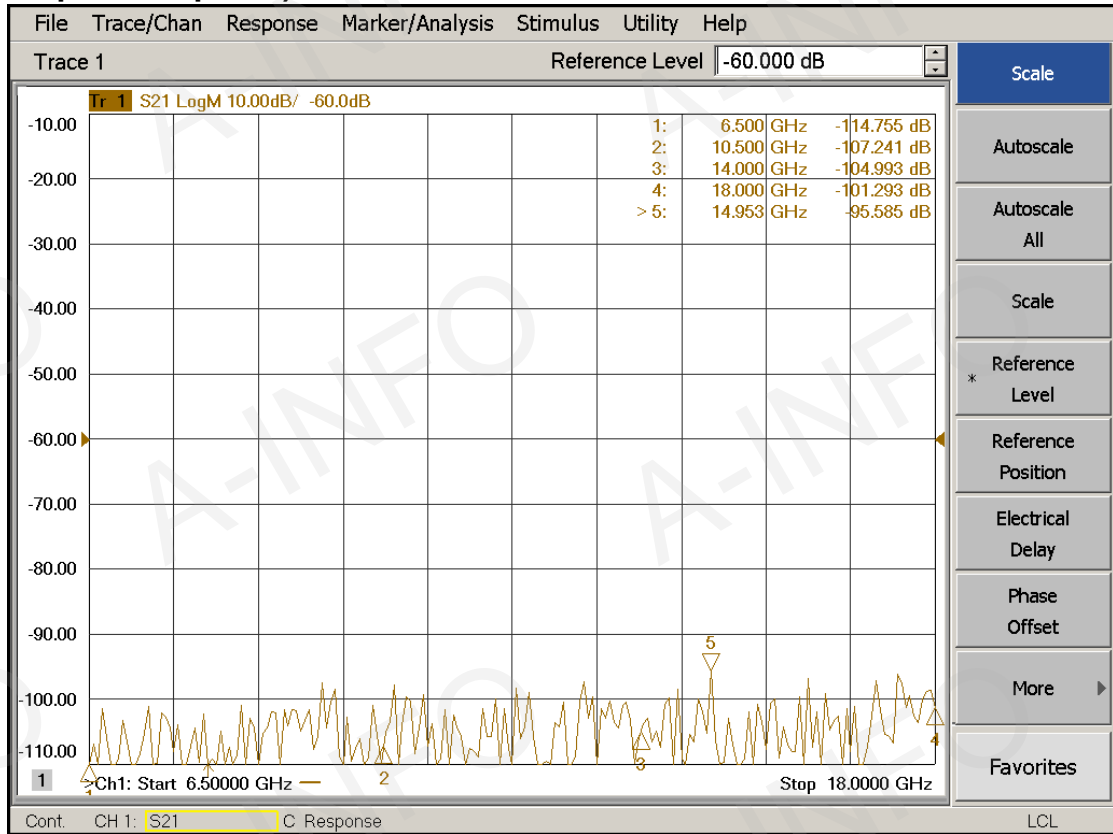

I.L. @ Pos. 2

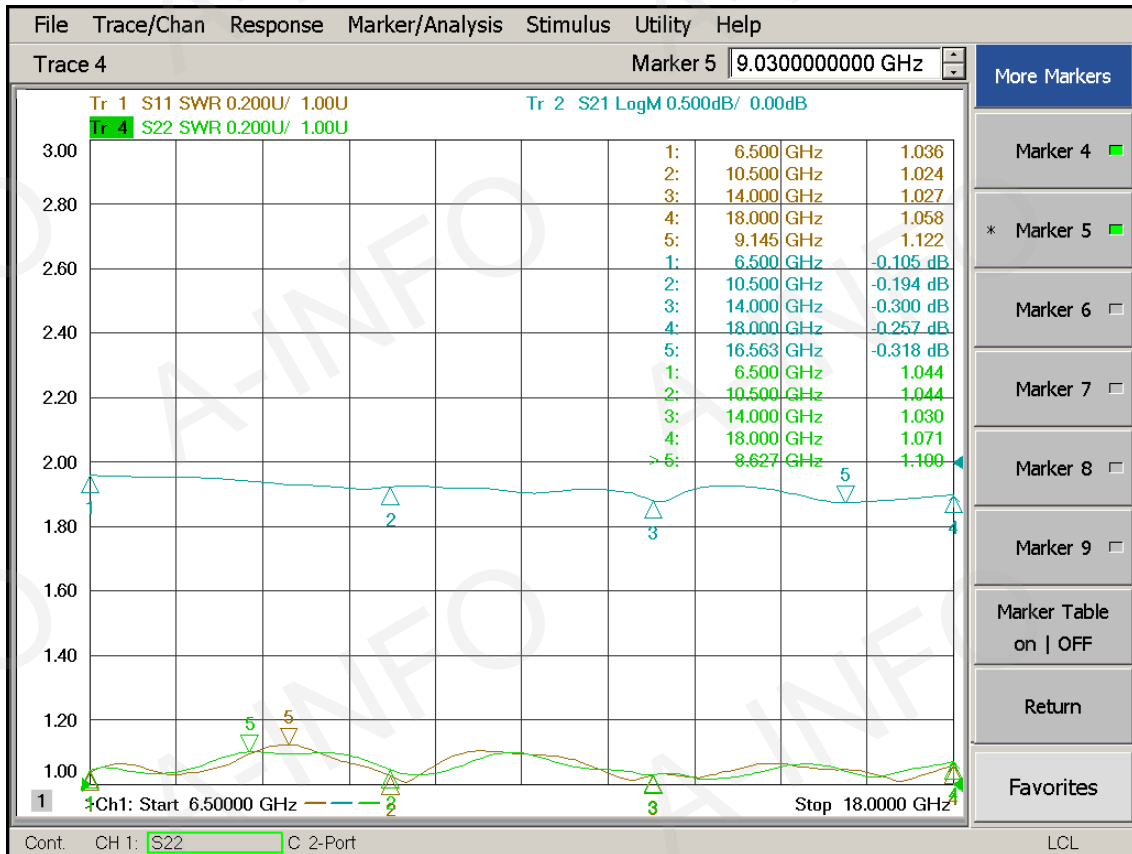

Iso.(From port 1 to port 2) @ Pos. 2

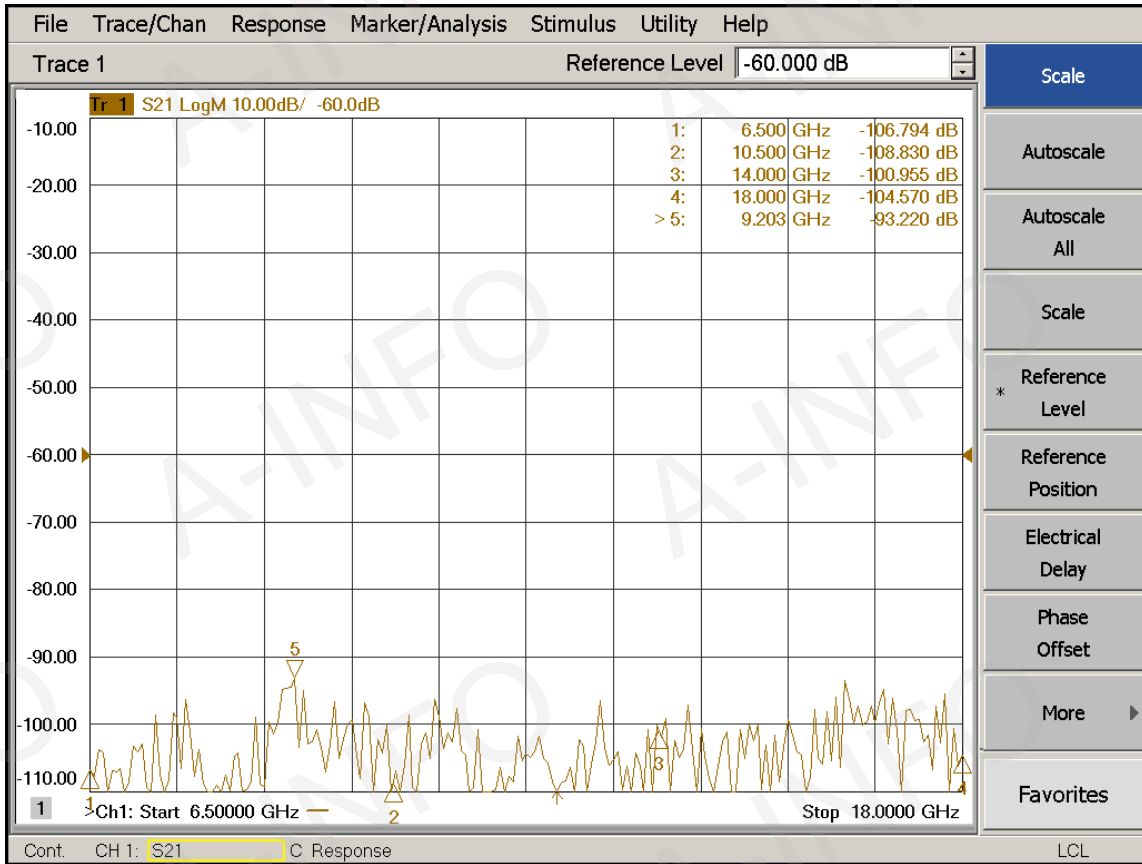

Iso.(From port 3 to port 2) @ Pos. 2

