

DASH NO.	M CODE	MADE FROM
----------	--------	-----------

SD

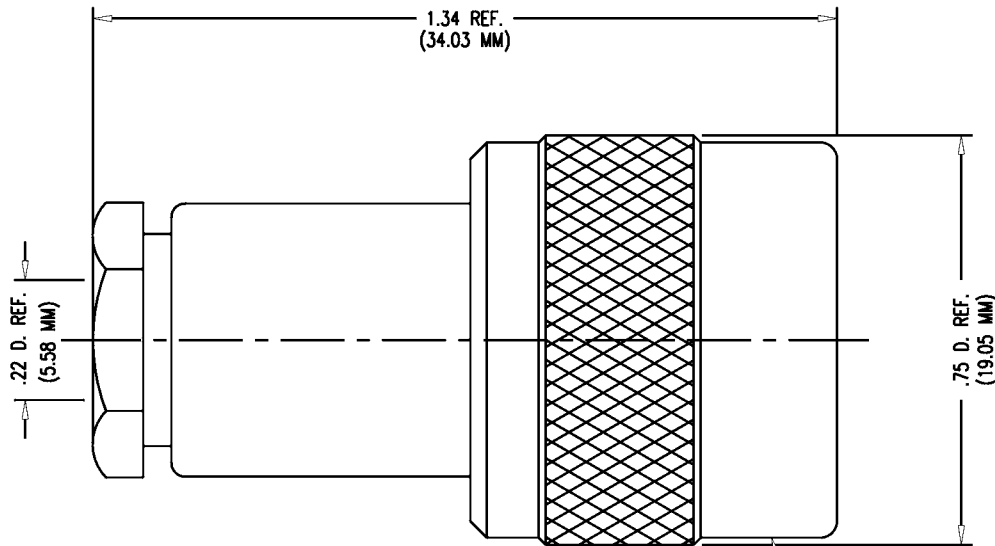

STAMP: 91836 UG-709A/U  
YRWK (DATE CODE)

NOTES:

1. FOR USE WITH RG-58, 141, 142, 223, 303 & 400/U CABLES.
2. FOR CABLING INSTRUCTIONS SEE CP-1015.

REVISIONS	
ISSUE	CHANGES
4	CN 15030 A MJB 12/18/75
5	CN 20724 E GJG 06/13/80
6	CN 37668 C REDRAWN TML 11/11/98
7	CN 37840 E TML 05/26/99
8	CN 37893 E TML 09/10/99
9	CN 39306 E HVN 07/25/05
709AUsdr9	
SCALE 4:1	
APPROX SURFACE AREA	
KD-54-02	
USED ON	
REF: MS90214A	
PLUG, C	
DRAWN	MJB DATE 12/18/75
DESIGN	AT DATE 01/07/76
APPR.	DATE
 ELECTRONICS CO., INC. ROCK HILL, SOUTH CAROLINA 29730	
UG-709A/U	

UG-709A/U

SD

UNLESS OTHERWISE SPECIFIED		
1. TOLERANCES: FRACTIONS & 2 PLACE DECIMALS ± .010 3 PLACE DECIMALS ± .004 ANGLES ± 1° CONCENTRICITY OF ANY 2 DIAMETERS MAY NOT EXCEED HALF THE SUM OF THEIR TOLERANCES.	2. REMOVE ALL BURRS, BREAK SHARP EDGES .005 MAX. 3. NO FILLETS PERMITTED. 4. SURFACE ROUGHNESS 63 MICROINCHES RMS MAX. 5. ALL DIMENSIONS PRIOR TO PLATING. 6. ALL PLATING IN ACCORDANCE WITH KER 10004.	7. ALL LEAD THREADS TO BE CHAMFERED 45° TO ROOT DIAMETER. ★ CRITICAL DIMENSIONS