



# THE GEMINI SERIES

## "A" Series Miniature Rockers

### SPECIFICATIONS

**ELECTRICAL LIFE:** 60,000 operations (For -01function only). All other 30,000.

**CONTACT RATING:** Silver, 5A @ 125 VAC; Gold, 0.4VA @ 20 VDC max.

**INSULATION RESISTANCE:** 1,000 megohms minimum @ 500 VDC.

**DIELECTRIC STRENGTH:** 1,000 volts RMS at sea level initial.

**CONTACT RESISTANCE:** 30 milliohms maximum initial.

**OPERATING TEMPERATURE:** -30°C to +85°C.

UL Available upon request please consult factory.

EPOXY SEALED TERMINALS STANDARD.

### DESIGN

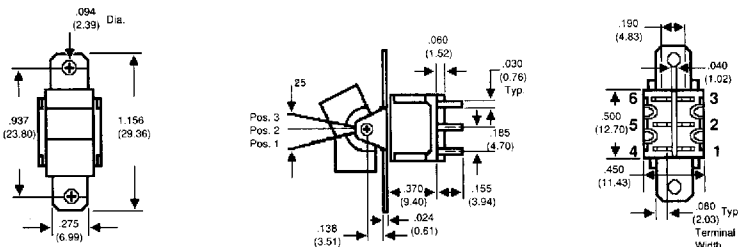
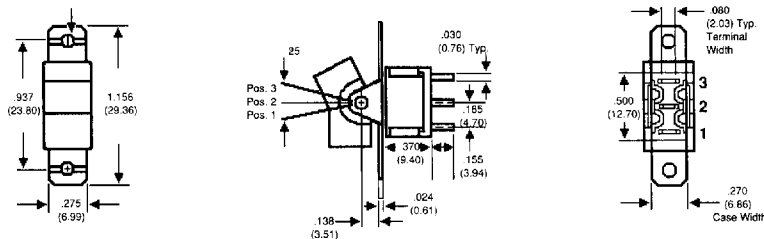
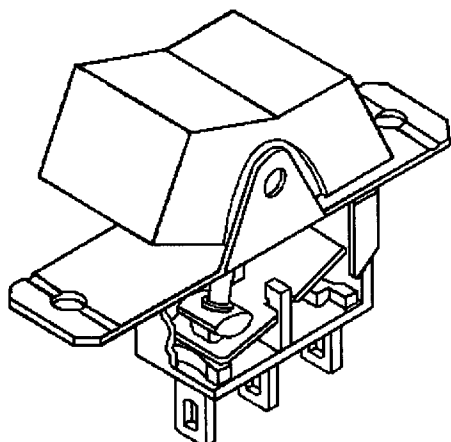

### PART NUMBERING

MODEL	FUNCTION	ACTUATOR	TERMINAL	CONTACT	ACTUATOR COLOR	BEVELED FRAME COLOR
<b>A1</b> Single Pole	<b>ROCKER</b> <b>J1</b> Small <b>J3</b> Large <b>J15</b> Snap-in w/ beveled frame <b>J16</b> Snap-in <b>J50</b> Snap-in <b>J51</b> Snap-in w/beveled frame <b>J52</b> Snap-in w/beveled frame LED <b>PADDLE</b> <b>J2</b> Small <b>J4</b> Large <b>J5</b> Large <b>J60</b> Snap-in <b>J61</b> Snap-in w/beveled frame <b>J62</b> Snap-in w/beveled frame & LED		<b>Z</b> Wire Lug	<b>Q</b> Silver	<b>0</b> Black (Std)	<b>0</b> Black (Std)
<b>A2</b> Double Pole			<b>A</b> Right Angle	<b>B</b> Gold	<b>1</b> Brown	<b>1</b> Brown
<b>01</b> On-On			<b>AV2</b> Vertical Right Angle	<b>G</b> Gold over Silver	<b>2</b> Red	<b>2</b> Red
<b>03</b> On-Off-On			<b>C</b> Printed Circuit		<b>3</b> Orange	<b>3</b> Orange
<b>05</b> (On)-Off-(On)			<b>V5</b> Vertical Right Angle		<b>4</b> Yellow	<b>4</b> Yellow
<b>07</b> On-Off-(On)			<b>V3</b> <b>V4</b> <b>V6</b> Vertical* Support Bracket		<b>5</b> Green	<b>5</b> Green
<b>08</b> On-(On)			<b>V7</b> <b>V8</b> <b>V9</b>		<b>6</b> Blue	<b>6</b> Blue
<b>11</b> On-On-On			<b>W</b> <b>W1</b> <b>W3</b> <b>W4</b> <b>W5</b>		<b>8</b> Gray	<b>8</b> Gray
<b>13</b> On-On-(On)			<b>Z3</b> Quick Connect		<b>9</b> White	<b>9</b> White
<b>15</b> (On)-On-(On)						

See page M14 for SP3T wiring diagram.

# THE GEMINI SERIES

## "A" Series Miniature Rockers

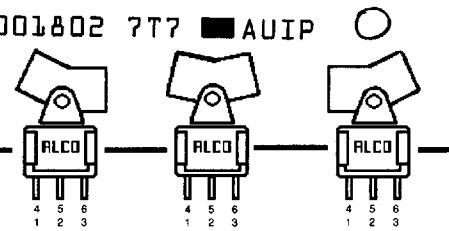

### FUNCTIONS

The following functions available in SP or DP.

<b>01</b> 2 Positions	NONE indicates no mechanical position.	ON	NONE	ON
<b>03</b> 3 Positions		ON	OFF	ON
<b>05</b> 3 Positions	OFF indicates a mechanical position with no electrical connection.	(ON)	OFF	(ON)
<b>07</b> 3 Positions		ON	OFF	(ON)
<b>08</b> 2 Positions	(ON) indicates momentary action.	ON	NONE	(ON)
SPDT, connect terminals:		1-2	—	2-3
DPDT, connect terminals:		1-2 4-5	— —	2-3 5-6

<b>11</b> 3 Positions	ON	ON	ON	
<b>13</b> 3 Positions	ON	ON	(ON)	
<b>15</b> 3 Positions	(ON)	ON	(ON)	
The functions available in DP only:		1-2 4-5	2-3 4-5	2-3 5-6

### WIRING DIAGRAM FOR FUNCTIONS

**11** **13** **15** Pos. 3  
Pos. 2  
Pos. 1

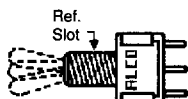

### SINGLE POLE 3 POSITION

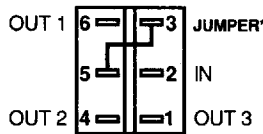

\*SP3T functions achieved with external jumper installed by customer.

### POS. 1

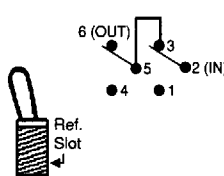

### POS. 2

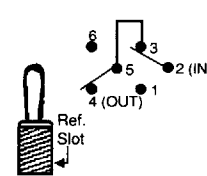

### POS. 3

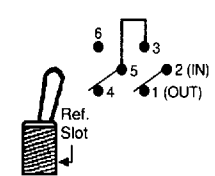

### ACTUATORS

#### **J1** ROCKERS SMALL

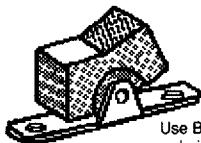

Use Beveled frame B-10 for enhancement (Pg. C40) when ordering with terminations other than C or Z.

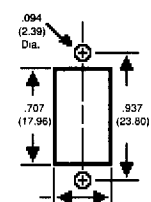
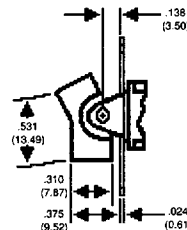
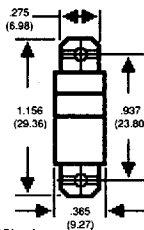

#### **J3** LARGE

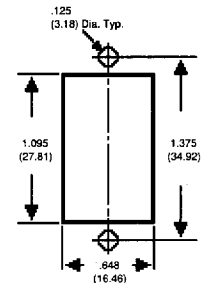
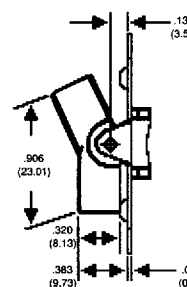
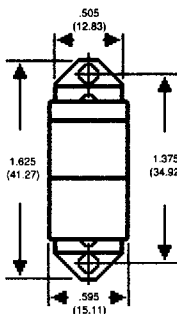
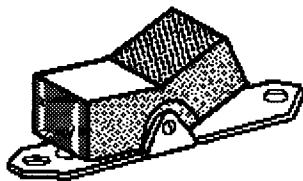

SPECIFICATIONS SUBJECT TO CHANGE WITHOUT NOTICE.

# THE GEMINI SERIES

## "A" Series Miniature Rockers

### ROCKER

**J50**

SNAP-IN

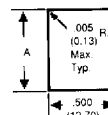
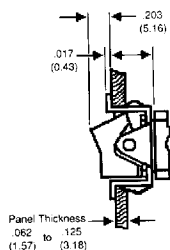
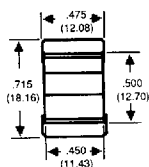
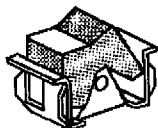

Use Beveled Frame B-20 for enhancement (Pg. C40) when ordering with terminations other than C or Z.

PANEL OPENING

Panel Thickness	.062	.093	.125
"A"	.600-.605	.610-.615	.620-.625

**J51**

SNAP-IN WITH BEVELED FRAME

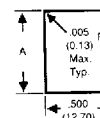
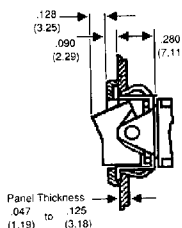
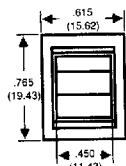
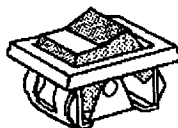

PANEL OPENING

Panel Thickness	.062	.093	.125
"A"	.600-.605	.610-.615	.620-.625

**J52**

SNAP-IN WITH BEVELED FRAME/LED

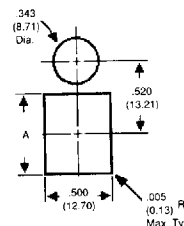
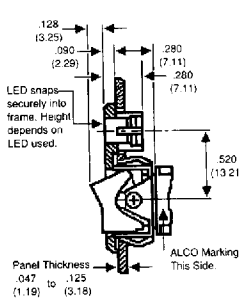
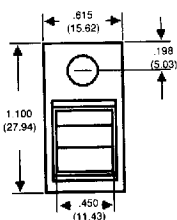
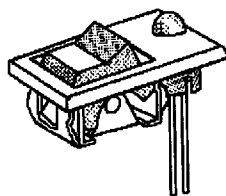

PANEL OPENING

Panel Thickness	.062	.093	.125
"A"	.600-.605	.610-.615	.620-.625

L.E.D.  
Not supplied.

ACCEPTS BL-17 OR EQUIVALENT LED

### PADDLE

**J2**

SMALL

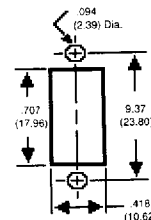
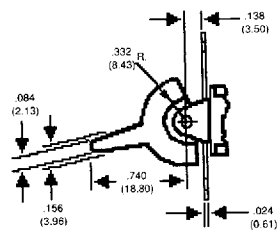
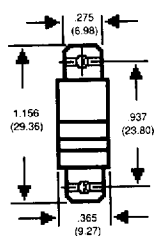
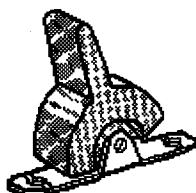

Use Beveled frame B-10 for enhancement (Pg. C40) when ordering with terminations other than C or Z.

SPECIFICATIONS SUBJECT TO CHANGE WITHOUT NOTICE.

# THE GEMINI SERIES

## "A" Series Miniature Rockers

J4

J5

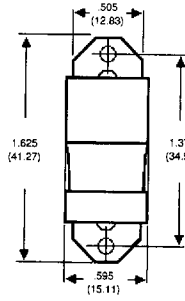
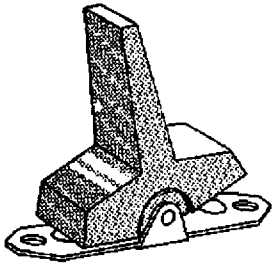

J4  
LARGE

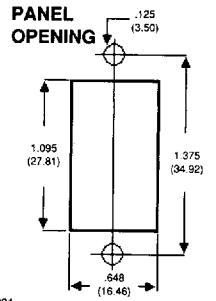
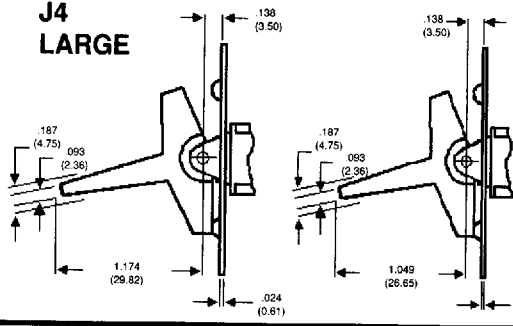

J16 SNAP-IN WITH BEVELED FRAME

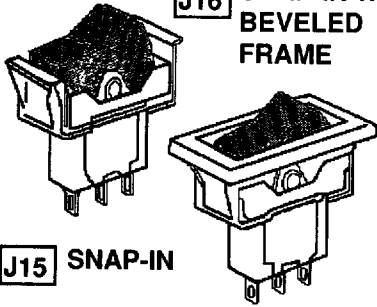

J15 SNAP-IN

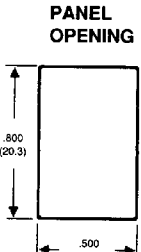
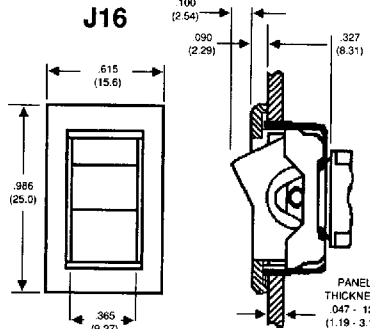
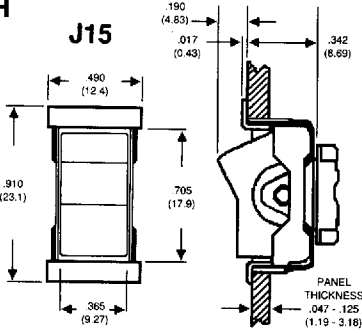

J60

SNAP-IN

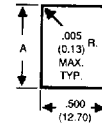
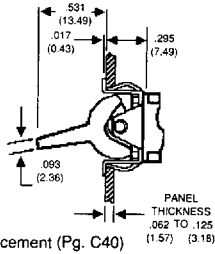
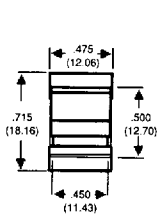
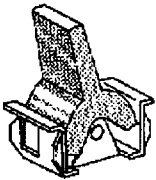

PANEL OPENING

Panel Thickness	.062	.093	.125
"A"	.600-.605	.610-.615	.620-.625

Use Beveled Frame B-20 for enhancement (Pg. C40) when ordering with terminations other than C or Z.

J61

SNAP-IN WITH BEVELED FRAME

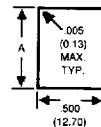
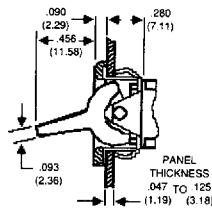
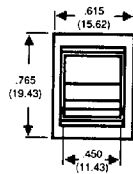
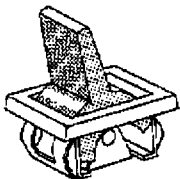

PANEL OPENING

Panel Thickness	.062	.093	.125
"A"	.600-.605	.610-.615	.620-.625

J62

SNAP-IN WITH BEVELED FRAME/LED

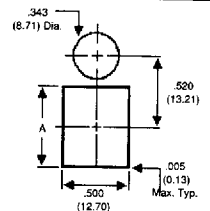
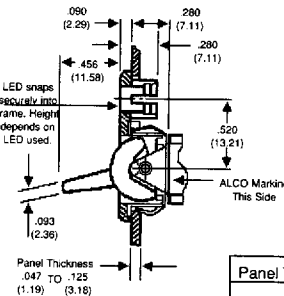
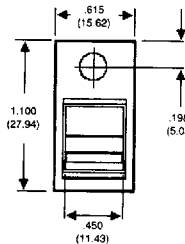
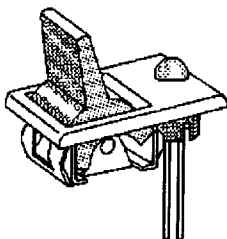

PANEL OPENING

Panel Thickness	.062	.093	.125
"A"	.600-.605	.610-.615	.620-.625

ACCEPTS BL-17 OR EQUIVALENT LED

SPECIFICATIONS SUBJECT TO CHANGE WITHOUT NOTICE.

# THE GEMINI SERIES

## "A" Series Miniature Rockers

### TERMINALS

**Z**

WIRE LUG  
STANDARD

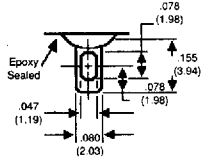

**Z3**

QUICK CONNECT

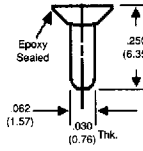

Mates with AMP  
61454 or 60900.

**W W1 W3 W4 W5**

WIRE WRAP

	"A"
W	.750
W1	.964
W3	.425
W4	1.062
W5	1.305

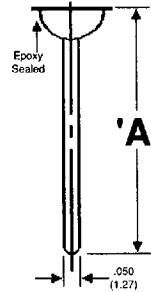

**C**

PRINTED CIRCUIT

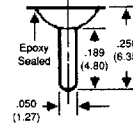

P  
C  
H  
O  
L  
E  
P  
A  
T  
T  
E  
R  
N

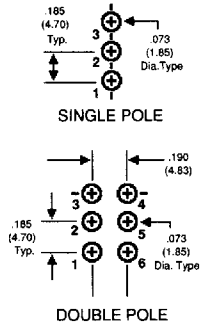

**A**

RIGHT ANGLE  
Single Pole

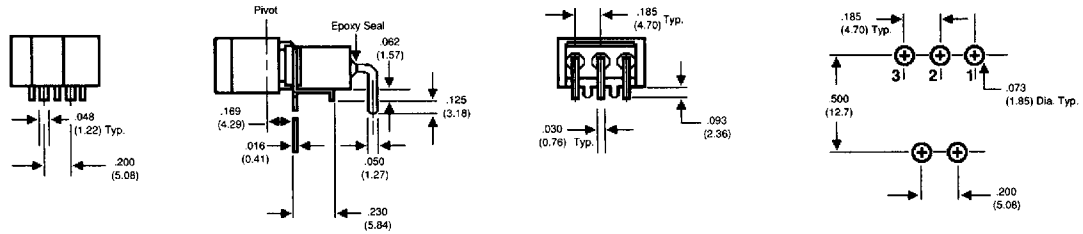

NOTE: TERMINAL NUMBERS VIEWED FROM TOP OF P.C. BOARD.

RIGHT ANGLE  
Double Pole

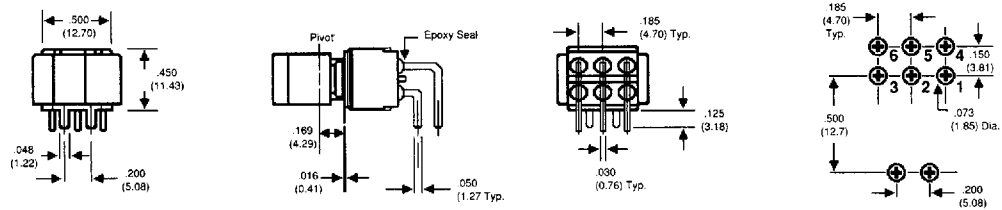

NOTE: TERMINAL NUMBERS VIEWED FROM TOP OF P.C. BOARD.

**AV2**

VERTICAL RIGHT ANGLE  
Single Pole

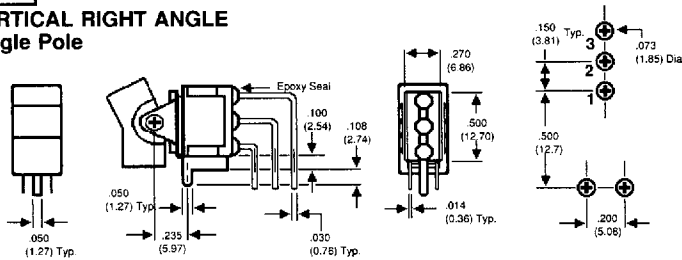

**V5**

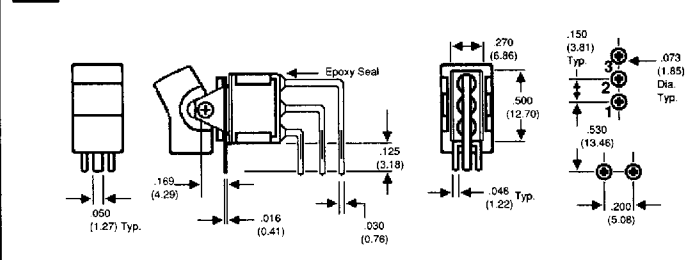

NOTE: TERMINAL NUMBERS VIEWED FROM TOP OF P.C. BOARD.

RIGHT ANGLE  
Double Pole

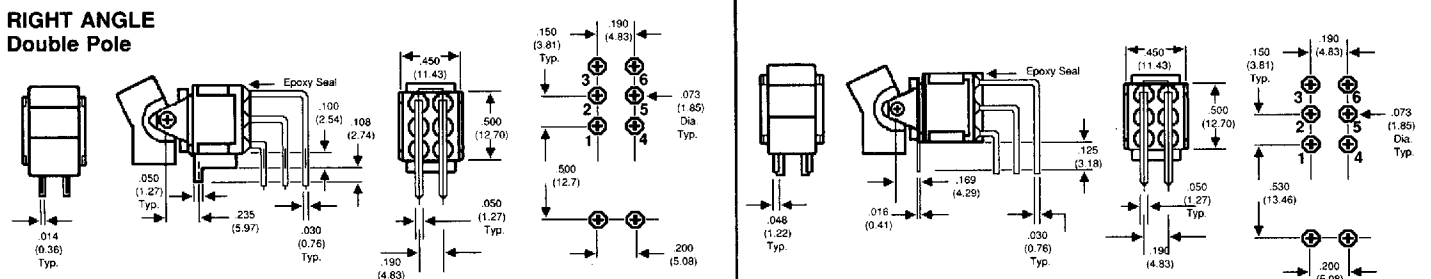

NOTE: TERMINAL NUMBERS VIEWED FROM TOP OF P.C. BOARD. SPECIFICATIONS SUBJECT TO CHANGE WITHOUT NOTICE.



Alcoswitch®

1551 Osgood Street

N. Andover, MA 01845 USA

Tel: (508)685-4371

FAX: (508)686-9545

TLX: 275423

M17



# THE GEMINI SERIES

## "A" Series Miniature Rockers

**V3 V4 V9**

### VERTICAL SUPPORT BRACKET Single Pole

OPTION CODE	Dim. "A"
V3	.460 (11.68)
V4	.630 (16.00)
V9	1.150 (29.21)

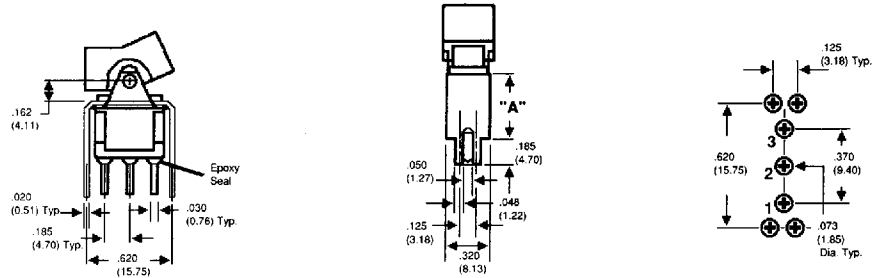

### VERTICAL SUPPORT BRACKET Double Pole

OPTION CODE	Dim. "A"
V3	.460 (11.68)
V4	.630 (16.00)
V9	1.150 (29.21)

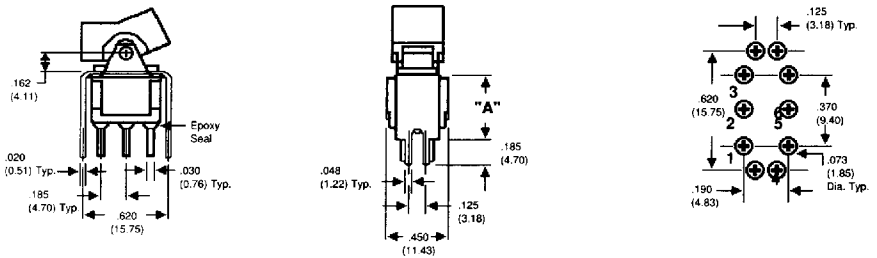

**V6 V7 V8**

### VERTICAL SUPPORT BRACKET Single Pole

OPTION CODE	Dim. "A"
V6	.460 (11.68)
V7	.630 (16.00)
V8	.953 (24.21)

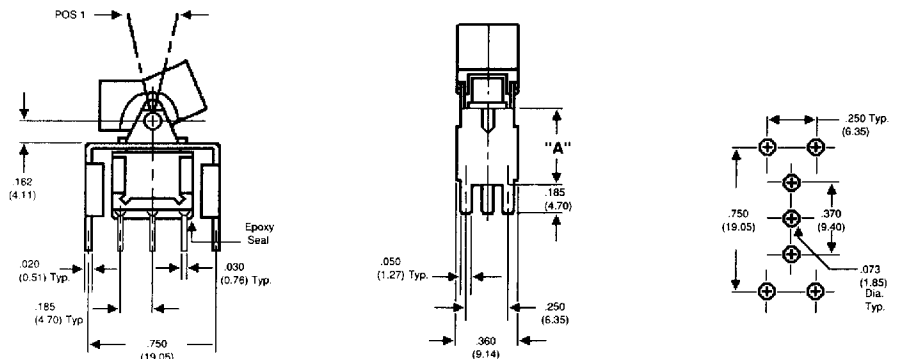

### VERTICAL SUPPORT BRACKET Double Pole

OPTION CODE	Dim. "A"
V6	.460 (11.68)
V7	.630 (16.00)
V8	.953 (24.21)

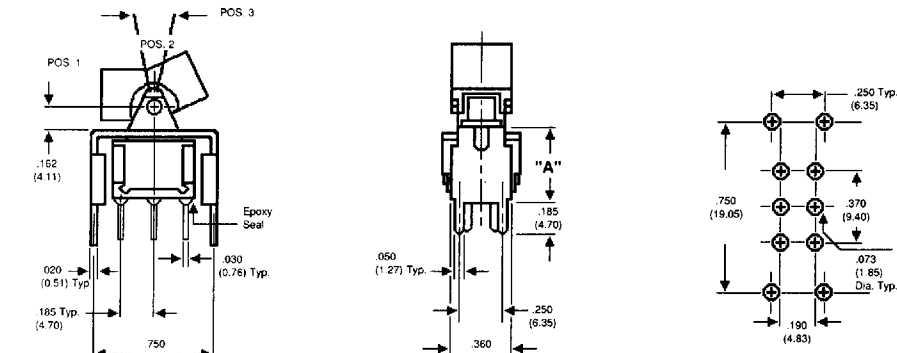

### CONTACTS

**B** CONTACTS: Copper alloy with gold plate over nickel plate, welded button.

TERMINALS: Copper alloy with gold plate.

ELECTRICAL RATING: 0.4VA @ 20 VAC/DC.

**Q** CONTACTS: Copper alloy with silver, welded button.

TERMINALS: Brass or copper strip with silver plate.

ELECTRICAL RATING: 5 A @ 125 VAC, 2 A @ 250 VAC, 5 A @ 28 VDC.  
UL/CSA RATING: 5A @ 125 VAC, 3 @ 250 VAC (Specify "UL" option code)

**G** CONTACTS: Copper alloy with gold plate over silver, welded button.

ELECTRICAL RATING: 0.4 VA @ 20 VAC/DC, or 5 A @ 125 VAC, 2 A @ 250 VAC, 5 A @ 28 VDC.

Note: This contact option can be used for low-level or power switching. If level is above 0.4 VA @ 20 VAC/DC, the switch is rendered usable only for power switching due to arc-removal of gold plate.

UL/CSA RATING: 5A @ 125 VAC, 3 @ 250 VAC (Specify "UL" option code)  
SPECIFICATIONS SUBJECT TO CHANGE WITHOUT NOTICE.



Alcoswitch® 1551 Osgood Street

N. Andover, MA 01845 USA

Tel: (508)685-4371

FAX: (508)686-9545

TLX: 275423