

Part No. Type

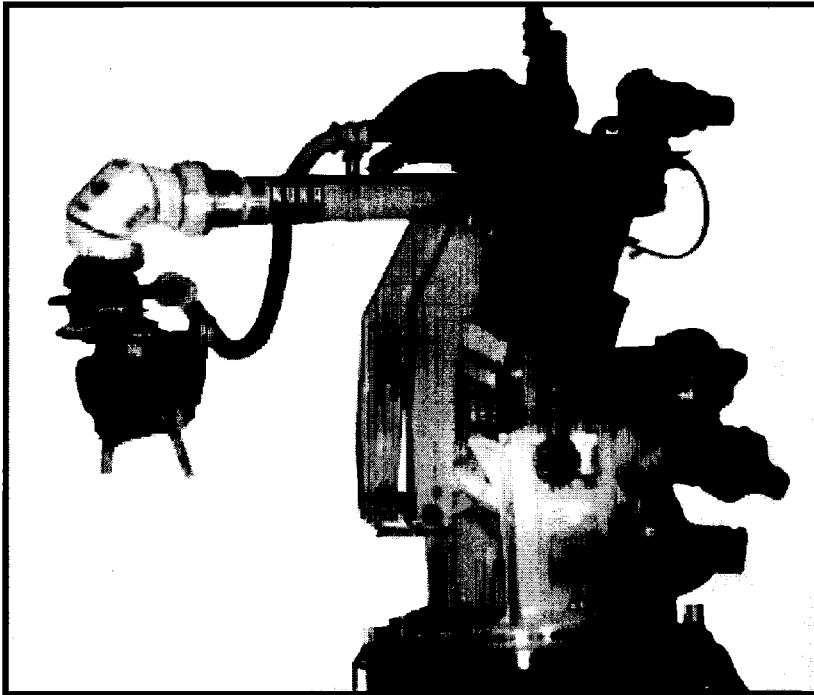

Multi-Contact® primary circuit connectors are used in industrial robotic applications. They are small in size and high in performance. With the use of these connectors, the connecting cables from the switch gear cabinet along the robot arm to the welding transformer can be divided into several sections.

The 3-pole connectors have 2 contacts for phase wires L1 and L2 and one neutral wire. The contacts have crimping or screw clamping connections (only TID-S6/M5 and TID-S8/M8).

In the unplugged condition the assembled plugs and sockets are longitudinally waterproof.

General specifications and ratings:

Rated current: Up to 180 A
 Rated voltage: 630 Vac
 Test Voltage: 3.5 kV (50Hz 1 min.)
 Contact material: CuZn alloy, silver plated
 Housing material: synthetic rubber
 Temperature range: -40°C to +100°C
 (-40°F to +212°F)

- PRODUCT OVERVIEW -

15.0300
TSB/6)

TSB/6
TSB/10
TSB/16
TSB/25



Flanged female plugs, 2-pole + PE.

15.0301
TSB/10)

15.0302
TSB/16)

15.0303
TSB/25)

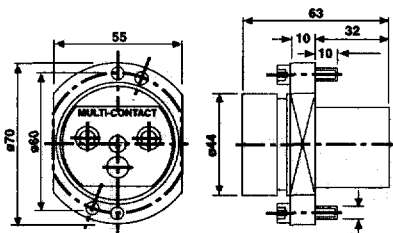

Specifications and ratings:

Rated current TSB/6: 55 max.
 Rated current TSB/10: 80 max.
 Rated current TSB/16: 110 max.
 Rated current TSB/25: 135 max.
 Rated voltage: 630 Vac
 Nom. dia. pin/socket: 6 mm
 Conductor cross-section TSB/6: 6 mm
 Conductor cross-section TSB/10: 10 mm
 Conductor cross-section TSB/16: 16 mm
 Conductor cross-section TSB/25: 25 mm

15.0306
TSS/6)

TSS/6
TSS/10
TSS/16
TSS/25

Flanged male sockets, 2-pole + PE.

15.0307
TSS/10)

15.0308
TSS/16)

15.0309
TSS/25)

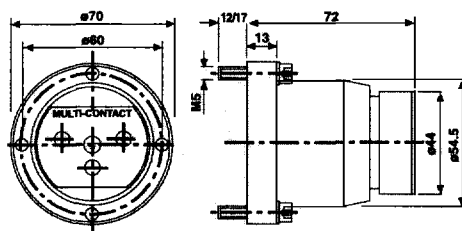

Specifications and ratings:

Rated current TSS/6: 55 max.
 Rated current TSS/10: 80 max.
 Rated current TSS/16: 110 max.
 Rated current TSS/25: 135 max.
 Rated voltage: 630 Vac
 Nom. dia. pin/socket: 6 mm
 Conductor cross-section TSS/6: 6 mm
 Conductor cross-section TSS/10: 10 mm
 Conductor cross-section TSS/16: 16 mm
 Conductor cross-section TSS/25: 25 mm

For complete information on our entire line of robotic application connectors call, fax, or e-mail us today and request our Ho 7b catalog.

Type Part No

Single Contacts - Sockets



BP 6/6
BP 6/10
BP 6/16
BP 6/25

01.0440
(BP 6/6)
01.0441
(BP 6/10)

Dimensions:

Model	B	D	E
BP 6/6	6 mm	4 mm	6 mm
BP 6/10	6 mm	5 mm	8 mm
BP 6/16	6 mm	6 mm	9 mm
BP 6/25	6 mm	8 mm	11 mm

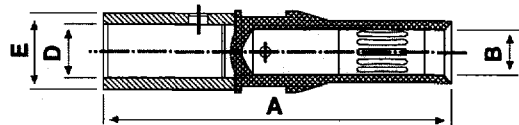

01.0442
(BP 6/16)
01.0443
(BP 6/25)

Single Contacts - Pins



SP 6/6
SP 6/10
SP 6/16
SP 6/25

05.0440
(SP 6/6)
05.0441
(SP 6/10)

Dimensions:

Model	B	D	E
SP 6/6	6 mm	6 mm	4 mm
SP 6/10	6 mm	8 mm	5 mm
SP 6/16	6 mm	9 mm	6 mm
SP 6/25	6 mm	11 mm	8 mm

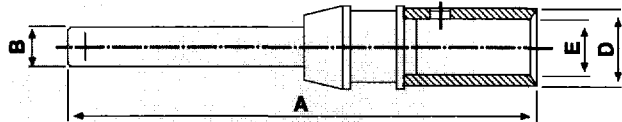

05.0442
(SP 6/16)
05.0443
(SP 6/25)

Pilot Contacts - Sockets

BP 2/0.5-1.5

18.8000



Ratings and specifications:

Rated current: 16 A max.
Rated voltage: 630 V
Nom. diameter pin/socket: 2 mm
Conductor cross section: 0.5 - 1.5 mm²

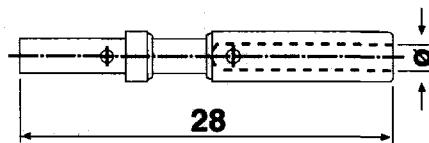

Pilot Contacts - Pins

SP 2/0.5-1.5

18.9000



Ratings and specifications:

Rated current: 16 A max.
Rated voltage: 630 V
Nom. diameter pin/socket: 2 mm
Conductor cross section: 0.5 - 1.5 mm²

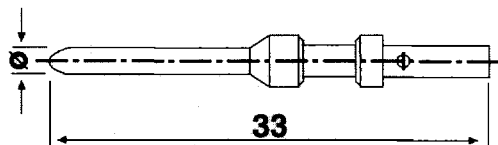

For complete information on our entire line of robotic application connectors call, fax, or e-mail us today and request our Ho 7b catalog.