

## Features

- Low Profile Package
- Ideal for Automated Placement
- Fully Automotive Qualified to AEC-Q101
- Halogen Free. "Green" Device <sup>(Note 1)</sup>
- Moisture Sensitivity Level 1
- Epoxy Meets UL 94 V-0 Flammability Rating
- Lead Free Finish/RoHS Compliant <sup>(Note2)</sup> ("P" Suffix Designates RoHS Compliant. See Ordering Information)

## Maximum Ratings(@ 25°C Unless Otherwise Specified)

Parameter	Symbol	Rating	Unit
DC Power Dissipation at $T_L = 75^\circ\text{C}$	$P_D$	1	W
Maximum Instantaneous Forward Voltage@ $I_F=200\text{mA}$	$V_F$	1.2	V
Operating Junction Temperature Range	$T_J$	-55~175	°C
Storage Temperature Range	$T_{stg}$	-55~175	°C

## Thermal Characteristics(@ 25°C Unless Otherwise Specified)

Parameter	Symbol	Rating	Unit
Typical Thermal Resistance Junction to Lead	$R_{\theta JL}$	100	°C/W
Typical Thermal Resistance Junction to Ambient	$R_{\theta JA}$	120	°C/W
Typical Thermal Resistance Junction to Case	$R_{\theta JC}$	30	°C/W

### Note:

1. Halogen free "Green" products are defined as those which contain <900ppm bromine, <900ppm chlorine (<1500ppm total Br + Cl) and <1000ppm antimony compounds.
2. High Temperature Solder Exemption Applied, see EU Directive Annex 7a.
3. Thermal resistance from junction to ambient and from junction to lead mounted on P.C.B. with 0.4" x 0.4" (10 mm x 10 mm) copper pad areas

### Simplified outline

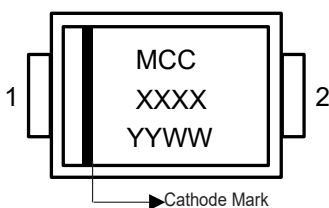

### Graphic symbol

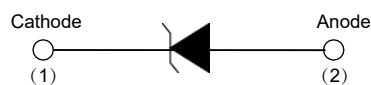

XXXX = Marking code YYWW = Date Code

# 1 Watt Zener Diode 6.2 to 100 Volts

## SMA (DO-214AC) LEAD FRAME

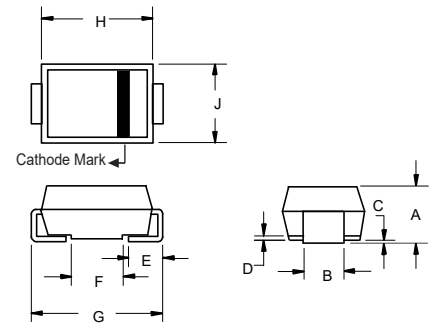

### DIMENSIONS

DIM	INCHES		MM		NOTE
	MIN	MAX	MIN	MAX	
A	0.075	0.096	1.90	2.44	
B	0.050	0.064	1.27	1.63	
C	0.002	0.008	0.051	0.203	
D	---	0.020	---	0.51	
E	0.030	0.060	0.76	1.52	
F	0.065	0.091	1.65	2.32	
G	0.189	0.220	4.80	5.59	
H	0.157	0.187	4.00	4.75	
J	0.090	0.115	2.25	2.92	

### SUGGESTED SOLDER PAD LAYOUT

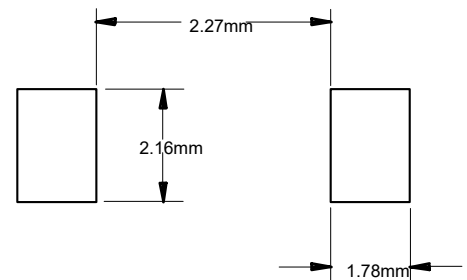

**Electrical Characteristics @ 25°C Unless Otherwise Specified**

Part Number	Nominal Zener Voltage			Test Current	Maximum Dynamic Impedance Resistance			Maximum Reverse leakage Current		Maximum DC Zener Current	Marking Code
	VZ@IZT				IZT	ZZT at IZT	ZZK at IZK	IZK	IR		
	Min(V)	Nom(V)	Max(V)	mA	Ω	Ω	mA	μA	V	mA	
SMAJ4735AQ	5.89	6.2	6.51	41.00	2.0	700	1.00	10.0	3.0	146.0	735A
SMAJ4736AQ	6.46	6.8	7.14	37.00	3.5	700	1.00	10.0	4.0	133.0	736A
SMAJ4737AQ	7.13	7.5	7.88	34.00	4.0	700	0.50	10.0	5.0	121.0	737A
SMAJ4738AQ	7.79	8.2	8.61	31.00	4.5	700	0.50	10.0	6.0	110.0	738A
SMAJ4739AQ	8.65	9.1	9.56	28.00	5.0	700	0.50	10.0	7.0	100.0	739A
SMAJ4740AQ	9.50	10.0	10.50	25.00	7.0	700	0.25	10.0	7.6	91.0	740A
SMAJ4741AQ	10.45	11.0	11.55	23.00	8.0	700	0.25	5.0	8.4	83.0	741A
SMAJ4742AQ	11.40	12.0	12.60	21.00	9.0	700	0.25	5.0	9.1	76.0	742A
SMAJ4743AQ	12.35	13.0	13.65	19.00	10.0	700	0.25	5.0	9.9	69.0	743A
SMAJ4744AQ	14.25	15.0	15.75	17.00	14.0	700	0.25	5.0	11.4	61.0	744A
SMAJ4745AQ	15.20	16.0	16.80	15.50	16.0	700	0.25	5.0	12.2	57.0	745A
SMAJ4746AQ	17.10	18.0	18.90	14.00	20.0	750	0.25	5.0	13.7	50.0	746A
SMAJ4747AQ	19.00	20.0	21.00	12.50	22.0	750	0.25	5.0	15.2	45.0	747A
SMAJ4748AQ	20.90	22.0	23.10	11.50	23.0	750	0.25	5.0	16.7	41.0	748A
SMAJ4749AQ	22.80	24.0	25.20	10.50	25.0	750	0.25	5.0	18.2	38.0	749A
SMAJ4750AQ	25.65	27.0	28.35	9.50	35.0	750	0.25	5.0	20.6	34.0	750A
SMAJ4751AQ	28.50	30.0	31.50	8.50	40.0	1000	0.25	5.0	22.8	30.0	751A
SMAJ4752AQ	31.35	33.0	34.65	7.50	45.0	1000	0.25	5.0	25.1	27.0	752A
SMAJ4753AQ	34.20	36.0	37.80	7.00	50.0	1000	0.25	5.0	27.4	25.0	753A
SMAJ4754AQ	37.05	39.0	40.95	6.50	60.0	1000	0.25	5.0	29.7	23.0	754A
SMAJ4755AQ	40.85	43.0	45.15	6.00	70.0	1500	0.25	5.0	32.7	22.0	755A
SMAJ4756AQ	44.65	47.0	49.35	5.50	80.0	1500	0.25	5.0	35.8	19.0	756A
SMAJ4757AQ	48.45	51.0	53.55	5.00	95.0	1500	0.25	5.0	38.8	18.0	757A
SMAJ4758AQ	53.20	56.0	58.80	4.50	110.0	2000	0.25	5.0	42.6	16.0	758A
SMAJ4759AQ	58.90	62.0	65.10	4.00	125.0	2000	0.25	5.0	47.1	14.0	759A
SMAJ4760AQ	64.60	68.0	71.40	3.70	150.0	2000	0.25	5.0	51.7	13.0	760A
SMAJ4761AQ	71.25	75.0	78.75	3.30	175.0	2000	0.25	5.0	56.0	12.0	761A
SMAJ4762AQ	77.90	82.0	86.10	3.00	200.0	3000	0.25	5.0	62.2	11.0	762A
SMAJ4763AQ	86.45	91.0	95.55	2.80	250.0	3000	0.25	5.0	69.2	10.0	763A
SMAJ4764AQ	95.00	100.0	105.00	2.50	350.0	3000	0.25	5.0	76.0	9.0	764A

**Curve Characteristics**

Fig. 1 - Power Derating Curve

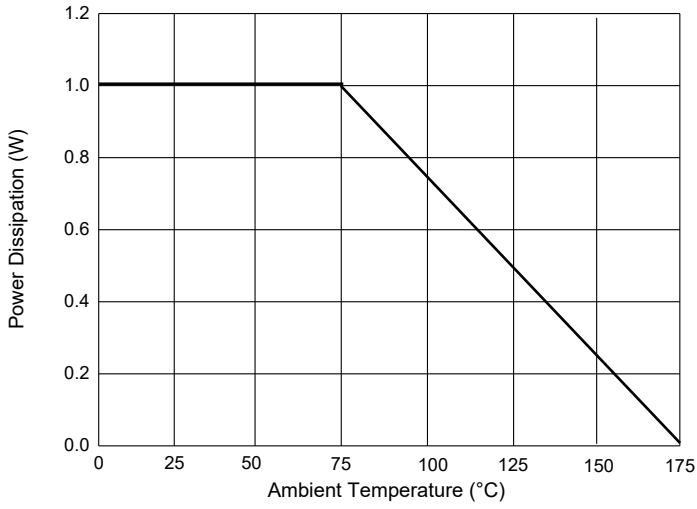

Fig. 2 - Typical Forward Characteristics

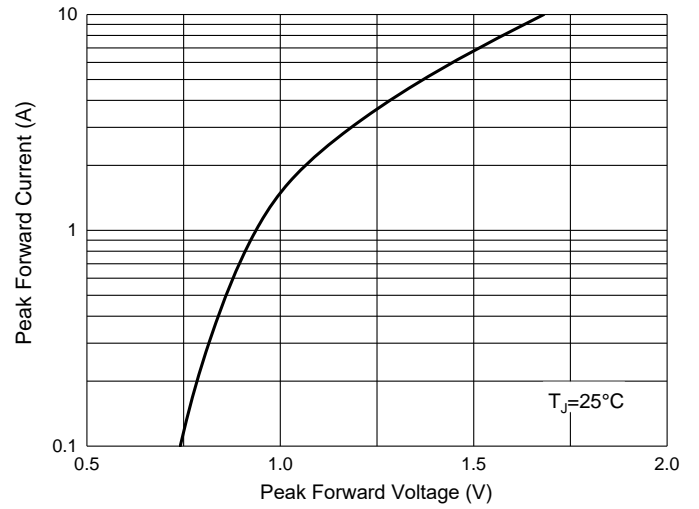

Fig. 3 - Pulse Waveform

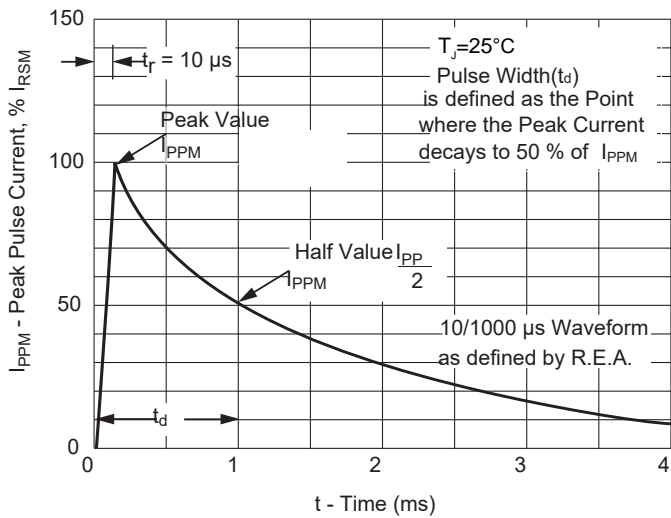
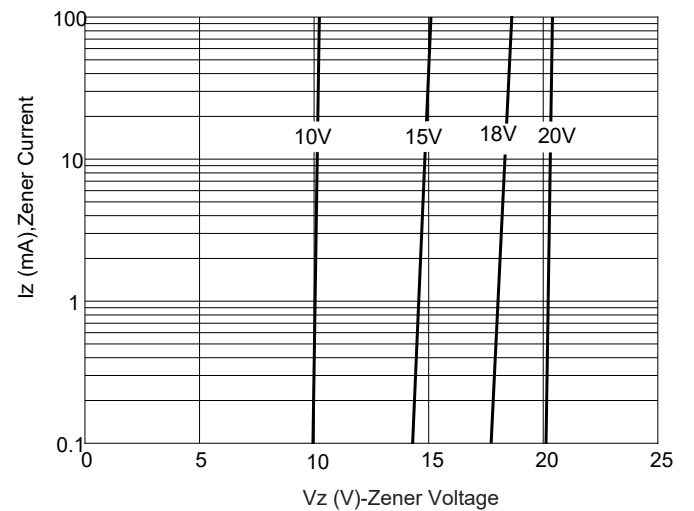

Fig. 4 - Typical Zener Breakdown Characteristics



## Ordering Information

Device	Packing
Part Number-TP	Tape&Reel:7.5Kpcs/Reel

### \*\*\*IMPORTANT NOTICE\*\*\*

**Micro Commercial Components Corp.** reserves the right to make changes without further notice to any product herein to make corrections, modifications, enhancements, improvements, or other changes. **Micro Commercial Components Corp.** does not assume any liability arising out of the application or use of any product described herein; neither does it convey any license under its patent rights, nor the rights of others. The user of products in such applications shall assume all risks of such use and will agree to hold **Micro Commercial Components Corp.** and all the companies whose products are represented on our website, harmless against all damages. **Micro Commercial Components Corp.** products are sold subject to the general terms and conditions of commercial sale, as published at <https://www.mccsemi.com/Home/TermsAndConditions>.

### \*\*\*LIFE SUPPORT\*\*\*

MCC's products are not authorized for use as critical components in life support devices or systems without the express written approval of Micro Commercial Components Corporation.

### \*\*\*CUSTOMER AWARENESS\*\*\*

Counterfeiting of semiconductor parts is a growing problem in the industry. Micro Commercial Components (MCC) is taking strong measures to protect ourselves and our customers from the proliferation of counterfeit parts. MCC strongly encourages customers to purchase MCC parts either directly from MCC or from Authorized MCC Distributors who are listed by country on our web page cited below. Products customers buy either from MCC directly or from Authorized MCC Distributors are genuine parts, have full traceability, meet MCC's quality standards for handling and storage. **MCC will not provide any warranty coverage or other assistance for parts bought from Unauthorized Sources.** MCC is committed to combat this global problem and encourage our customers to do their part in stopping this practice by buying direct or from authorized distributors.