

SMA3300-9035

SMA Plug Solder Right Angle 50Ω

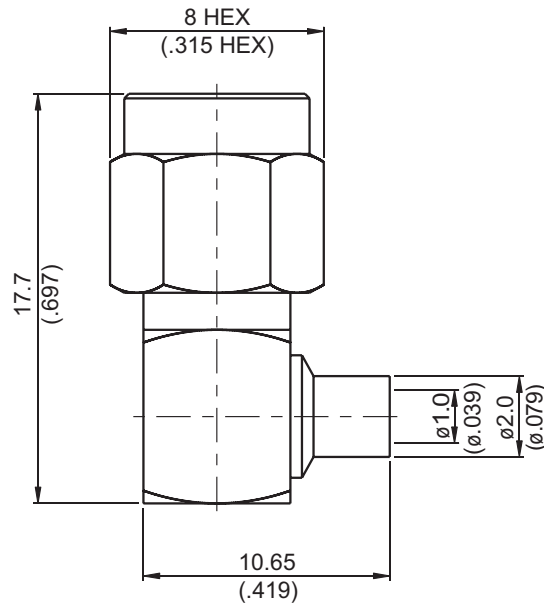

Parts	Material	Plating (Micro-inch)
Cover	Brass	Gold 5 Over Nickel 50 Over Copper 50
Renbrock Ring	Beryllium Copper	Tin-Zinc-Copper-Alloy 100 Over Copper 50
Gasket	Silicon	
Contact Pin	Brass	Gold 20 Over Nickel 50 Over Copper 50
Insulator	Teflon	
Barrel	Brass	Gold 5 Over Nickel 50 Over Copper 50
Body	Brass	Gold 5 Over Nickel 50 Over Copper 50
Coupling Nut	Brass	Gold 5 Over Nickel 50 Over Copper 50

Weight: 4.46 g

Suitable Cables: Semi-rigid.034

This part number complies with RoHS.

Notice: JYEBAO reserves the right to make modifications deemed appropriate.

## CABLE ASSEMBLY INSTRUCTION

SMA3300-9035

JYE BAO CO., LTD.

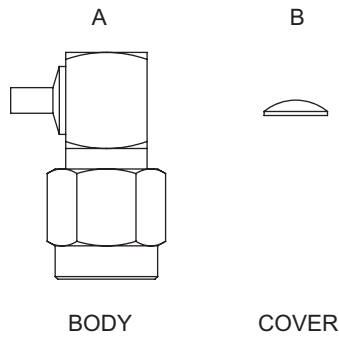

DIAGRAM	ASSEMBLY INSTRUCTION
<p style="text-align: center;">3.3 [.130]</p>	<p>Step 1: STRIP AS SHOWN.</p>
<p style="text-align: center;">Y contact pin A</p>	<p>Step 2: SLIDE CENTER CONDUCTOR ON THE CONTACT PIN OF CONNECTOR "A", AND SOLDER IN "Y".</p>
<p style="text-align: center;">ST-035      S X      ST-011 ST-008</p>	<p>Step 3: PUT CABLE INTO SOLDERING FIXTURE "ST-008", AND LOCK IT. PUT CONNECTOR AS SHOWN.</p> <p>Step 4: SCREW LOCATOR TOOL "ST-011" TO THE POSITION AS SHOWN IN "S", AND SOLDER IN "X".</p>
<p style="text-align: center;">FORCE JIG      B</p>	<p>Step 5: PRESS ON THE TOP OF "B" WITH JIGS.</p>

This part number complies with RoHS.

Notice: JYEBAO reserves the right to make modifications deemed appropriate.