

DASH NO.	M CODE	MADE FROM
----------	--------	-----------

# GSD

KN-81-09-M06

REVISIONS	
ISSUE	CHANGES
0	ER 33412 JCA 10/30/91
1	CN 38466 C BDH 12/15/01

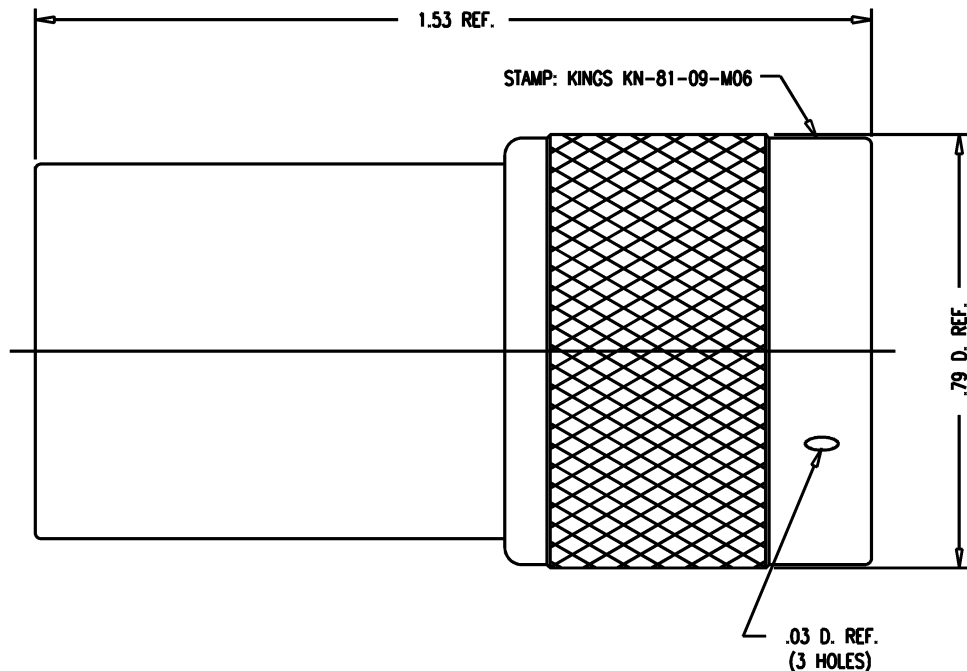

**NOTES:**

- MATERIALS:**  
 INSULATORS: TEFLON, ASTM-D-1457  
 GASKETS: SILICONE RUBBER, QQ-R-765  
 C-RING } PHOS. BRONZE, QQ-B-750  
 CONTACT F }  
 ALL OTHER METAL PARTS: BRASS, QQ-B-626
- FINISHES:**  
 CONTACTS: SILVER PLATE PER QQ-S-365  
 ALL METAL PARTS: KINGS TARNISH RESISTANT FINISH (TR-5)

SCALE 4:1	
APPROX SURFACE AREA	
USED ON	
REF:	
ASSY, N, M	
DRAWN JCA	DATE 10/30/91
DESIGN JJ	DATE 10/30/91
APPR.	DATE



ROCK HILL, SOUTH CAROLINA 29730

KN-81-09-M06

# GSD

UNLESS OTHERWISE SPECIFIED		
1. TOLERANCES: FRACTIONS & 2 PLACE DECIMALS ± .010 3 PLACE DECIMALS ± .004 ANGLES ± 1° CONCENTRICITY OF ANY 2 DIAMETERS MAY NOT EXCEED HALF THE SUM OF THEIR TOLERANCES.	2. REMOVE ALL BURRS, BREAK SHARP EDGES .005 MAX. 3. NO FILLETS PERMITTED. 4. SURFACE ROUGHNESS 63 MICRONS RMS MAX. 5. ALL DIMENSIONS PRIOR TO PLATING. 6. ALL PLATING IN ACCORDANCE WITH KER 10004.	7. ALL LEAD THREADS TO BE CHAMFERED 45° TO ROOT DIAMETER. * CRITICAL DIMENSIONS