

SMB3105-0178

SMB Plug Crimp For Bulkhead 50Ω

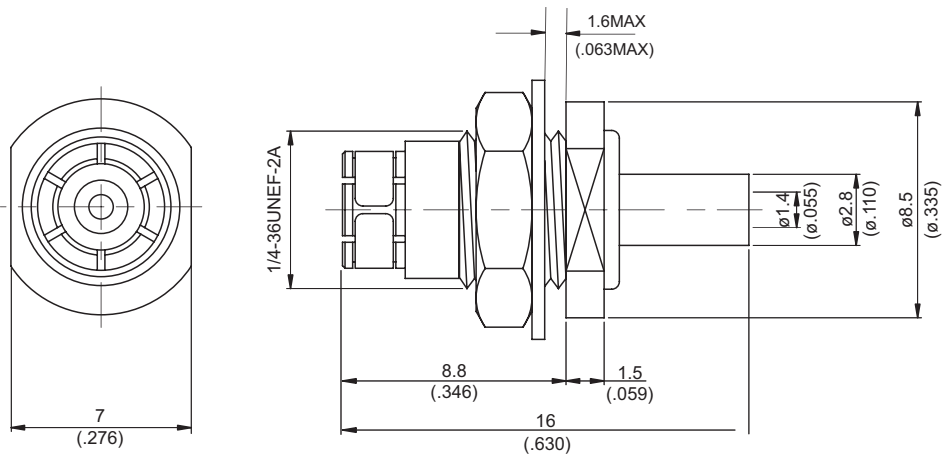

MOUNTING HOLE :

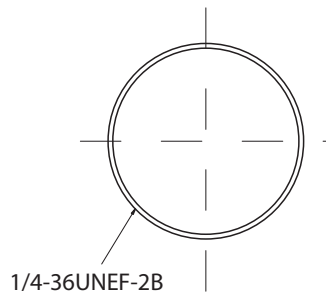

Parts	Material	Plating (Micro-inch)
Contact Pin	Beryllium Copper	Gold 20 Over Nickel 50 Over Copper 50
Insulator	Teflon	
Body	Brass	Gold 5 Over Nickel 50 Over Copper 50

Weight: 1.82 g

Suitable Cables: RG178, RG196, RG178-FEP

This part number complies with RoHS.

Notice: JYEBAO reserves the right to make modifications deemed appropriate.

CABLE ASSEMBLY INSTRUCTION

SMB3105-0178

JYE BAO CO., LTD.

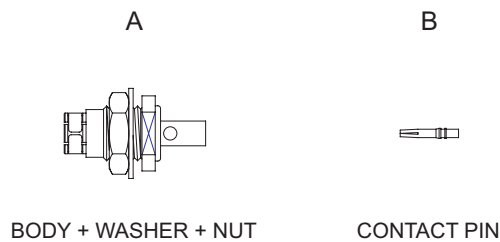

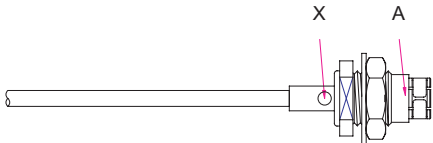

DIAGRAM	ASSEMBLY INSTRUCTION
	<p>Step 1: STRIP AS SHOWN .</p>
	<p>Step 2: PUT PIN " B " ON CENTER CONDUCTOR AND CRIMP IN " Y " .</p>
	<p>Step 3: PUT PREPARED CABLE INTO CONNECTOR BODY " A " AND SOLDER IN " X " .</p>

This part number complies with RoHS.

Notice: JYEBAO reserves the right to make modifications deemed appropriate.