

Switch Type Multi Control Device > RKJXS Series > RKJXS1004001

Series Common Info

8-directional Stick Switch (with Center-push Function)

RKJXS Series

- | Photo | Dimensions | Land Dimensions |
- | Output Relation Chart between Lever Position and ON Position | Circuit Diagram |
- | Packing Specifications | Soldering Condition |

PRINT

Part number		RKJXS1004001	
Number of operating shafts		Single-shaft	
Shaft material		Resin	
Switch ON position (8-direction)		Each direction 7° max.	
Travel (Center push)		0.3±0.2mm	
Operating temperature range		-20℃ to +70℃	
Ratings (max.) (Resistive load)		10mA 5V DC	
Electrical performance	Output voltage	1V max. at 1mA 5V DC (Resistive load)	
			
	Directional resolution	8-direction	
	Insulation resistance	50MΩ min. 50V DC	
	Voltage proof	50V AC for 1 minute or 60V AC for 2s	
Mechanical performance	Directional operating force	0.8±0.5N	
	Push operating force	2.5±1.5N	
	Actuator strength	Push/pull directions	30N (Push), 10N (Pull)
		Operating direction	20N
Durability	Operating life	Directions	Each direction 500,000 cycles
		Center push	500,000 cycles
Environmental performance	Cold	-40±2℃ for 96h	
	Dry heat	85±2℃ for 96h	

60±2°C, 90 to 95%RH for 96h

Photo



Viewed from mounting side.

Unit: mm

Technical drawing of a mechanical part with dimensions and labels. The drawing shows a cross-section of a part with a central square hole. The outer dimensions are 12.1 mm by 12.1 mm. The inner square hole has a side length of 9.1 mm. The thickness of the part is 6.6 mm. The drawing includes labels for various features: 1, 2, 3, 4, 5, 6, 7, 8, 9, 10, 11, 12, 13, 14, 15, 16, 17, 18, 19, 20, 21, 22, 23, 24, 25, 26, 27, 28, 29, 30, 31, 32, 33, 34, 35, 36, 37, 38, 39, 40, 41, 42, 43, 44, 45, 46, 47, 48, 49, 50, 51, 52, 53, 54, 55, 56, 57, 58, 59, 60, 61, 62, 63, 64, 65, 66, 67, 68, 69, 70, 71, 72, 73, 74, 75, 76, 77, 78, 79, 80, 81, 82, 83, 84, 85, 86, 87, 88, 89, 90, 91, 92, 93, 94, 95, 96, 97, 98, 99, 100. The drawing also includes a scale bar and a title block.

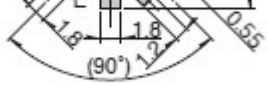

A slant line part hoes the solder land black part:
Do not solder and wiring for electrical contact

Output Relation Chart between Lever Position and ON Position

Terminal The direction of the operation	1	2	3	4	C	P	E
a	△	△	●	△	●	●	○
b	△	△	●	●	●	●	○
c	△	△	△	●	●	●	○
d	●	△	△	●	●	●	○
e	●	△	△	△	●	●	○
f	●	●	△	△	●	●	○
g	△	●	△	△	●	●	○
h	△	●	●	△	●	●	○
Center Push	△	△	△	△	●	●	○
Free	○	○	○	○	○	△	○

●: ON
△: OFF
●: Not specified
※ Term.
E: Ground terminal

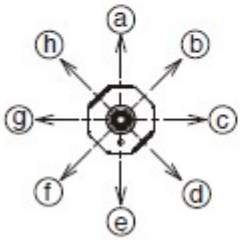

Operating direction
of lever.

Circuit Diagram

Operating direction
of lever.
(contact points)

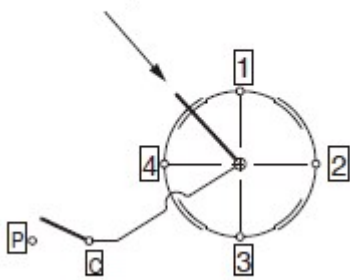

Packing Specifications

Taping

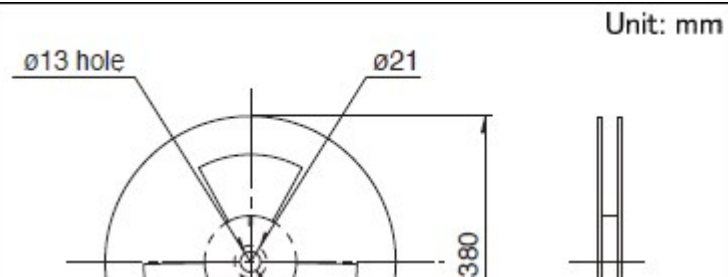

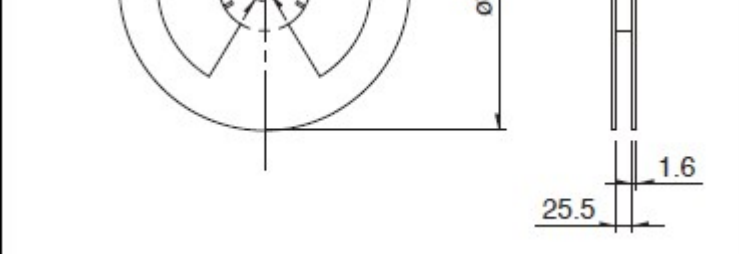

Number of packages (pcs.)	1 reel	950
	1 case / Japan	3,800
	1 case / export packing	3,800
Tape width (mm)		24
Export package measurements (mm)		405×405×162

Soldering Condition

Example of Reflow Soldering Condition

1. Heating method:

Double heating method with infrared heater.

2. Temperature measurement:

Thermocouple 0.1 to 0.2 Φ CA (K) or CC (T) at solder joints (copper foil surface). A heat resisting tape should be used to fix thermocouple.

3. Temperature profile

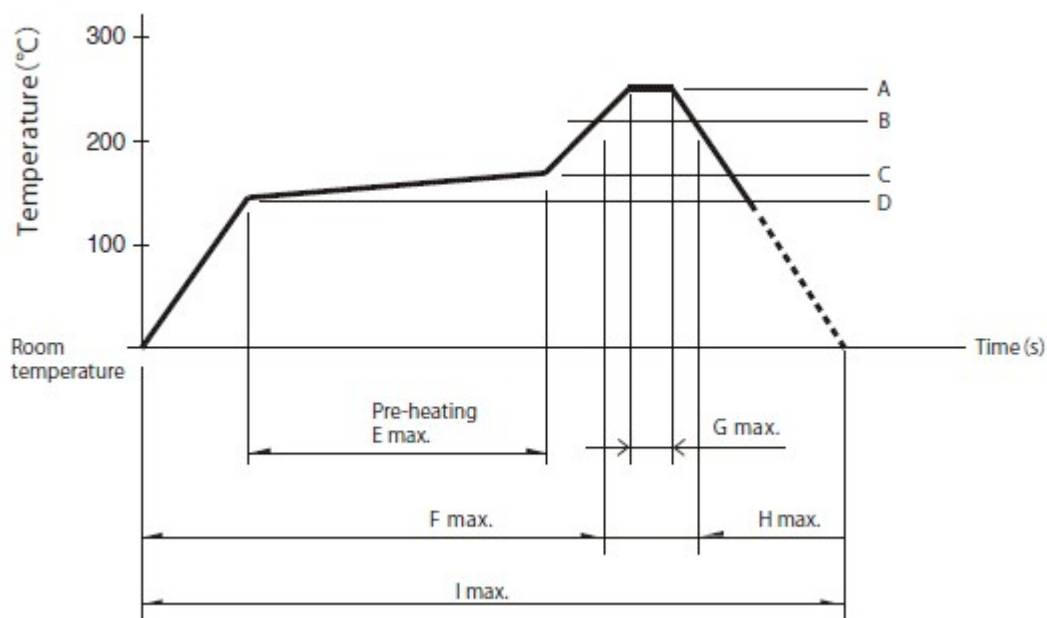

A	B	C	D	E	F	G	H	I	No. of reflows
260°C	230°C	150°C	150°C	2 min.	-	10s	40s	4 min.	1 time

(1) The condition mentioned above is the temperature on the mounting surface of a PC board. There are cases where the PC board's temperature greatly differs from that of the switch, depending on the PC board's material, size, thickness, etc. The above-stated conditions shall also apply to switch surface temperatures.

(2) Soldering conditions differ depending on reflow soldering machines. Prior verification of soldering condition is highly recommended.

Reference for Hand Soldering

Tip temperature	350±10℃
Soldering time	3(+1, -0)s max.
No. of solders	2 time max.

Notes are common to this series/models.

1. This site catalog shows only outline specifications. When using the products, please obtain formal specifications for supply.
2. Please place purchase orders for taping products per minimum order unit (1 reel or a case).

Inquiries about Products

 **Inquiry**