

ITEM:

① INSULATOR  
POLYTETRAFLUOROETHYLENE  
( TFE TEFLON )

② CONTACT  
50 MICROINCHES MIN,  
GOLD OVER 150 MICROINCHES  
MIN, NICKEL ON BERYLLIUM  
COPPER

③ BODY  
50 MICROINCHES MIN,  
GOLD OVER COPPER  
ON BRASS

1. ORDER UNDER CATALOG NO 121-24662.  
MATES WITH CATALOG NO 121-24672.

2. FOR DIMS. NOT SHOWN SEE MIL-C-39012  
SERIES SMC.

③ IDENTIFICATION MARKING:  
WINCHESTER ELECTRONICS LOGO,  
AND DATE CODE TO BE MARKED  
IN APPROXIMATE LOCATION SHOWN.

4. CONNECTOR TEMPERATURE RANGE:  
- OPERATING: -40°C to 85°C  
- STORING: -55°C to 100°C

5. CONNECTOR ELECTRICAL RATINGS:  
- IMPEDANCE: 50Ω, NOM.  
- FREQUENCY: 0 to 10 GHz  
- VSWR: 1.3 MAX (0 to 4 GHz)  
- VOLTAGE: 500 VOLTS, PEAK  
- DIELECTRIC: 1.5 kV, RMS

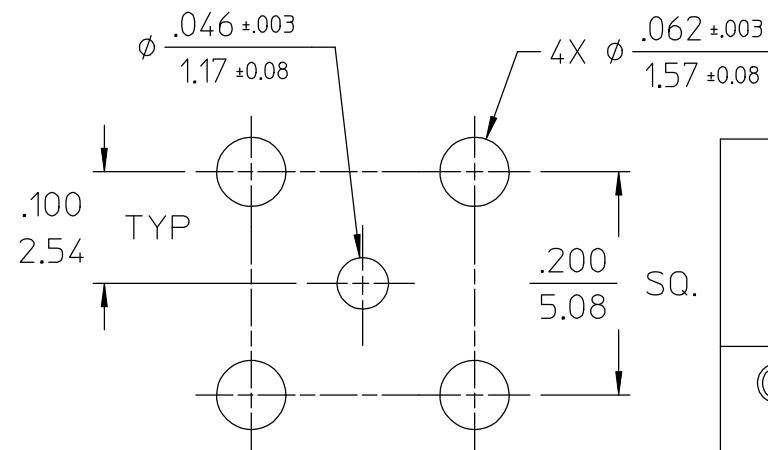
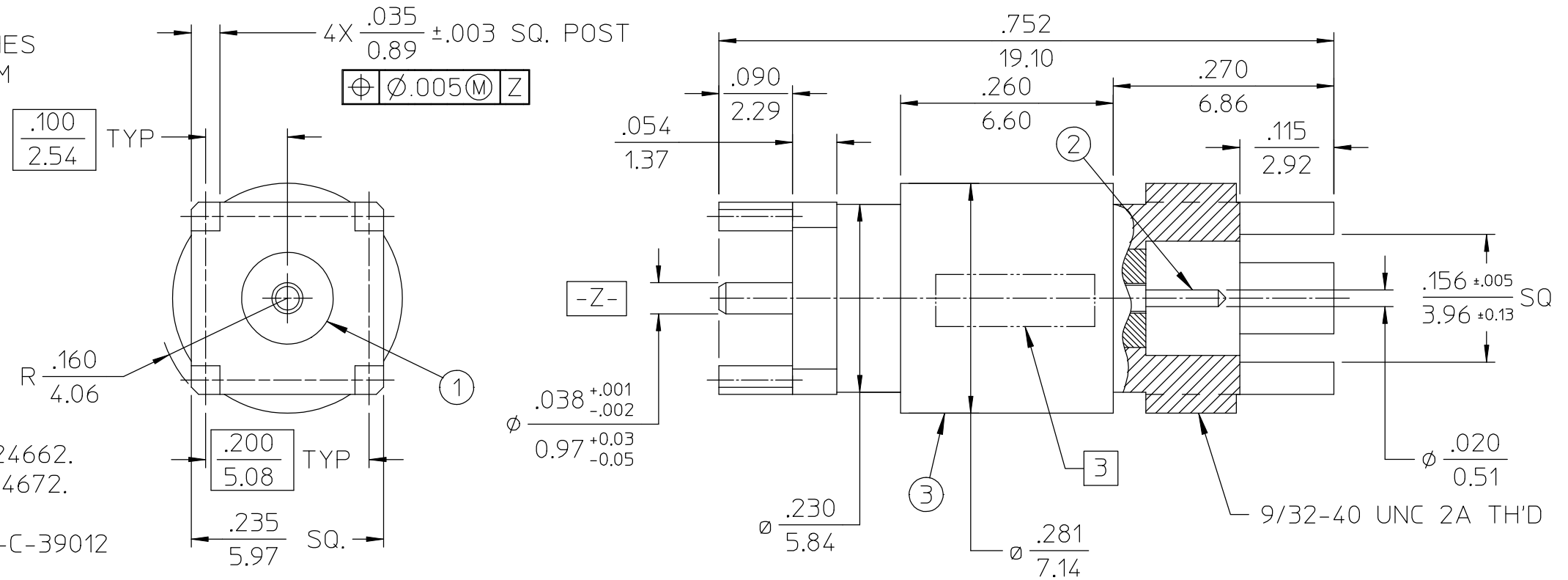

RECOMMENDED P.C.  
BOARD HOLE PATTERN

REV	DESCRIPTION	BY DATE	APPD
H	ADDED ±.005 TO .156 SQ. DIM. PER ECR NO 3634	BONESSI 05/09/95	LAW

UNLESS OTHERWISE SPECIFIED: DIMENSIONS ARE IN INCHES, OR INCHES / MM		<b>Litton</b>	
TOLERANCES		Winchester Electronics 400 PARK ROAD WATERTOWN, CONNECTICUT 06795	
DECIMALS .xx ± .02/0.5 .xxx ± .007/0.18		TITLE	
ANGLES ± 1° SCALE: 6:1		SMC - STRAIGHT JACK P.C. MOUNT ( □ KEY )	
DRAWN	DATE	CHECKED	DATE
J.M.G.	11/04/92		
APPROVED	DATE	APPROVED	DATE
LAW	12/14/92		
B	24662	SHT. 1 OF 1	REV. H