

DATE	SYM	REVISION	RECORD	AUTH.	DR.	CK.
7/29/99	-	ISSUED			NT	GH

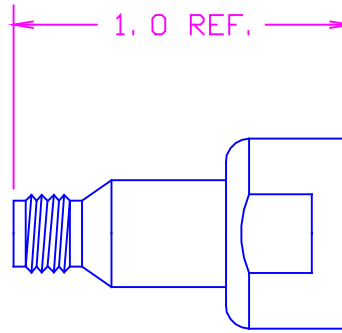

MATERIAL: BODY- BRASS PER ASTM B16
CONTACT- PHOSPHOR BRONZE
INSULATION- PTFE PER ASTM D1710
FINISH: BODY- SILVER
CONTACT- GOLD

ACTUAL SIZE

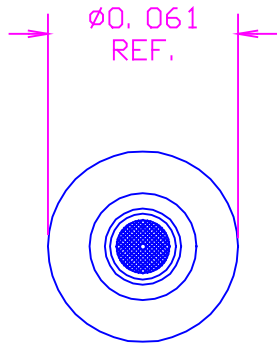
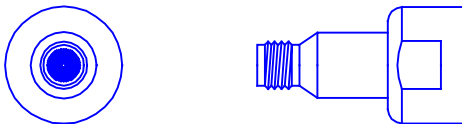

TOLERANCES (EXCEPT AS NOTED)	CONCORD		ELECTRONICS CORPORATION
DECIMAL + -	P/N	SCALE	30 GREAT JONES ST. NEW YORK N. Y. 10012
FRACTIONAL + -	TITLE SMA FEMALE TO UNIDAPT MALE		
ANGULAR + -	DATE 7/29/99	DRAWING NUMBER 800-2327-5C	