

STARCAP®

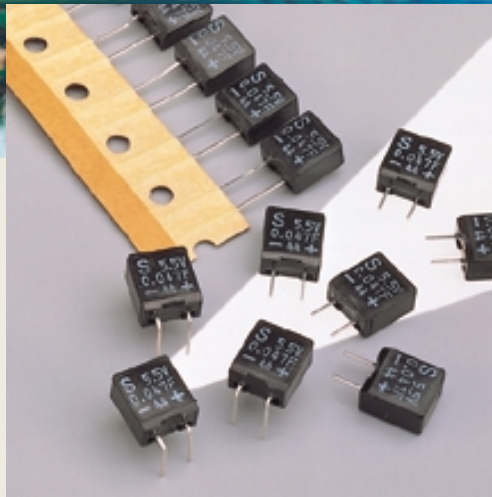

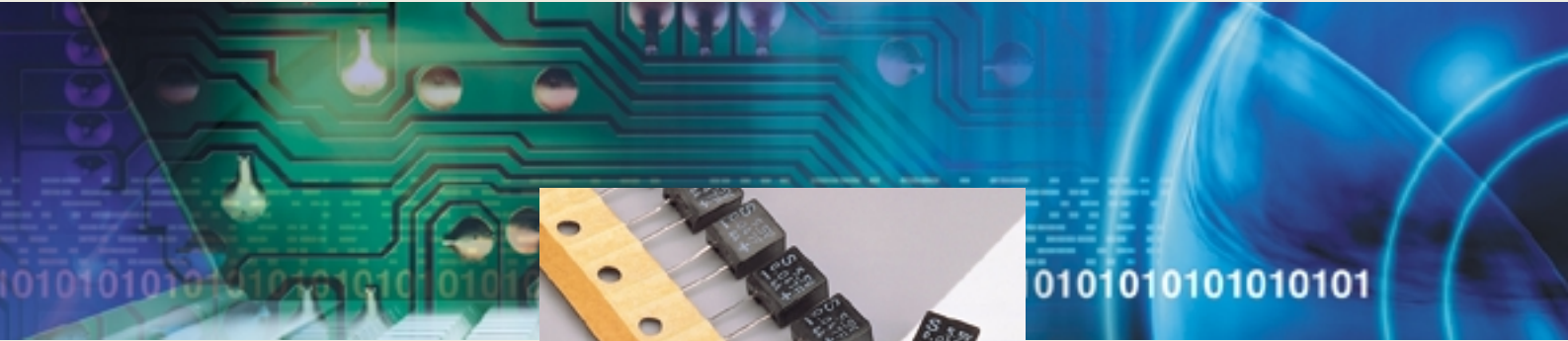
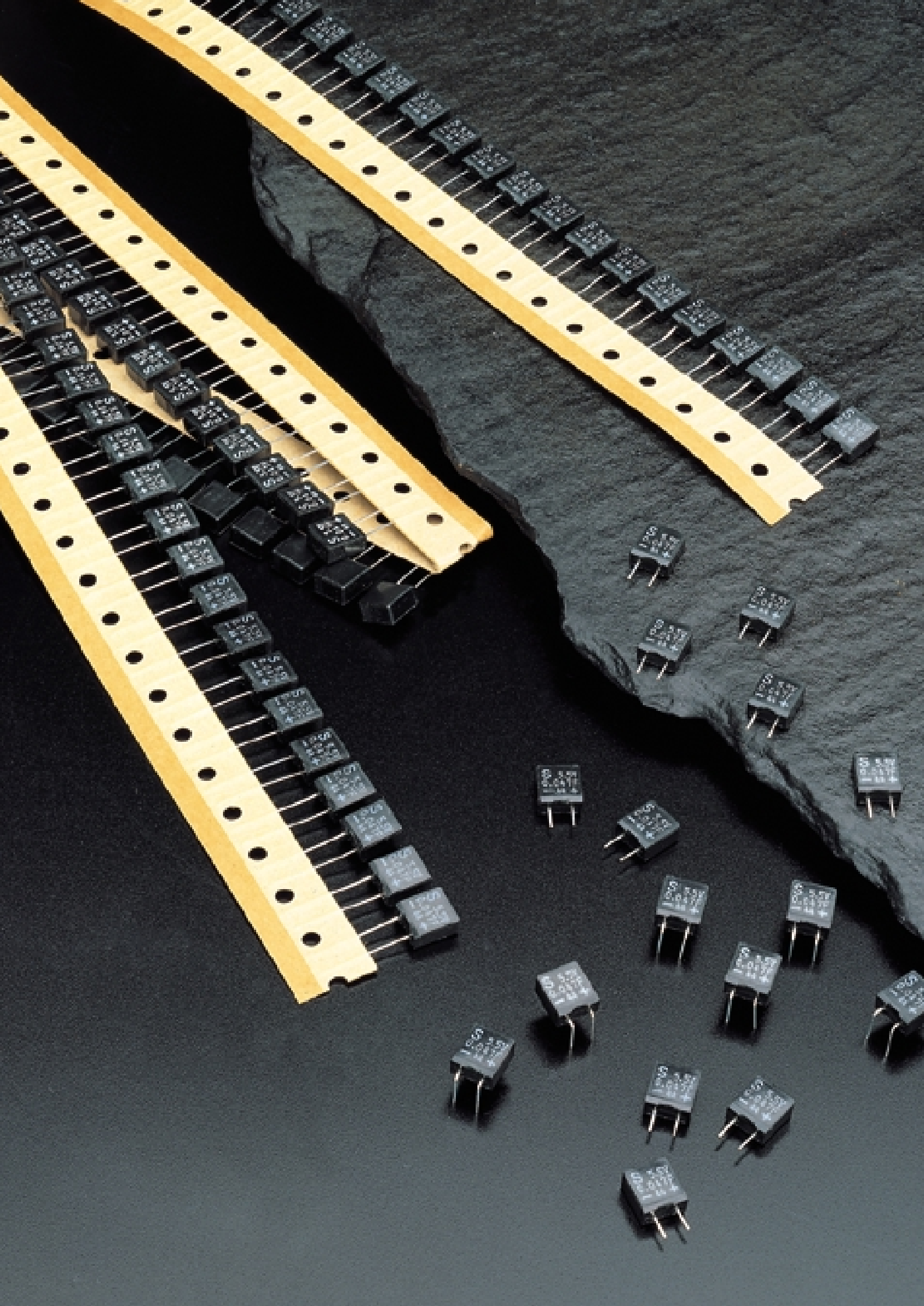

PERFORMANCE CHARACTERISTICS

The STARCAP® is an electric double layer capacitor consisting of activated charcoal electrodes and organic electrolyte.

Because of extremely larger effective surface area of the activated charcoal electrodes.

The STARCAP® can hold for much greater charge than aluminium electrolytic capacitor.

STARCAP® is designed with ultra large capacitance characteristics for memory back-up circuit.

The STARCAP® has many applications over various gadgets most of which use it for the purpose of memory back-up.

FEATURES

- Tape packaging available
- Longer life than secondary battery
- Unrestricted lengthwise and crosswise mounting
- Compact resin case further helps miniaturize and conserve space
- Waterproof structure facilitates washing

TABLE OF CONTENTS

- 3 INTRODUCTION
- 3 FEATURES
- 4 PART NUMBER SYSTEM
- 4 MARKING
- 5 DIMENSION
- 6 TAPING
- 7 PERFORMANCE CHARACTERISTIC
- 10 CAUTION FOR USE

PART NUMBER SYSTEM

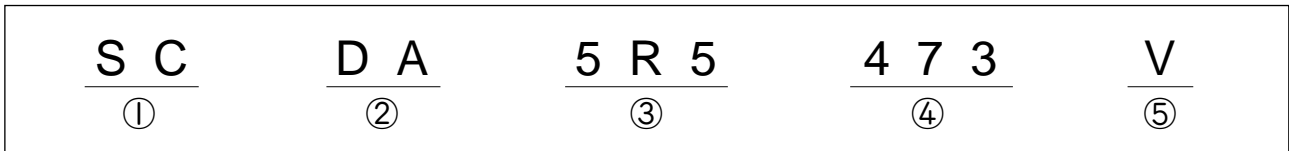

1. STARCAP[®]
2. SERIES NAME
3. RATED VOLTAGE
4. CAPACITANCE CODE

CAP.(F)	CODE
0.022	223
0.047	473
0.1	104
*0.22	224
*0.47	474
*1.0	105

*IN PROCESSING

5. LEAD & TAPING TYPE

TYPE	CODE
VERTICAL BULK	V
HORIZONTAL BULK	H
AMMO TAING	A

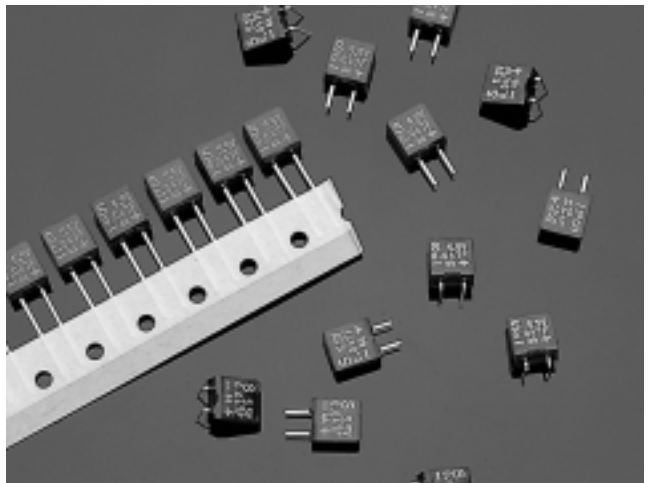

MARKING

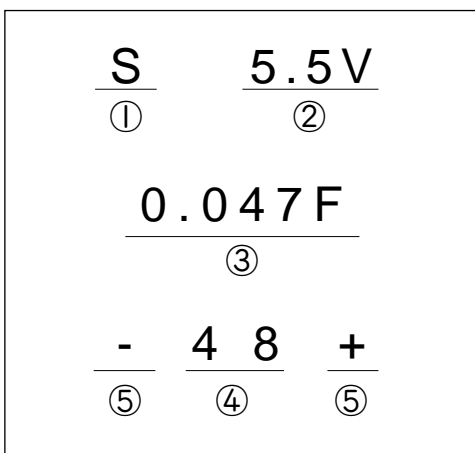

1. MANUFACTURER MARK
2. RATED VOLTAGE
3. CAPACITANCE
4. LOT NO
5. POLARITY

DIMENSION

VERTICAL TYPE

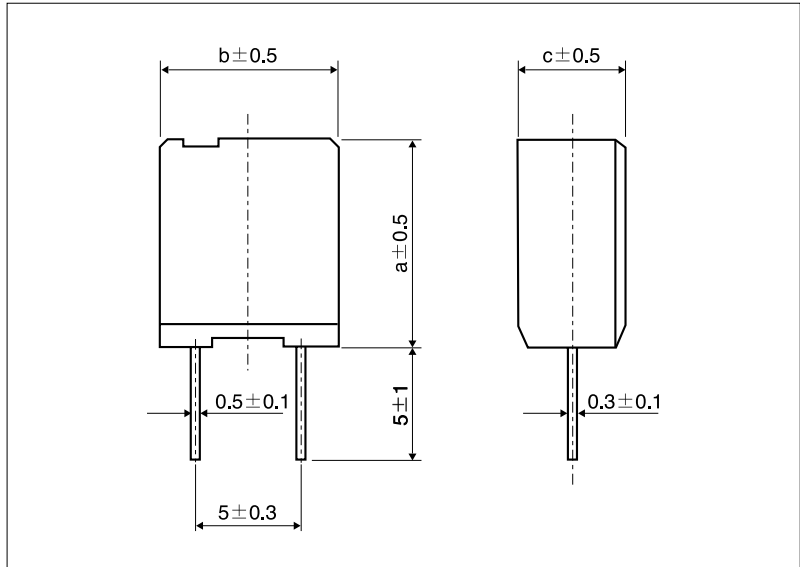

HORIZONTAL TYPE

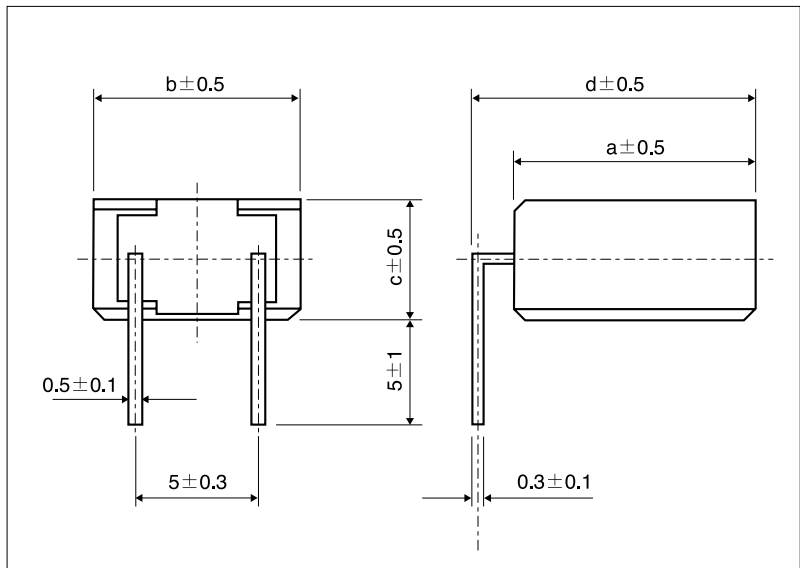

(Unit : mm)

NO.	CODE	RATED VOLTAGE (VDC)	CAPACITANCE (F)	SIZE			
				a	b	c	d
1	SCDA5R5223V(H)	5.5	0.022	10.5	9.5	5.0	12.0
2	SCDA5R5473V(H)	5.5	0.047	10.5	9.5	5.0	12.0
3	SCDA5R5104V(H)	5.5	0.1	12.5	11.5	5.0	14.0

TAPING

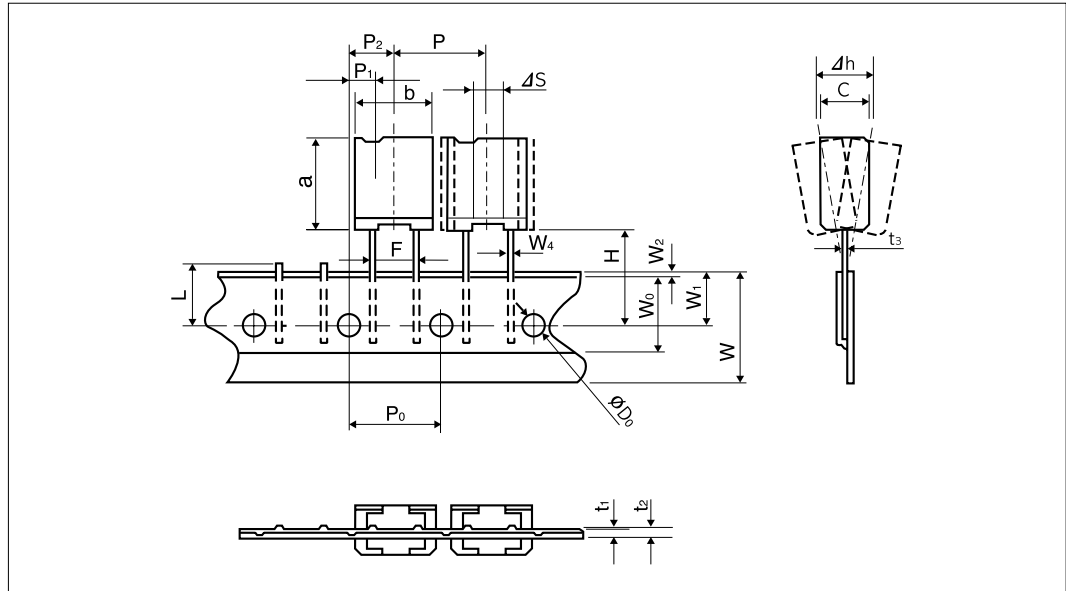

ITEM	CODE	DIMENSIONS(mm)	
Pitch of component	P	12.7	
Pitch of sprocket hole	P ₀	12.7±0.2	
Length from hole center to lead	P ₁	3.85±0.7	
Length from hole center to component center	P ₂	6.35±1.3	
Lead spacing	F	5.0± ^{0.8} _{0.2}	
Carrier tape width	W	18.0±0.5	
Hole down tape width	W ₀	12.5 max.	
Position of sprocket hole	W ₁	9.0± ⁰ _{0.5}	
Hole down tape position	W ₂	0.5±0.5	
Components bottom plane	H	18.5±0.5	
Diameter of sprocket hole	∅ D ₀	∅ 4.0±0.1	
Portion to cut in case of defect	L	11.0± ⁰ _{1.0}	
Total tape thickness	t ₁	0.6±0.3	
Total thickness, tape and lead wire	t ₂	1.5 max.	
Deviation across tape	△h	0±1.0	
Deviation along tape, left or right	△s	0±2.0	
Lead cross section	Width	W ₄	0.5±0.1
	Thickness	t ₃	0.3±0.1
Body dimension	a	10.5±0.5	*12.5±0.5
	b	9.5±0.5	*11.5±0.5
	c	5.0±0.5	*5.0±0.5

*104

PERFORMANCE CHARACTERISTICS

CAPACITANCE RANGE : 0.022~0.1F
 RATED VOLTAGE : 5.5VDC
 CAPACITANCE TOLERANCE : -20~80%
 OPERATING TEMPERATURE RANGE : -25~70°C
 EQUIPVALANT SERIAL RESISTOR(ESR)
 0.022F : LESS THAN 150Ω
 0.047, 0.1F : LESS THAN 60Ω
 LEAKAGE CURRENT 0.022F : LESS THAN 50 μA
 0.047F : LESS THAN 70 μA
 0.1F : LESS THAN 150 μA

SELF-DISCHARGING CHARATERISTICS

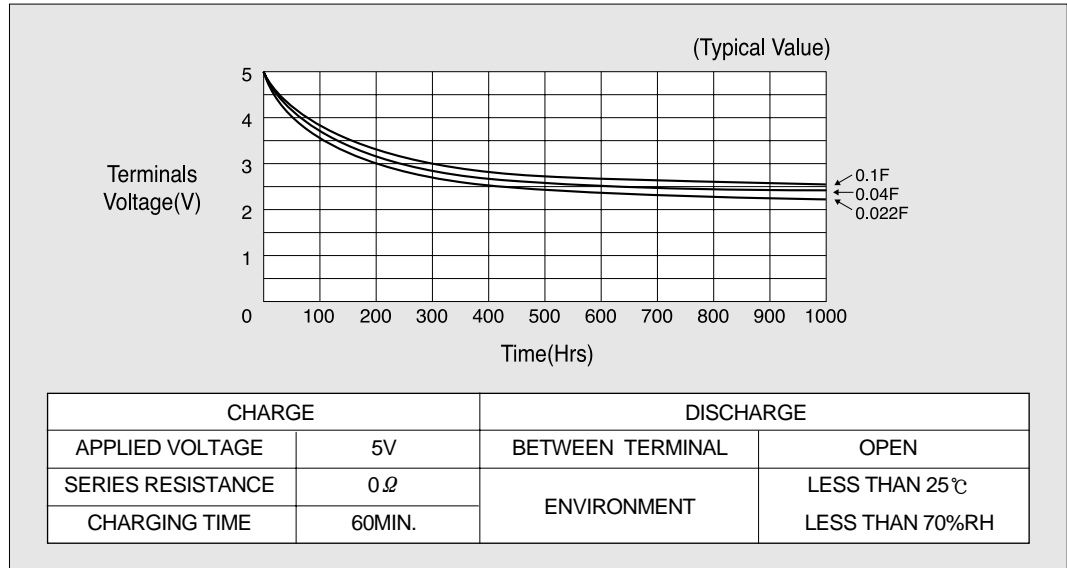

BACK-UP TIME

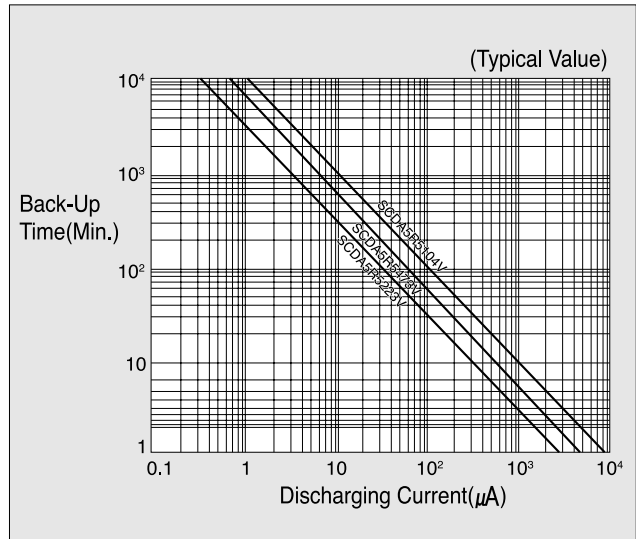

(NOTE)
 Back-up time :
 First, a voltage of 5.5V is applied to a sample capacitor for 60 minutes. Next, the power source is removed, and then a constant resistor is connected to each other discharging current. Finally, the time when the capacitor terminal voltage drops 5V to 2V is measured. The time when the capacitor backs up this processing is called the "back-up time".

CHARGE CHARACTERISTIC

SCDA5R5223V(H)

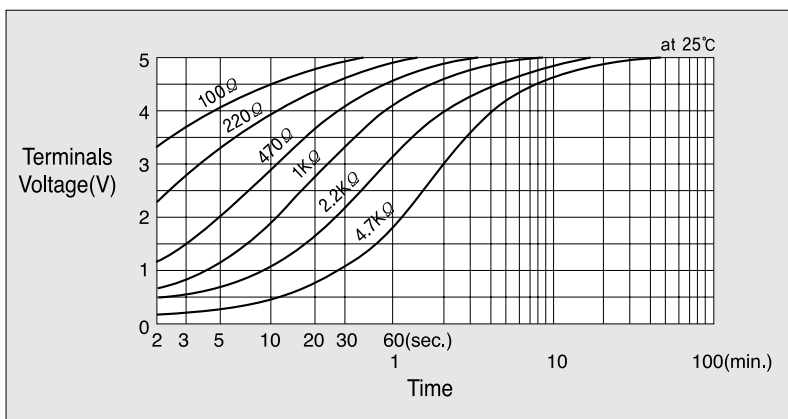

SCDA5R5473V(H)

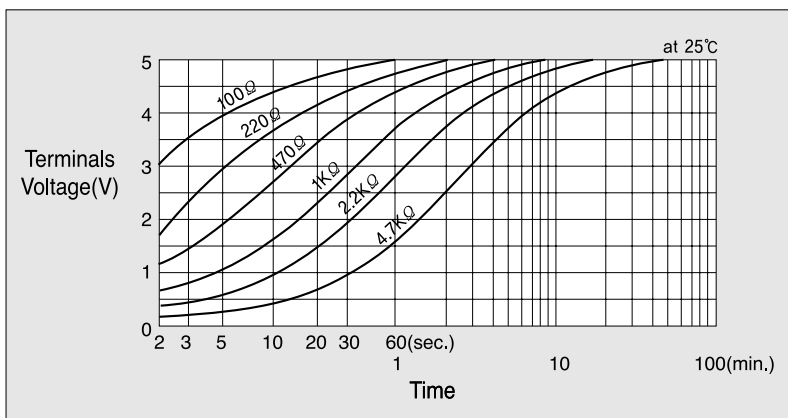

SCDA5R5104V(H)

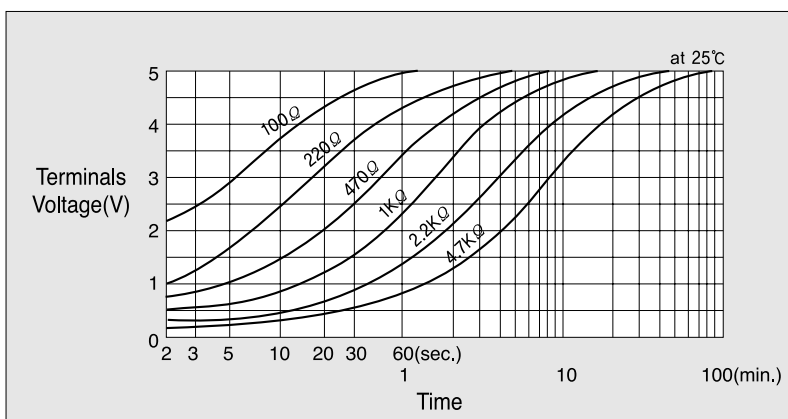

(NOTE)

Measuring conditions:

First, the sample is kept short-circuited for 60 minutes at 25°C before measurement. Next the rated resistance is connected in series to the sample. And then, using a 5V power supply, the time it takes the voltage applied to both ends of the capacitor to come to 5V is measure this time represents the charging characteristics.

RESISTOR DISCHARGING CHARACTERISTIC

SCDA5R5223V(H)

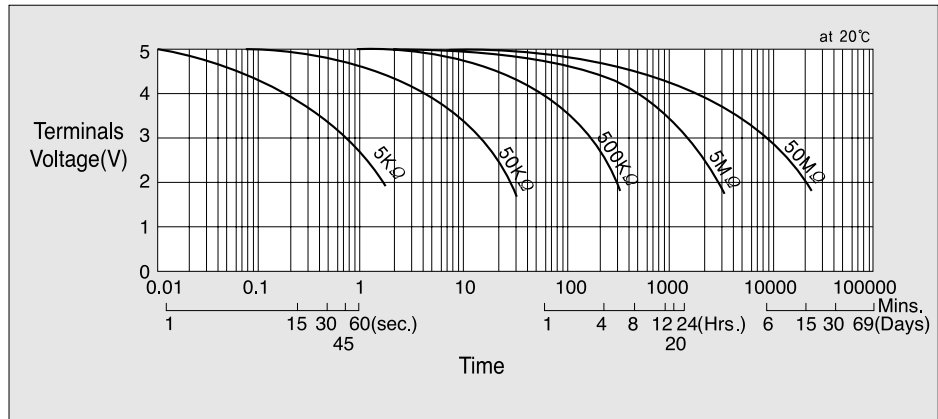

SCDA5R5473V(H)

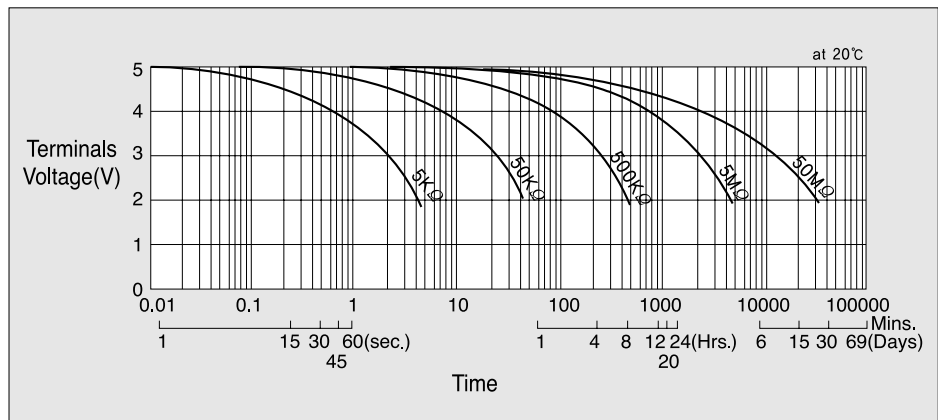

SCDA5R5104V(H)

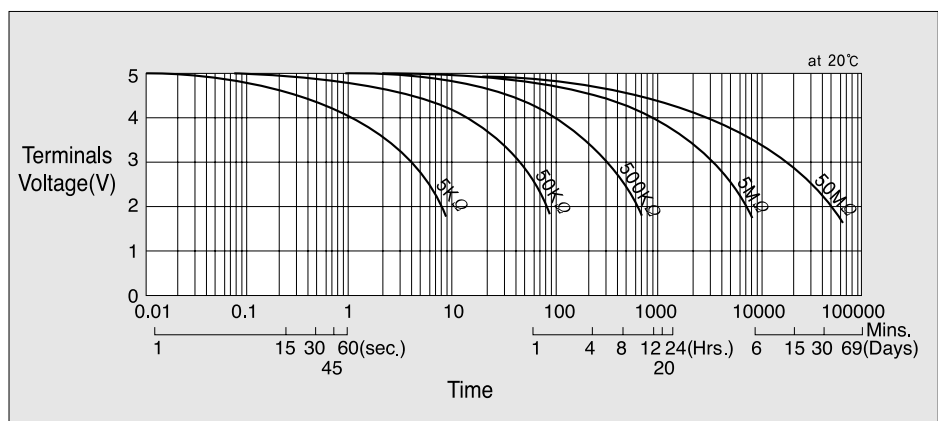

(NOTE)

Measuring conditions:

First, a voltage of 5.5V is applied to a sample capacitor for 60 minutes.

Next, discharge to the rated resistance is called the “resistor discharge characteristics”

CAUTION FOR USE

Please be careful following points when you use STARCAP®

1. Don't apply more than rated voltage

If you apply more than rated voltage, STARCAP®'s electrolyte is electrolyzed.
And its ESR gets higher, at the worst, it is broken.

2. Don't use ripple absorption

3. Polarity

Fundamentally STARCAP® is non-polar.
However STARCAP® is made polarity, when it is shipped.
Please mount it in accordance with its polarity.

4. Operating temperature and life

Generally speaking, STARCAP® has a lower leakage current.
In the low temperature, the STARCAP® has longer back up time and longer life.
But, in the high temperature, it has a higher leakage current, shorter back up time and shorter life.
Please design to keep STARCAP® away a calorific parts.

5. Cleaning

STARCAP® is a proof against cleaning.
Cleaning guarantee is as follows ;
Solvent : freon tes
Temperature : 45℃
Ultrasonic wave : less than 38kHz
Less than 20Watt / liter
Immersing time : less than 10 minutes
Ultrasonic wave must not be centered.

6. Soldering

When you solder by solder iron, please do quickly it within 3 seconds.
Please don't touch the resin case of STARCAP® by solder iron.
Because the resin may be melted by its heat.

7. Short circuit

You can short circuit between terminals without resistor.
However, when you short circuit frequently, please let us know.

8. Storage

Please store STARCAP® in following condition ;
Temperature : 15~35℃
Humidity : 45~75%RH
Non dust

9. No disassembling STARCAP®

Please don't disassemble STARCAP®
Because its electrolyte is sulfuric acid.

10. Series connection

Series connection of STARCAP® causes a difference of applied for each STARCAP®,
because of dispersion of capacitance and ESR.
As a result, its possible to apply over-rated voltage.
Please inform us if you are using STARCAP® in series connection.
And please design so as not to apply over-rated voltage to each STARCAP®,
and use STARCAP® in same lot.

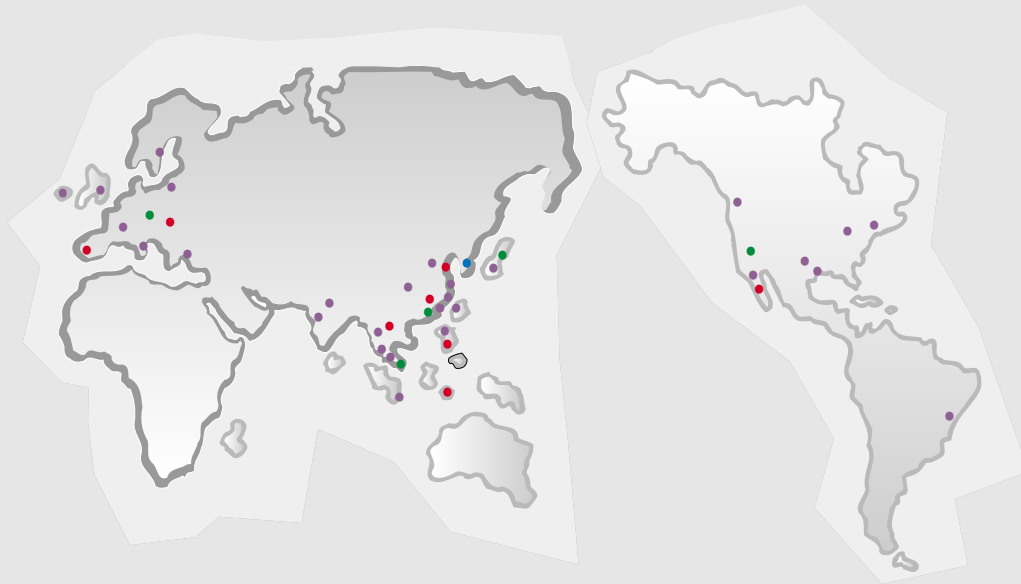

● Domestic Factories & Office ● Offshores Production Facilities ● Overseas Sales Subsidiaries ● Overseas Branches

국내영업망

구미사무소
 경북 구미시 송정동 274-9 새한빌딩 3층
 TEL : (054)456-5156 FAX : (054)456-5158

광주사무소
 광주광역시 광진구 우산동 1589-1 한국무역협회5층
 TEL : (062)942-1690~1 FAX : (062)942-1692

국내대리점

덕산전자
 서울 용산구 한강로 3가 16-48 의림빌딩 705호
 TEL : (02)716-6428~9 FAX : (02)719-8325

태원전자
 경남 창원시 중앙동 켄버리타운 14층 14호
 TEL : (055)268-5350~1 FAX : (055)268-5352

한국칩전자(주)
 서울 용산구 한강로 3가 16-60 한통엔지니어링 6층
 TEL : (02)705-1431 FAX : (02)705-1469

영덕전자(주)
 서울 구로구 구로본동 1258번지 중앙유통단지 라동 3426호
 TEL : (02)689-4693~5 FAX : (02)689-4692

청한전자(주)
 서울 용산구 한강로3가 16-9 전자랜드 광장층 A35호
 TEL : (02)718-3322 FAX : (02)703-8958

(주)동영통상
 서울 구로구 구로본동 1258번지 중앙유통단지 다동 4203호
 TEL : (02)2616-9898 FAX : (02)2618-7757

(주)삼성파츠
 서울 금천구 가산동 459번지
 TEL : (02)853-8866 FAX : (02)864-6869

(주)삼테크
 서울 강남구 삼성동 154-16 청림빌딩 4층
 TEL : (02)3458-9289 FAX : (02)3458-9300

Overseas Network

STERLING COMPONENTS LTD.
 649 Ajax Avinue, Slough Berkshire
 SL 1 4BG, England, U.K.
 TEL : 0753-820753
 FAX : 0753-692291

CIDEV
 P.O. Box 13330 Tel Aviv 31 Habarzel Street
 TEL : 36-483266
 FAX : 36-483311

MIKO COMPONENT AB
 Box 2001 145-02 Norsborg Sweden
 TEL : 0753-890-80
 FAX : 0753-753-40

FUTURE ELECTRONICS LTD.
 Future House, Poyle Road, Colnbrook,
 Berkshire, SL3 0AA, England, U.K.
 TEL : 1753-763000
 FAX : 1753-689100

RUTRONIK
 Elektronische Bauelemente GmbH.,
 Industriestrasse 2,
 D-75228 Ispringen, Pforzheim,
 Germany
 TEL : 49-7231-801-0
 FAX : 49-7231-822-82

TTI Inc.
 Goethe Str. 15, D-75173 Pforzheim,
 Germany
 TEL : 49-7231-147-8833
 FAX : 49-7231-147-8899



ELECTRO-MECHANICS

● **Head Office & Sale Dept.**

314, Maetan 3-Dong, Paldal-Gu,
Suwon, Gyeonggi-Do, Korea 442-743
TEL : (82-31)210-6120, 6791
FAX : (82-31)210-5999, 6109

Daejeon Plant

581, Myeonghak-Ri, Dong-Myeon,
Yeong-Gun, Chungcheongnam-Do,
Korea 339-860
TEL : (82-41)861-1214
FAX : (82-41)861-1333

Busan Plant

Noksan Industrial Complex, 1623-2,
Songjeong-Dong, Gangseo-Gu,
Busan, Korea 618-270
TEL : (82-51)970-7114, 8114
FAX : (82-51)970-8702

Seoul Office

15F, Daegyong Bldg., 120,
Taepyeongno 2-Ga, Jung-Gu,
Seoul, Korea 100-102
TEL : (82-2)779-8325
FAX : (82-2)752-8125

▶ **Samsung Portugal Produtos
Electro-Mecanicos S. A.(SPEM)**

Rua Da Republica Da Coreia,
Ranholas Sao Pedro Penaferrim,
2710, Sintra, Portugal
TEL : (351-21)924-8300
FAX : (351-21)824-8490

**Samsung Hungary
Electro-Mechanics Co., Ltd.(SHEM)**

H-2310 Szigetszentmiklos Ilyusag
U. 16 Hungary
TEL : (36-24)443-394-5
FAX : (36-24)443-397

**Samsung Electro-Mechanics
Thailand Co., Ltd.(SEMT)**

Wellgrow Industrial Estate 93 Moo 5T.
Bangsamak, A. Bangpakong,
Chacheungsao 24180, Thailand
TEL : (66-38)570-191-6
FAX : (66-38)570-258

**Samsung Electro-Mechanics
Philippines Inc.(SEMPhil)**

CPIP, Batino, Calamba, Laguna, Philippines
TEL : (63-49)545-6001
FAX : (63-49)545-2348

**Samsung Electro-Mechanics
Indonesia PT(SEMIN)**

JL. Inti Raya 1 Blok C-1 No. 9 Bekasi
International Industrial Estate
Lippo-Cikarang Bekasi 17550 Indonesia
TEL : (62-21)897-2762
FAX : (62-21)897-2763

**Dongguan Samsung
Electro-Mechanics Co., Ltd.(DSEM)**

Hengkeng Management Area
Liaobu-Town, Dongguan-City,
Guangdong-Province, China
TEL : (86-769)330-5000, 1240, 2580, 1111
FAX : (86-769)330-5001

**Tianjin Samsung
Electro-Mechanics Co., Ltd.(TSEM)**

27, Heiniu, Cheng-Road,
Tianjin, China 300210
TEL : (86-22)2830-1307-9, 2823-5241-2
FAX : (86-22)2830-7436, 2823-5243

**Samsung Electro-Mecanico
Mexicana S. A. DE C. V.(SEMSA)**

Bldv. Morelos Este Manzana No.3
Parque Industrial El Florido IL., SECC.
Delegacion La Presa,
Tijuana, B.C., Mexico
TEL : (1-619)671-6400, 6420, 6425,
(52-66)27-6400
FAX : (1-619)671-6408-9, 6461,
(52-66)45-0036

■ **Samsung Electro-Mechanics
America, Inc.**

3655 North First Street, San Jose,
CA. 95134 U.S.A.
TEL : (1-408)544-5200-9
5211-5, 5217-8
FAX : (1-408)544-4967-8

○ **Chicago Office**

1111 Plaza Dr. Suite 100
Schaumburg, IL. 60173 U.S.A.
TEL : (1-847)969-1690, 9606
FAX : (1-847)969-1856, 9605

New Jersey Office

105 Challenger Rd.,
5th Floor Ridgeway Park,
NJ. 07660 U.S.A.
TEL : (1-201)229-6092-4
FAX : (1-201)229-6096

Dallas Office

1130 E. Arapaho Rd., Richardson,
TX. 75081, U.S.A.
TEL : (1-972)761-7388
FAX : (1-972)761-7389

San Diego Office

7841 Balboa Ave., Suite 210 San Diego,
CA 92111, U.S.A.
TEL : (1-858)277-4559
FAX : (1-619)277-4399

Portland Office

3000 New Stucki Place, Suite 230
Hillsboro, Or 97124, U.S.A.
TEL : (1-503)690-9303
FAX : (1-503)690-6022

Houston Office

8203 Willow Place South, Suite 285
Houston, TX 77070, U.S.A.
TEL : (1-281)477-9011, 9022
FAX : (1-281)477-9033

Sao Paulo Office

Rua Prof. Manuelito De Omellas,
303 To Andar-E Chacara Sto Antonio
CEP: 04719-040 Sao Paulo-SP, Brasil
TEL : (55-11)5641-0165, 0171, 0189
FAX : (55-11)5641-0017

■ **Samsung Electro-Mechanics
GmbH.**

Samsung-Haus, Am Kronberger Hang 6,
65824 Schwalbach/Ts, Germany
TEL : (49-6196)66-7230, 7233, 7250
FAX : (49-6196)66-7744, 7755

○ **London Office**

Great West House,
Great West Road, Brentford,
Middlesex TW8 9DQ, U.K.
TEL : (44-20)8380-7206-8
FAX : (44-20)8380-7209

Dublin Office

Unit 8B, St. John's Court
Santry Dublin 9, Ireland
TEL : (353-1)862-1120
FAX : (353-1)862-1190

Istanbul Office

Harman Caddesi, Polat Plaza B-Block
No.4, KAT4. Ievent-80640 Istanbul,
Turkey
TEL : (90-212)324-0856-8
FAX : (90-212)270-0077

Warsaw Office

AL. Jana Pawla II 15, 00-828
Warsaw, Poland
TEL : (48-22)697-7971-2
FAX : (48-22)697-7973

Paris Office

C.A. La. Boursiere, RN 186, BAT.
Champagne, BP202 92357
Le Plessis Robinson, France
TEL : (33-1)46-318930
FAX : (33-1)46-318934

Stockholm Office

Box 713, 19427 Upplands Vasby, Sweden
TEL : (46-8)590-714-70
FAX : (46-8)590-966-50

Milano Office

Via C. Donat Cattin 5, 20063 Cernusco,
S.N(MI) Milano, Italy
TEL : (39-02)9214-1822
FAX : (39-02)9214-1840

■ **Samsung Japan Co., Ltd.**

16-18F, Hamacho Center Bldg.,
Chuo-Ku, 2-31-1, Nihonbashi-Hamacho,
Tokyo 103, Japan
TEL : (81-3)5641-9674, 9690
FAX : (81-3)5641-9881

○ **Osaka Office**

6Fl. Crystal Tower 2/27, 1-Chome Shiromi
Chuo-Ku, Osaka 540, Japan
TEL : (81-6)6949-5132
FAX : (81-6)6949-3047

■ **Samsung Electro-Mechanics
(H.K.) Ltd.**

5/F, Fortune Ind. Bldg., Tai Yip Street,
Kwun Tong, HongKong, China
TEL : (852)2751-5555, 5520-7
FAX : (852)2751-5566

○ **Beijing Office**

Onward Science & Trade Center, 23F China
Merchants Tower No. 2, Dong Huan Lu,
Chaoyang District, Beijing 100022, China
TEL : (86-10)6566-8150
FAX : (86-10)6566-8146

Shanghai Office

9F, Shanghai International Trade Center
No.2200 Yan An(W) Road, Shanghai,
China 200335
TEL : (86-21)6270-4168(Ext.270)
FAX : (86-21)6275-2975

Shenzhen Office

Rm 4312-4313, 43/F, Office Tower,
Shun Hing Square Di Wang Commercial
Centre, 33 Shum Nam Dong Road,
Shenzhen, China
TEL : (86-755)246-2080, 2086
FAX : (86-755)246-2089

Xiamen Office

Unit A, 36/F, International Trade Building,
No. 388, Hubin South Road, Xiamen, China
TEL : (86-592)516-2078
FAX : (86-592)516-4551

Taipei Office

Int'l Trade Bldg., Suite 2508 30F No.333,
Sec. 1, Keelung Rd., Taipei, Taiwan R.O.C
TEL : (886-2)2728-8450-6, 8453
FAX : (886-2)2757-7278

■ **Samsung Asia Pte., Ltd.
(Electro-Mechanics Division)**

83 Clemenceau Avenue, #08-05 UE Square,
Singapore 239920
TEL : (65)8333-215-233
FAX : (65)8333-243, 244

○ **Bangkok Office**

21st Floor, Lake Rajada Office Complex
193/90-91 Rachadapisek Road,
Khet Klongtoey, Bangkok 10110, Thailand
TEL : (662)661-8004-5
FAX : (662)661-8006

Jakarta Office

Plaza Mashill 23rd Floor,
JL. Jend. Sudirman KAV. 25
Jakarta 12920, Indonesia
TEL : (62-21)522-5537
FAX : (62-21)522-5538

Kuala Lumpur Office

Lot 702, 7th Floor, Pernas
International Jalan Sultan Ismail,
50250 Kuala Lumpur, Malaysia
TEL : (60-3)264-9129
FAX : (60-3)262-6518

Penang Office

9-2, Menara Penang Garden,
42-A Jalan Sultan Ahmad Shah,
10050 Penang, Malaysia
TEL : (60-4)229-1671
FAX : (60-4)229-1678

Manila Office

1st Flr. 1535M. Adriatico Street, Malate,
Metro Manila, Philippines
TEL : (63-2)338-0380, 526-2412-9(Ext.250)
FAX : (63-2)528-4830

New Delhi Office

Samsung Electronics Co., Ltd.
2nd Floor, 47, Ring Road, Lajpat Nagar - III,
New Delhi, India-110024
TEL : (91-11)631-3051
FAX : (91-11)684-6846

Mumbai Office

420, Maker Chamber V, Nariman Point,
Mumbai-21, India
TEL : (91-22)281-3246, 3289, 4886
FAX : (91-22)288-5885

- Domestic Factories & Offices
- ▶ Offshores Production Facilities
- Overseas Sales Subsidiaries
- Overseas Branches