

24

2410 03

USB and IEEE 1394 connectors



Double USB 2.0 chassis socket type A, angular version, for printed circuit boards, with ground contacts at the front

State: Obsolete

24 2410 03

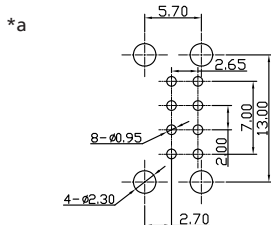
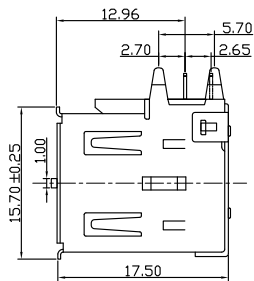
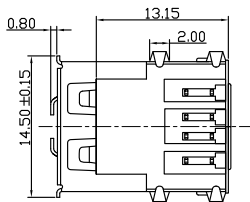
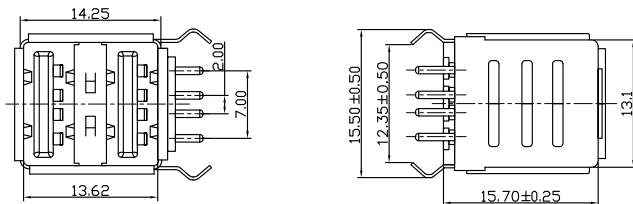

*a printed circuit board layout

Environmental conditions

Temperature range x

Materials

| | |
|-----------------------|--|
| Insulating body | PBT GF, V-0 according to UL94 |
| Contact spring | CuSn, gold-plated, tin-plated in solder area |
| Ground contact spring | CuZn, tin-plated |
| Housing | CuZn, tin-plated |

Mechanical data

| | |
|------------------|--------|
| Mating cycles | 1500 |
| Insertion force | ≤ 30 N |
| Withdrawal force | ≥ 10 N |

Electrical data (at T_{amb} 20 °C)

| | |
|-----------------------|------------|
| Contact resistance | ≤ 30 mΩ |
| Rated current | ≤ 1 A |
| Rated voltage | 30 V AC |
| Rated impulse voltage | 500 V/60 s |
| Insulation resistance | ≥ 100 MΩ |

Associated products

Counterparts
 ☞ 2410 07 ☞ 2410 08 ☞ 2431
 ☞ 2480 ☞ 2482

Accessories
 ☞ 2412 01

24

2410 03

| Designation | Pole Number | PU (Pieces) | MDQ (Pieces) |
|-------------|-------------|-------------|--------------|
| 2410 03 | 2 x 4 | 100 | 600 |

Packaging:
in a tray