

# MP SERIES

# RF CO-AXIAL CONNECTORS

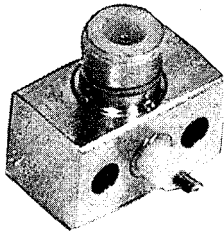

MP2.5CLR

HRS No.	Part No.	Remarks
* CL325-0004-2	MP2.5CLR	L-type receptacle

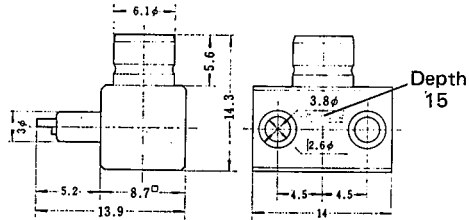

## Receptacle plug

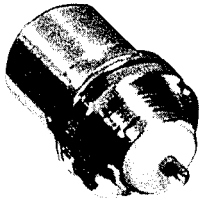

MP2.5CRP

HRS No.	Part No.	Panel thickness	Remarks
CL325-0006-8	MP2.5CRP	0.5~1.8mm	Receptacle plug

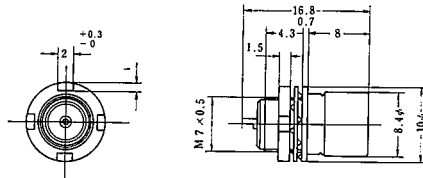

## Adapter

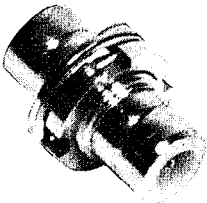

MP2.5CPA-JJ

HRS No.	Part No.	Panel thickness	Remarks
CL325-0007-0	MP2.5CPA-JJ	0.5~1mm	Panel adapter

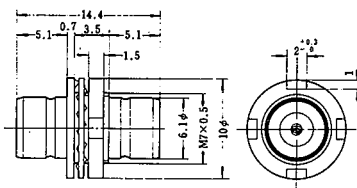

## Accessories

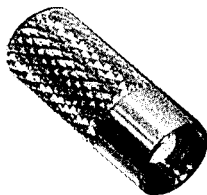

MP2.5CP75

HRS No.	Part No.	Rated power	Remarks
CL325-0008-3	MP2.5CP75	1/8W	75Ω resistive terminator (plug-type opening)

