

M Connectors

● Housing

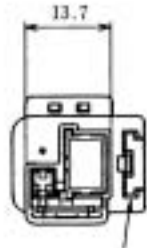

Mounting bracket attachment side

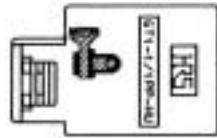
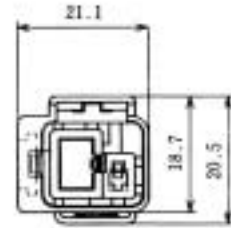
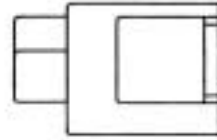

◆ Recommended Mounting Bracket Dimensions (T=1.5mm)

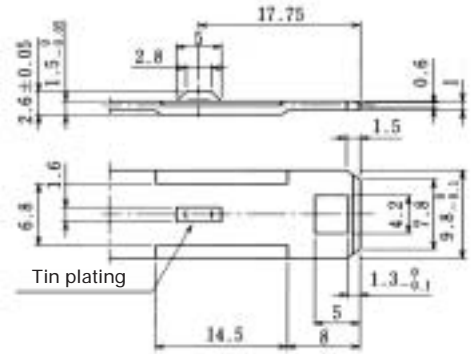

Part Number	CL No.	Mounting bracket attachment side	Remarks
GT1-1/1PP-HU	751-0025-1	1.5mm	With ground terminal
GT1-1/1PP-HU(10)	751-0025-1-10	1.5mm	Without ground terminal
GT1-1/1PP-HU(11)	751-0025-1-11	1.0mm	With ground terminal

Item	Material	Finish
Housing	PBT	Light gray
Ground terminal	Phosphor bronze	Tin plating

Note: Used with separate retainer (GT1-1/1PP-R).

● Retainer (exclusively for GT1-1/1PP-HU)

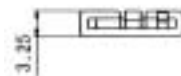
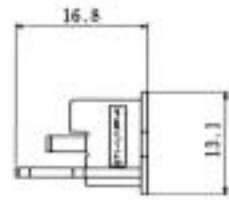

Part Number	CL Number	Material	Color
GT1-1/1PP-R	751-0027-7	PBT	Dark gray

Note: Mount this item after provisional insertion into the housing, or after terminal insertion.

